

2nd Congress of
AsCNP

Asian College of Neuropsychopharmacology

Jointly with 2011 Annual Meeting
of Korean College of Neuropsychopharmacology

*“Asian Collaboration
on Neuropsychopharmacology and Neuroscience”*

September 23_(Fri.) – 24_(Sat.), 2011
Grand Hilton Seoul Hotel, Seoul, Korea

Hosted by

Korean College of Neuropsychopharmacology

Organized by

Asian College of Neuropsychopharmacology

•• *Contents*

Welcome Message	03
Organization	04
Invited Speakers	06
Meeting Information	07
Floor Plan	08
Program at a Glance	11
Scientific Program	12
Poster Session	29
New Research (Oral Presentation) Award	50
Young Investigator Fellowship Award	51
Contribution Association	54
Exhibition & Sponsorship	55
Hotel Information	56
Tour Program	58
Registration	63
Participants List	65

Welcome Message

Dear Colleagues and Friends,

On behalf of the Organizing Committee, we would like to extend a cordial invitation to all members and colleagues of the 2nd Congress of Asian College of Neuropsychopharmacology to be convened September 23-24, 2011 in Seoul, Korea.

Asia has the largest population in the world and continues to develop academically as well as economically. Recently, there have been remarkable achievements in the fields of pharmacogenetics, personalized pharmacotherapy and new drug developments in Asia. Now Korea and other Asian countries are rapidly expanding their clinical drug trials.

On this occasion, the 2nd AsCNP Congress will contribute to the advancement of basic and clinical neuroscience through collaborations between Asian countries and will devote our energy to strive for Asia's role in the growth of International College of Neuropsychopharmacology (CINP).

Although East Asian Countries such as Japan, Korea, China and Taiwan have already established their key roles in managing this congress, we sincerely hope South and Middle Asian Countries will join in the AsCNP Congress.

Moreover, the Organizing Committee is also planning unique and colorful social programs through which all participants will enjoy the fascinating Korean culture and the warm Korean spirit of friendship. The participants will have special experiences in beautiful Korea.

I would like to close my welcome address by expressing my sincere wishes for success and for all participants to be energized and enlightened by this meeting.

I am looking forward to welcoming you to Wonderful Seoul in September.

Cordially,



Young Hoon Kim, M.D., Ph.D.

President, Asian College
of Neuropsychopharmacology

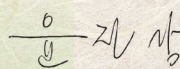

Jin-Sang Yoon, M.D., Ph.D.

President, Korean College
of Neuropsychopharmacology

Organization

AsCNP Executive Committee

- ● Shigeto Yamawaki _ Past-president (Japan)
- ● Young Hoon Kim _ President (Korea)
- ● Xin Yu _ President-elect (China)
- ● Yuan-Hwa Chou _ Vice-presidents (Taiwan)
- ● Shigenobu Kanba _ Vice-presidents (Japan)
- ● Chan-Hyung Kim _ General Secretary (Korea)
- ● Ho Suk Suh _ Treasurer (Korea)

AsCNP Council Members

- ● Chang-Yoon Kim (Korea)
- ● Young Hoon Kim (Korea)
- ● Chan-Hyung Kim (Korea)
- ● Jun Soo Kwon (Korea)
- ● Jin-Sang Yoon (Korea)
- ● Jun Ishigooka (Japan)
- ● Kiyofumi Yamada (Japan)
- ● Tetsuro Ohmori (Japan)
- ● Kazutaka Ikeda (Japan)
- ● Kazutaka Shimoda (Japan)
- ● Shigenobu Kanba (Japan)
- ● He Yanling (China)
- ● Zhao Jingping (China)
- ● Si Tianmei (China)
- ● Xin Yu (China)
- ● Hsien-Yuan Lane (Taiwan)
- ● Tung-Ping Tom Su (Taiwan)
- ● Chia-Yih Liu (Taiwan)
- ● Yuan-Hwa Chou (Taiwan)
- ● Andi J. Tanra (Indonesia)

Organizing Committee

- ● **Chair** Young Hoon Kim (Korea) Jin-Sang Yoon (Korea)
- ● **General Secretary** Chan-Hyung Kim (Korea)
- ● **Members**

- ● Won-Myong Bahk (Korea)
- ● Teruhiko Higuchi (Japan)
- ● Jun Ishigooka (Japan)
- ● Zhao Jingping (China)
- ● Sunao Kaneko (Japan)
- ● Chang-Yoon Kim (Korea)
- ● Jun Soo Kwon (Korea)
- ● Hsien-Yuan Lane (Taiwan)
- ● Chia-Yih Liu (Taiwan)
- ● Tetsuro Ohmori (Japan)
- ● Tung-Ping Tom Su (Taiwan)
- ● Andi J. Tanra (Indonesia)
- ● He Yanling (China)
- ● Yukio Yoneda (Japan)
- ● Xin Yu (China)

Scientific Committee

- ● **Chair**



Chan-Hyung Kim (Korea)

- ● **Members**

- ● Hyun-Sang Cho (Korea)
- ● Yuan-Hwa Chou (Taiwan)
- ● Young-Chul Chung (Korea)
- ● Yeon Ho Joo (Korea)
- ● Shigenobu Kanba (Japan)
- ● Seung-Hwan Lee (Korea)
- ● Jung Goo Lee (Korea)
- ● Sang-Hyuk Lee (Korea)
- ● Si Tianmei (China)
- ● Ho Suk Suh (Korea)

Award Select Committee

- ● **Chair**



Jun Soo Kwon (Korea)

- ● **Members**

- ● Ung Gu Kang (Korea)
- ● Min-Seong Koo (Korea)
- ● Changsu Han (Korea)
- ● Chi-Un Pae (Korea)
- ● Jong-Ik Park (Korea)
- ● Shigeto Yamawaki (Japan)
- ● Xin Yu (China)
- ● Yuan-Hwa Chou (Taiwan)

Local Advisory Committee

- ● Ik Seung Chee
- In Won Chung
- Moon Yong Chung
- Sang Keun Chung
- Chang Hwan Han
- Kyoo Seob Ha
- Woong Hahm
- Young Myo Jae
- Sung Hoon Jeong
- Chul Ho Jung
- Han Yong Jung
- Dae Yeob Kang
- Baik Seok Kee
- Chul Eung Kim
- Doh Kwan Kim
- Hyun Woo Kim
- Jae Jin Kim
- Jeong Gee Kim
- Jong Woo Kim
- Leen Kim
- Sang Hoon Kim
- Sung Gon Kim
- Yong Sik Kim
- Yong Ku Kim
- Young Joon Kwon
- Chang Uk Lee
- Chul Lee
- Hong Shick Lee
- Jong Bum Lee
- Kwang Heun Lee
- Maan Gee Lee
- Min Soo Lee
- Sang Yeol Lee
- Young Sik Lee
- Sung Ho Min
- Sung Kil Min
- Jai Sung Noh
- Byoung Hoon Oh
- Kang Seob Oh
- Ki Chung Paik
- Chul Soo Park
- Min Cheol Park
- Yong Chon Park
- Joo Cheol Shim
- Chul Jin Shin
- Il Seon Shin
- Jung Seo Yi
- Doh Joon Yoon
- Bum Hee Yu

KCNP

- ● **Honorary President**
- Chae Won Kim
- Chairman**
- Chang-Yoon Kim
- President**
- Jin Sang Yoon
- Vice-President**
- Won-Myong Bahk
- Chan-Hyung Kim
- Auditor**
- Dae Yeob Kang
- Ki Chung Paik
- General Secretary**
- Hyun-Sang Cho
- Scientific Secretary**
- Yeon Ho Joo (Head)
- Sung Wan Kim
- Kang Soo Lee
- Jung Goo Lee
- Jung Sun Lee
- Jong Woo Paik
- Educational Secretary**
- Kyung Joon Min
- Publishing Secretary**
- Jeong Ho Chae
- Young-Chul Chung
- Planning Secretary**
- Jung Seo Yi
- Secretary of International Affairs**
- Seung Hwan Lee
- Information Secretary**
- Min Seong Koo
- Promotion Secretary**
- Chang Su Han
- Secretary of Research and Ethics**
- Chi Un Pae
- Secretary of Insurance and Law**
- Jong Ik Park
- Financial Secretary**
- Ho Suk Suh
- Secretary of Special Affairs**
- Jun Soo Kwon
- Sung Gon Kim
- Il Seon Shin
- Sang Yeol Lee
- Bum Seok Jeong
- Sung Hoon Jeong
- Advisor**
- Byung Jo Kang
- In Ho Paik
- Sung Kil Min
- Hong Shick Lee
- Doh Joon Yoon
- Min Cheol Park
- Young Hoon Kim

Invited Speakers

● ● Plenary Lecture



Young-Hoon Kim
Department of Psychiatry,
Inje University
Haeundae Paik Hospital, Korea



Hans-Jürgen Möller
Department of Psychiatry,
Ludwig-Maximilians University,
Germany



John H. Krystal
Department of Psychiatry,
Yale University
School of Medicine, USA

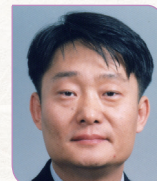

Chang-Yoon Kim
Department of Psychiatry,
Ulsan University
Asan Medical Center, Korea

● ● Special Lecture



Anthony G. Phillips
Department of Psychiatry,
UBC Institute of Mental
Health, Canada



Shigeto Yamawaki
Department of Psychiatry
and Neurosciences,
Hiroshima University, Japan



Brian Dean
The Rebecca L. Cooper Research
Laboratories, The Mental Health
Research Institute, Australia



Joseph Zohar
Department of Psychiatry,
Chaim Sheba Medical Center,
Israel

● ● Meet the Expert

● ● Thematic Lectures



Xin Yu
Department of Clinical Psychiatry,
Peking University,
China



Shigenobu Kanba
Department of Psychiatry,
Kyushu University, Japan



Yuan-Hwa Chou
Department of Psychiatry,
Taipei Veterans
General Hospital, Taiwan

● ● Luncheon Lecture

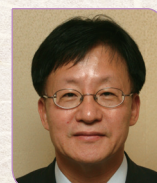

Minsoo Lee
Department of Psychiatry,
Korea University
Anam Hospital, Korea

● ● Evening Lecture



Sung Kil Min
Seoul Metropolitan
Eunpyeong Hospital,
Korea

● ● K-Special Lecture



Joseph D. Terwilliger
Department of Genetics
and Development,
Columbia Genome Center, USA



Ki Woong Kim
Department of
Neuropsychiatry, Bundang Seoul
National University, Korea

Meeting Information

● ● Meeting Information

Date	September 23(Fri.) – 24(Sat.), 2011
Venue	Grand Hilton Seoul Hotel, Seoul, Korea
Official Language	The Official Language of the Congress will be English
Official Website	http://www.2011AsCNP.org

● ● Secretariat



Please do not hesitate to contact the secretariat if you require any additional information or assistance.
Please address all correspondence to:

Jungang Bldg., 12-15 Wonhyoro 1-dong, Yongsan-gu, Seoul 140-846, Korea
Tel. 82-2-717-5114(rep.) / Fax. 82-2-717-5512 / E-mail. 2011AsCNP@smileml.com

● ● Registration Hour

Registration Desk will be located at Lobby, Convention Center (3F). Operating time is as below:
September 23 (Fri.) 08:00-18:00
September 24 (Sat.) 08:00-16:00

● ● Opening Ceremony

Date: September 23 (Fri.), 09:00-09:15 / Place: Emerald AB, Convention Center (3F)

● ● 4th Council Meeting

Date: September 23 (Fri.), 12:00-14:00 (Invited only) / Place: Peacock Room, Main Hotel (2F)

● ● Social Program

Presidential Dinner

Date: September 22 (Thu.), 18:00-20:00 (Invited only) / Place: Cheongcheondang, Samcheonggak

Evening Lecture & Welcome Reception

All participants can attend the welcome reception. It is a great opportunity for participants to communicate with doctors engaged in psychopharmacology over dinner.

Date: September 23 (Fri.), 18:30-21:00 / Place: Grand Ballroom, Main Hotel (2F)

● ● Closing Ceremony

Date: September 24 (Sat.), 16:10-16:30 / Place: Emerald A, Convention Center (3F)

● ● **Hosted by** Korean College of Neuropsychopharmacology

● ● **Organized by** Asian College of Neuropsychopharmacology

Floor Plan

● ● Convention Center 3F

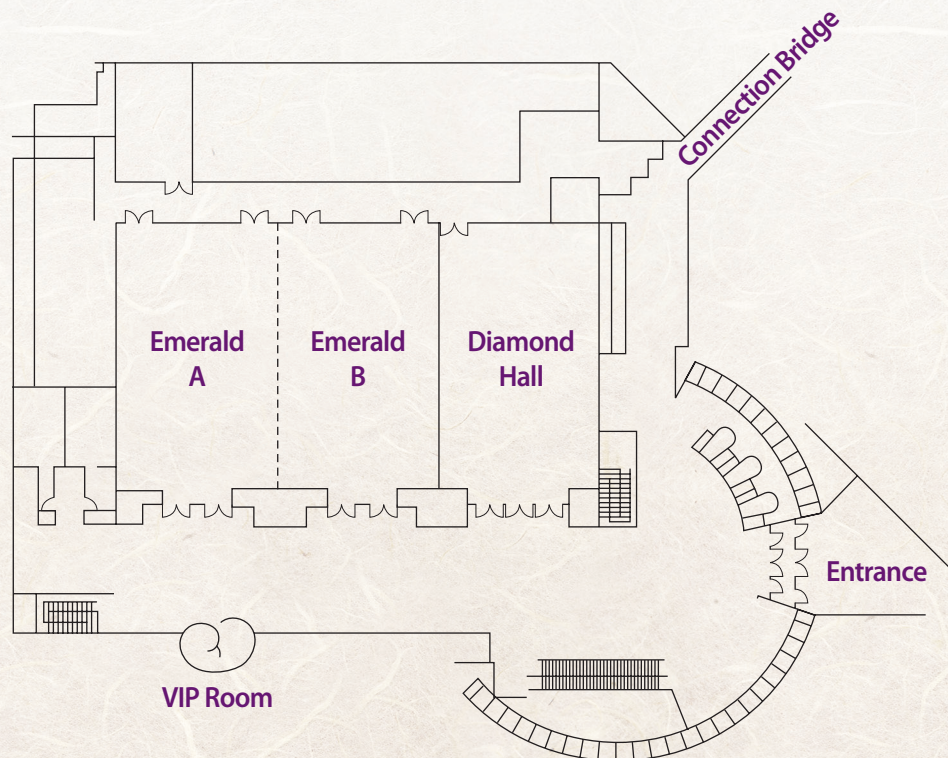

Emerald AB _ Opening Ceremony, Plenary Lecture (1, 2)

Emerald A _ Symposium (1, 5, 11, 15), Luncheon Seminar (1, 4), Special Lecture (1, 3), Thematic Lectures, Closing Ceremony

Emerald B _ Symposium (2, 6, 8, 12, 16), Special Lecture (2, 4), Luncheon Seminar (2, 5)

Diamond _ Symposium (3, 7, 9, 13, 17), Meet the Expert (1, 2), Luncheon Seminar (3), Luncheon Lecture

Lobby _ Registration Desk, Preview Room, Exhibition

● ● Main Hotel 2F

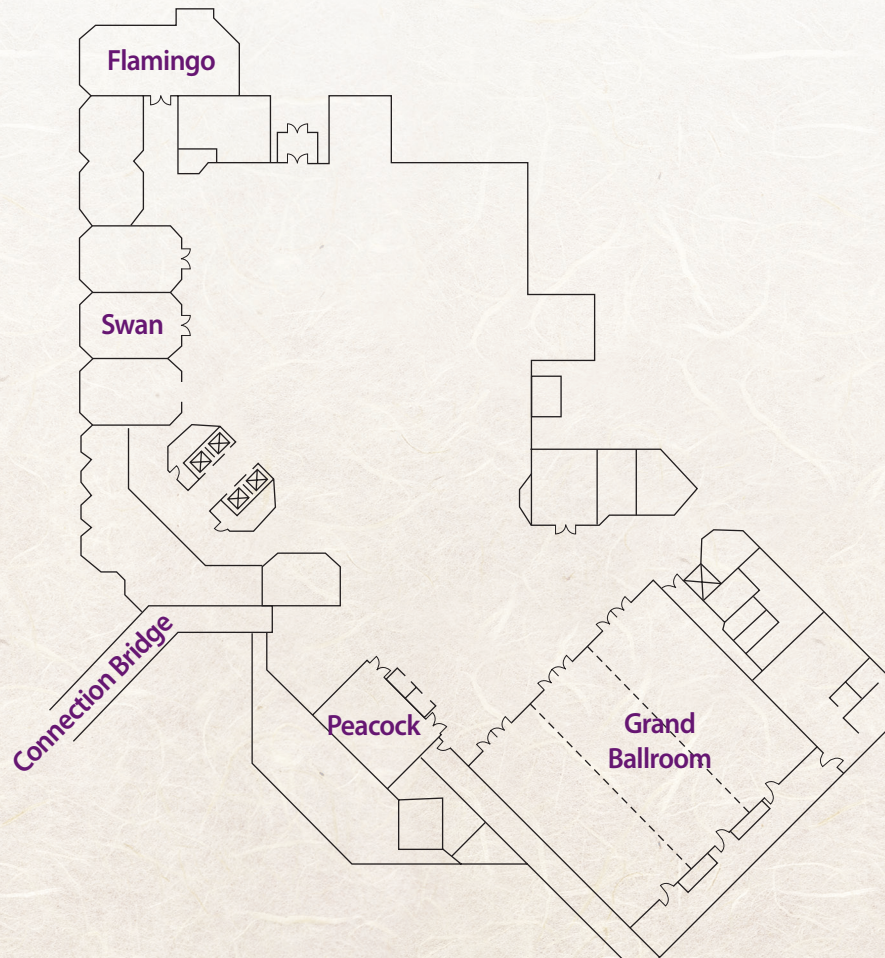

Swan _ Symposium (4, 10, 14), New Research<Oral Presentation> (1, 2)

Flamingo _ K-Special Lecture (1, 2), K-Symposium (1, 2, 3, 4, 5)

Grand Ballroom _ Evening Lecture & Welcome Reception

Peacock _ 4th Council Meeting (Invited only)

● ● Convention Center 1F

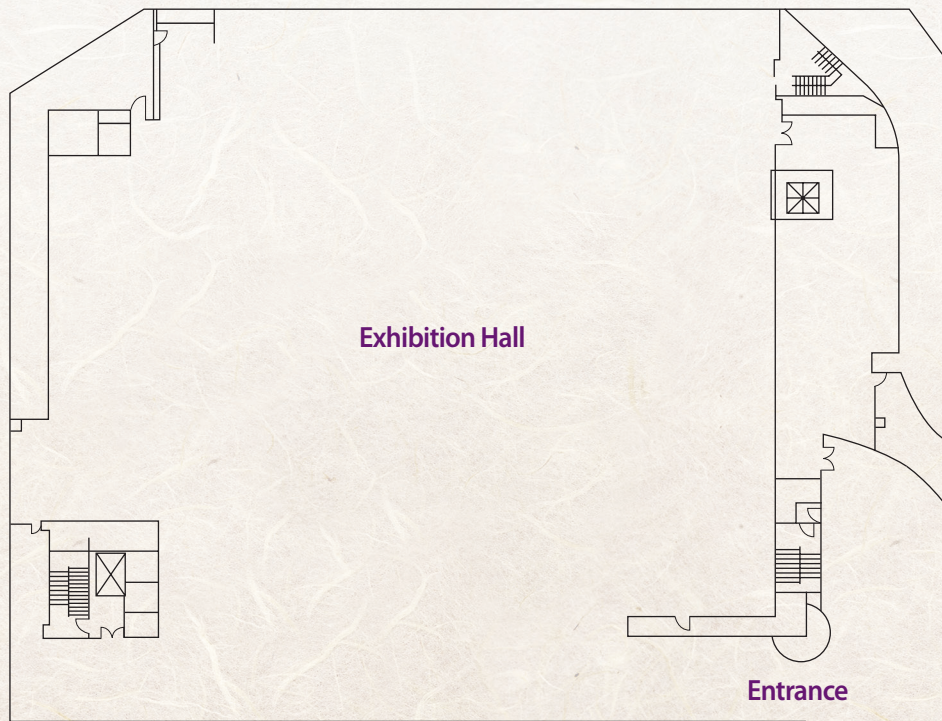

Exhibition Hall _ Poster Presentations, Exhibition, Secretariat

Program at a Glance

Sep. 23(Fri.), 2011

	AsCNP				KCNP
	Emerald A	Emerald B	Diamond	Swan	Flamingo
09:00 - 09:15	Opening Ceremony				
09:15 - 10:00	Plenary Lecture 1 A Role of AKT-GSK3 Signaling Pathway in the Action of Atypical Antipsychotic Drugs				
10:00 - 10:20	Coffee Break				
10:20 - 12:00	Symposium 1 Optimal Pharmacological Treatment for Patients with First Episode Psychosis (FEP)	Symposium 2 Recent Advances in Pharmacotherapy for Mood Disorders	Symposium 3 Breaking Researches on Neuropsychopharmacology: From Basic Neuroscience Research to Clinical Study	Symposium 4 New Targets for Medical Treatment of Substance Use Disorders	K-Symposium 1 Some Big Questions for Bipolar Disorder
12:10 - 13:10	Luncheon Seminar 1	Luncheon Seminar 2	Luncheon Seminar 3		
13:10 - 13:50	Poster Presentations (Exhibition Hall, Convention Center, 1F)				
13:50 - 15:30	Symposium 5 Translational Researches on Bipolar Disorders: From Bench to Clinic	Symposium 6 Study of Bipolar Disorder among the South-east Asia Countries	Symposium 7 A New Paradigm of Genetic Studies in Psychopharmacology	New Research 1 (Oral Presentation 1)	K-Symposium 2 Sleep and Wake: From Basic Science to Clinical Practice
15:30 - 16:20	Special Lecture 1 Glutamatergic Treatment Strategies for Schizophrenia and Depression: A Translational Neuroscience Perspective	Special Lecture 2 Social Cognition in Schizophrenia	Meet the Expert 1 New Approaches to Targeting Muscarinic Receptors to Treat Psychiatric Disorders		K-Special Lecture 1 Perspectives on Psychiatric Genetics: What We Know and Why We Don't Know What We Don't Know
16:20 - 16:40	Coffee Break				
16:40 - 18:20	Thematic Lectures Advances in Asian Neuropsychopharmacology	Symposium 8 Social-emotional Memory Processing in Psychiatric Disorders: A New Aspect of Psychopharmacology	Symposium 9 Depression – From Aetiology to Pathology and Treatment Effects	Symposium 10 Neurogenesis in Depression and Addiction	K-Symposium 3 Evidenced-based Treatment for ADHD: "Real-World" Practice Implications
18:20 - 18:30					
18:30 - 20:00	Evening Lecture & Welcome Reception (Grand Ballroom)				

Sep. 24(Sat.), 2011

	AsCNP				KCNP
	Emerald A	Emerald B	Diamond	Swan	Flamingo
09:00 - 09:45	Plenary Lecture 2 Progress in Schizophrenia Research and its Relation to Future Drug Developments and Treatment Strategies				
09:45 - 10:05	Coffee Break				
10:05 - 11:45	Symposium 11 (AsCNP-CINP Joint Symposium) Recent Advances in Neuropsychopharmacology	Symposium 12 Maximization of Clinical Benefit of Clozapine in Asian Countries	Symposium 13 Omega-3 Fatty Acids in Depression and Anxiety: From Bench to Bedside	Symposium 14 The Neuropsychopharmacological Treatment Approach in ADHD: From Neurobiological to Functional Imaging Perspective	K-Symposium 4 Discrepancies of Pharmacotherapy between Textbooks and Real World Clinical Practice, Part III
11:45 - 12:30	Special Lecture 3 Back to the Future: Seeking Novel Drugs from Traditional Knowledge	Special Lecture 4 Neuroimaging of Social Brain and Emotional Brain: Implications for Mood Disorder and Eating Disorder	Meet the Expert 2 OCD – Focus on Where We Draw the Line on Issues such as Delusions and Obsessions, Behavioral Addiction and Treatment Resistant OCD		K-Special Lecture 2 Dementia is a Mental Illness!
12:40 - 13:40	Luncheon Seminar 4	Luncheon Seminar 5	Luncheon Lecture		
13:40 - 14:30	Poster Presentations (Exhibition Hall, Convention Center, 1F)				
14:30 - 16:10	Symposium 15 Recent Advances in Pharmacotherapy for Anxiety Disorders	Symposium 16 Psychopathology and Electrophysiological Abnormality of Schizophrenia Patients	Symposium 17 Genetics and Neuroimaging of Autism Spectrum Disorders (ASD): Targeting to the Pharmacological Approach	New Research 2 (Oral Presentation 2)	K-Symposium 5 Good Psychopharmacology Needs Good Nosology
16:10 - 16:30	Closing Ceremony				

AsCNP Scientific Program

● ● Friday, September 23, 2011

Plenary Lecture 1

Chair: Shigeto Yamawaki (Hiroshima University, Japan)

09:15-10:00

Emerald AB

Young Hoon Kim (Inje University, Korea)

A Role of AKT-GSK3 Signaling Pathway in the Action of Atypical Antipsychotic Drugs

Symposium 1

Optimal Pharmacological Treatment for Patients with First Episode Psychosis (FEP)

Chair: Young-Chul Chung (Chonbuk National University, Korea)

Co-Chair: Hai-Gwo Hwu (National Taiwan University, Taiwan)

10:20-12:00

Emerald A

- | | |
|------|---|
| S1-1 | Hai-Gwo Hwu (National Taiwan University, Taiwan)
Predictors of Treatment Response in FEP: An Optimal Holistic Treatment for FEP |
| S1-2 | Kotaro Hatta (Juntendo University Nerima Hospital, Japan)
Comparative Effectiveness of Second Generation Antipsychotics in First-episode Psychosis |
| S1-3 | Tianmei Si (Peking University, China)
Early Use of Clozapine in First-episode Patients |
| S1-4 | Sang-Hyuk Lee (CHA University, Korea)
Use of Long-acting Antipsychotics in First-episode Psychosis |

Symposium 2

Recent Advances in Pharmacotherapy for Mood Disorders

Chair: Moon Yong Chung (Seoul Veterans Hospital, Korea)

Co-Chair: Teruhiko Higuchi (NCNP, Japan)

10:20-12:00

Emerald B

- | | |
|------|--|
| S2-1 | Thomas E. Schlaepfer (University of Bonn, Germany)
Biological Aspects of Mood Disorder |
| S2-2 | Duk-In Jon (Hallym University, Korea)
The Clinical Trials in Patients with Depression Conducted in Korea |
| S2-3 | Won Kim (Inje University, Korea)
The Clinical Trials in Patients with Bipolar Disorder Conducted in Korea |
| S2-4 | Chia-Yih Liu (Chang Gung University School of Medicine, Taiwan)
Combination Therapy - A More Efficient Treatment Strategy for Major Depressive Disorder |

Symposium 3

Breaking Researches on Neuropsychopharmacology: From Basic Neuroscience Research to Clinical Study

Chair: Xin Yu (Peking University, China)

Co-Chair: Doh Kwan Kim (Sungkyunkwan University, Korea)

10:20-12:00		Diamond
S3-1	Jae-Min Kim (Chonnam National University, Korea) Vascular Risk / Disease and Depression in Late-life	
S3-2	Deng Hong (Huaxi Hospital Mental Health Center, China) Establishment and Evaluation of an Integrative Rehabilitation Model for Schizophrenia in Southwest China	
S3-3	Doh Kwan Kim (Sungkyunkwan University, Korea) Discovery and Application of Genomic Markers of Antidepressant Treatment	
S3-4	Jong-Hoon Kim (Gachon University, Korea) Effects of Age on Dopamine D2/3 Receptor Availability in Striatal Subdivisions: A High-Resolution Positron Emission Tomography Study	

Symposium 4

New Targets for Medical Treatment of Substance Use Disorders

Chair: Ichiro Sora (Tohoku University, Japan)

Co-Chair: Sung-Gon Kim (Pusan National University, Korea)

10:20-12:00		Swan
S4-1	Kiyofumi Yamada (Nagoya University, Japan) Nicotinic Receptors: A Potential Drug Target for Treatment of Cognitive Impairments Associated with Methamphetamine Dependence	
S4-2	Hyoung-Chun Kim (Kangwon National University, Korea) Protective Potential of Glutathione Peroxidase Gene in Methamphetamine-induced Neuropsychotoxicity	
S4-3	Doo-Sup Choi (Mayo Clinic College of Medicine, USA) Adenosine-regulated Glutamate Signaling in the Striatum: Novel Targets for Alcohol Use Disorders	
S4-4	Kazutaka Ikeda (Tokyo Metropolitan Institute of Medical Science, Japan) GIRK Channels as Candidate Targets for Pharmacotherapy of Drug and Alcohol Dependence	

Luncheon Seminar 1

Metabolic Syndrome in Patients Taking Second Generation Antipsychotics

Chair: Jun Soo Kwon (Seoul National University, Korea)

12:10-13:10

Emerald A

Yong Sik Kim (Seoul National University, Korea)

Metabolic Syndrome in Patients Taking Second Generation Antipsychotics

Luncheon Seminar 2

The Challenge of Improving Treatment Outcomes in Depression

Chair: Cheol Lee (The Catholic University of Korea, Korea)

12:10-13:10

Emerald B

12:10-12:40

Ho-Suk Suh (CHA University, Korea)

Examining Opportunities for Increasing Treatment Success in Mood Disorders

12:40-13:10

Ornah T. Levine-Dolberg (Lundbeck HQ)

Using the Latest Evidence to its Full Potential in the Treatment of Mood & Anxiety Disorders - Opportunities for Increasing Treatment Success

Luncheon Seminar 3

Chair: Won-Myong Bahk (The Catholic University of Korea, Korea)

12:10-13:10

Diamond

Sung-Wan Kim (Chonnam National University, Korea)

"Balanced Approach" in the Long-term Schizophrenia Treatment

Symposium 5

Translational Researches on Bipolar Disorders: From Bench to Clinic

Chair: Kyooseob Ha (Seoul National University, Korea)

Co-Chair: Ru-Band Lu (National Cheng Kung University, Taiwan)

13:50-15:30

Emerald A

- S5-1 **ZeZhi Li** (Shanghai Mental Health Center, China)
 Down-regulated Brain-derived Neurotrophic Factor Expression is Involved in Bipolar Disorder
- S5-2 **Hiroaki Kawasaki** (Kyushu University, Japan)
 Temperament and Character Inventory Scale (TCI) and Genetic Variants with Japanese Bipolar Disorder
- S5-3 **Yun-Hsuan Chang** (National Cheng Kung University, Taiwan)
 Comorbidity Rate of Alcoholism in Bipolar Disorders
- S5-4 **Boseok Cha** (Gyeongsang National University, Korea)
 Psychiatric and Physical Comorbidity of Bipolar Disorder Patients in Korea

Symposium 6

Study of Bipolar Disorder among the South-East Asia Countries

Chair: Andi J. Tanra (Hasanuddin University, Indonesia)

Co-Chair: Rusdi Abd Rashid (Malaysian Psychiatric Association, Malaysia)

13:50-15:30

Emerald B

- S6-1 **Roger Chun Man Ho** (National University of Singapore, Singapore)
 Lipidomic Signature in the Serum of Bipolar Disorder and Depressive Disorder by Profiling of Case-control Collections
- S6-2 **Anne H. A Yee** (University of Malaya, Malaysia)
 Substance Use and Bipolar Disorder: The Prevalence, Psychosocial Correlations and Outcomes at University Malaya Medical Centre (UMMC), Malaysia
- S6-3 **Margarita M. Maramis** (Airlangga University, Indonesia)
 Pattern of Psychopharmacotherapy in Bipolar Patients at Surabaya-Indonesia
- S6-4 **Andi J. Tanra** (Hasanuddin University, Indonesia)
 Genetic Analysis of Bipolar Disorder in Makasar, Indonesia

Symposium 7

A New Paradigm of Genetic Studies in Psychopharmacology

Chair: Yeon Ho Joo (University of Ulsan, Korea)

Co-Chair: Joseph D. Terwilliger (Columbia University, USA)

13:50-15:30

Diamond

- S7-1 Joseph D. Terwilliger (Columbia University, USA)
Study Design for Genetic Studies in Psychiatry
- S7-2 Kyung Sue Hong (Sungkyunkwan University, Korea)
Pharmacogenetics of Adverse Effects of Antipsychotics
- S7-3 Gavin P. Reynolds (Sheffield Hallam University, UK)
Pharmacogenetics of Symptom Response to Antipsychotic Treatment
- Discusson

New Research 1 (Oral Presentation 1)

Chair: Joocheol Shim (Inje University, Korea)

Co-Chair: Tetsuro Ohmori (University of Tokushima, Japan)

13:50-15:30

Swan

- NR1-1 Hsiao-Lun Ku (Taipei Veterans General Hospital, Taiwan)
Dynamic Associations between Neuroimage Findings and Emotional Changes
One Week and One Month after Ischemic Stroke
- NR1-2 Mamiko Koshiba (Tokyo University of Agriculture and Technology, Japan)
Multi-parametric Correlation Analysis of Behavioral and Biophysical Signals
in Animal Models Can Be Applicable to Diagnosis of Socio-emotional Development and
QOL Improvement over All Generation
- NR1-3 Soo-Hee Choi (Yonsei University, Korea)
Neural Network Functional Connectivity During an Episode of Delirium
- NR1-4 Daeyoung Roh (Yonsei University, Korea)
Two-year Follow-up of Deep Brain Stimulation for Refractory
Obsessive-compulsive Disorder
- NR1-5 Reiji Yoshimura (University of Occupational and Environmental Health, Japan)
No Association between Responses to the Addition of an Atypical Antipsychotic Drug
to a SSRI or SNRI and BDNF (Val66Met) Polymorphism in Refractory Major Depressive
Disorder in Japanese Patients

Special Lecture 1

Chair: Young Hoon Kim (Inje University, Korea)

15:30-16:20

Emerald A

- SL1 John H. Krystal (Yale University School of Medicine, USA)
 Glutamatergic Treatment Strategies for Schizophrenia and Depression: A Translational Neuroscience Perspective

Special Lecture 2

Chair: Yuan-Hwa Chou (Taipei Veterans General Hospital, Taiwan)

15:30-16:20

Emerald B

- SL2 Chang-Yoon Kim (University of Ulsan, Korea)
 Social Cognition in Schizophrenia

Meet the Expert 1

Chair: Hyun-Sang Cho (Yonsei University, Korea)

15:30-16:20

Diamond

- ME1 Brian Dean (Mental Health Research Institute and University of Melbourne, Australia)
 New Approaches to Targeting Muscarinic Receptors to Treat Psychiatric Disorders

Thematic Lectures

Advances in Asian Neuropsychopharmacology

Chair: Chan-Hyung Kim (Yonsei University, Korea)

16:40-18:20

Emerald A

- TL1 Xin Yu (Peking University, China)
 Neurocognition Assessment and Psychopharmacological Treatment
- TL2 Shigenobu Kanba (University of Kyushu, Japan)
 Current Perspective on Neurobiology of Depression
- TL3 Yuan-Hwa Chou (Taipei Veterans General Hospital, Taiwan)
 Interaction of BDNF and Brain Serotonin Transporter (SERT) Expression in Different Genotyping of Serotonin Transporter Gene in Asian Population: A New Insight for the Development of Antidepressant
- Discussion

Symposium 8

Social-emotional Memory Processing in Psychiatric Disorders: A New Aspect of Psychopharmacology

Chair: Jun Ishigooka (Tokyo Women's Medical University, Japan)

Co-Chair: Li Xiaobai (China Medical University, China)

16:40-18:20

Emerald B

- S8-1 Takeshi Inoue (Hokkaido University, Japan)
Emotional Memory and Animal Models of Psychiatric Disorders: An Overview and Learning-based Animal Models of Anxiety
- S8-2 Li Xiaobai (China Medical University, China)
Behavioral Pharmacology of Depression: Focusing on the Chronic Mild Stress in Rodent
- S8-3 Ken Inada (Tokyo Women's Medical University, Japan)
Amygdala Dopamine Release in Response to Conditioned Fear-induced Stress in a Rat Model of Schizophrenia
- S8-4 Kyoung-Uk Lee (The Catholic University of Korea, Korea)
Emotion and Memory: Considerations from Psychiatric Disorders

Symposium 9

Depression – From Aetiology to Pathology and Treatment Effects

Chair: Gavin P. Reynolds (Sheffield Hallam University, UK)

Co-Chair: ZhiJun Zhang (SouthEast University, China)

16:40-18:20

Diamond

- S9-1 Gavin P. Reynolds (Sheffield Hallam University, UK)
Brain NAA Deficits in Depression – A Marker of Neuronal Pathology
- S9-2 ZhiJun Zhang (SouthEast University, China)
The Learning and Memory Alterations are Associated with Hippocampal N-acetylaspartate in an Animal Model of Depression as Measured by 1H-MRS
- S9-3 Zahurin Binti Mohamed (University of Malaya, Malaysia)
Association Study of Tryptophan Hydroxylase 2 and Serotonin Transporter Genes with Major Depressive Disorder in Malaysian Ethnic Subgroups
- S9-4 Xiang Rong Zhang (Southeast University, China)
Influence and Interaction of Genetic Polymorphisms in the Monoaminergic System on Antidepressant Drug Response

Symposium 10
Neurogenesis in Depression and Addiction

Chair: Han Yong Chung (Soonchunhyang University, Korea)

Co-Chair: Toshikazu Saito (Sapporo Medical University, Japan)

16:40-18:20 Swan

- S10-1 Shih-Jen Tsai (Taipei Veterans General Hospital, Taiwan)
 The Role of BDNF and Receptors in Depression and Antidepressant Action
- S10-2 Yong-Ku Kim (Korea University, Korea)
 Stress, Inflammation and Neurogenesis in Depression
- S10-3 Toshikazu Saito (Sapporo Medical University, Japan)
 Neurogenesis of Alcohol Related Problems and Depression
- S10-4 Dai Jin Kim (The Catholic University of Korea, Korea)
 Neurogenesis and Addiction (alcohol and smoking)

Evening Lecture

Chair: Min Cheol Park (Wonkwang University, Korea)

18:30-18:50 Grand Ballroom

- EL Sung Kil Min (Seoul Metropolitan Eunpyeong Hospital, Korea)
 Anger: A Forgotten Emotion in Psychiatric Research

● ● **Saturday, September 24, 2011**

Plenary Lecture 2

Chair: Jin-Sang Yoon (Chonnam National University, Korea)

09:00-09:45

Emerald AB

Hans-Jürgen Möller (University Clinic of Munich, Germany)
Progress in Schizophrenia Research and its Relation to Future Drug Developments and Treatment Strategies

Symposium 11 (AsCNP-CINP Joint Symposium)

Recent Advances in Neuropsychopharmacology

Chair: Jun Soo Kwon (Seoul National University, Korea)

Co-Chair: Hans-Jürgen Möller (University Clinic of Munich, Germany)

10:05-11:45

Emerald A

- S11-1 **Anthony G. Phillips** (UBC Institute of Mental Health, Canada)
Glucocorticoid Receptors in the Pre-frontal Cortex: Novel Targets for Stress-induced Cognitive Deficits
- S11-2 **Brian Dean** (Mental Health Research Institute and University of Melbourne, Australia)
The Need to Consider Functional Pharmacology in Understanding the Efficacy of Antipsychotic Drugs
- S11-3 **Yeon Ho Joo** (University of Ulsan, Korea)
Antipsychotics and Remissions in Schizophrenia and Bipolar Disorder
- S11-4 **Nakao Iwata** (Fujita Health University, Japan)
Polypharmacy and Medication-adherence in Antipsychotics Treatment in Japanese Clinical Setting

Symposium 12

Maximization of Clinical Benefit of Clozapine in Asian Countries

Chair: Tetsuro Ohmori (University of Tokushima, Japan)

Co-Chair: Chan-Hyung Kim (Yonsei University, Korea)

10:05-11:45

Emerald B

- S12-1 Yasuhiro Kaneda (Iwaki Clinic Tokushima, Japan)
Long Term Effects of Clozapine on Cognitive and Social Function in Schizophrenia
- S12-2 Ya Mei Bai (Taipei Veterans General Hospital, Taiwan)
Long Term Clinical and Metabolic Effects of Clozapine
- S12-3 Su Young Lee (Kwandong University, Korea)
The 20 years Experiences of Clozapine and its Optimal Use in Korea
- S12-4 Ichiro Kusumi (Hokkaido University, Japan)
Pharmacological Profile of Clozapine and its Clinical Implication

Symposium 13

Omega-3 Fatty Acids in Depression and Anxiety: From Bench to Bedside

Chair: Kuan-Pin Su (China Medical University, Taiwan)

Co-Chair: Chang Uk Lee (The Catholic University of Korea, Korea)

10:05-11:45

Diamond

- S13-1 David Mischoulon (Massachusetts General Hospital, USA)
Fish Oil as an Antidepressant: Recent Clinical Evidence
- S13-2 Kei Hamazaki (University of Toyama, Japan)
Omega-3 Fatty Acids for Secondary Prevention of Posttraumatic Stress Disorder Following Accidental Injury
- S13-3 Kuan-Pin Su (China Medical University & Hospital, Taiwan)
Mind-body Interface: Omega-3 Fatty Acids in Somatic Anxious Symptoms in Depression
- S13-4 Cai Song (Dalhousie University, Canada)
Omega-3 Fatty Acids on Depression, Anxiety and Sickness Behaviour in Animal Models

Symposium 14

The Neuropsychopharmacological Treatment Approach in ADHD: From Neurobiological to Functional Imaging Perspective

Chair: Soo-Churl Cho (Seoul National University, Korea)

Co-Chair: Keiko Yoshida (Kyushu University, Japan)

10:05-11:45

Swan

- S14-1 Tjhin Wiguna (University of Indonesia, Indonesia)
The Effect of 20 mg Long-acting Methylphenidate toward Neurometabolite Changing in Prefrontal Cortex and Anterior Cingulate Gyrus: A 1H Magnetic Resonance Spectroscopy (MRS) Study
- S14-2 Tsuneo Takei (Kyushu University, Japan)
A Clinical Experience in Strategy of Psycho-Pharmacotherapy for Aggressive Adolescent
- S14-3 Young Hui Yang (Pusan National University, Korea)
Changes of Regional Cerebral Blood Flow after Methylphenidate Treatment in Children with ADHD: SPECT Study
- S14-4 Sasanti Yuniar Santo Sewoyo (Airlangga University, Indonesia)
The Effect of Zinc Augmentation in Managing Children with ADHD: A Preliminary Observation

Special Lecture 3

Chair: Yong Sik Kim (Seoul National University, Korea)

11:45-12:30

Emerald A

- SL3 Anthony G. Phillips (UBC Institute of Mental Health, Canada)
Back to the Future: Seeking Novel Drugs from Traditional Knowledge

Special Lecture 4

Chair: Tung-Ping Tom Su (Taipei Veterans General Hospital, Taiwan)

11:45-12:30

Emerald B

- SL4 Shigeto Yamawaki (Hiroshima University, Japan)
Neuroimaging of Social Brain and Emotional Brain: Implications for Mood Disorder and Eating Disorder

Meet the Expert 2

Chair: Kichung Paik (Dankook University, Korea)

11:45-12:30

Diamond

ME2

Joseph Zohar (Tel Aviv University, Israel)

Focus on Where We Draw the Line on Issues such as Delusions and Obsessions, Behavioral Addiction and Treatment Resistant OCD

Luncheon Seminar 4

Shaping the Future of Schizophrenia Patients with Invega Sustenna

Chair: Chang-Yoon Kim (University of Ulsan, Korea)

12:40-13:40

Emerald A

12:40-13:00

Sungku Choi (Janssen Korea, Korea)

Shaping the Future of Schizophrenia Patients with Invega Sustenna

13:00-13:40

Discussants - SungKu Choi (Janssen Korea) / Suk Koon An (Yonsei University, Korea) / Yuan-Hwa Chou (Taipei Veterans General Hospital, Taiwan)

Panel Discussion on the Optimal Patients for Invega Sustenna

Luncheon Seminar 5

Duloxetine - Scientific Data and Clinical Development in Depression

Chair: Jin-Sang Yoon (Chonnam National University, Korea)

12:40-13:40

Emerald B

Thomas E. Schlaepfer (University of Bonn, Germany)

Duloxetine - Scientific Data and Clinical Development in Depression

Luncheon Lecture

Chair: Sung Kil Min (Seoul Metropolitan Eunpyeong Hospital, Korea)

12:40-13:40

Diamond

Min-Soo Lee (Korea University, Korea)

Pharmacogenetics in Psychiatry: Is it Ready for Clinical Application?

Symposium 15

Recent Advances in Pharmacotherapy for Anxiety Disorders

Chair: Kang Sub Oh (Sungkyunkwan University, Korea)

Co-Chair: Joseph Zohar (Tel Aviv University, Israel)

14:30-16:10

Emerald A

- S15-1 Erin Chia-Hsuan Wu (Far East Polyclinic, Taiwan)
Pharmacotherapy of Panic Disorder in Taiwan
- S15-2 Jeong-Ho Chae (The Catholic University of Korea, Korea)
Use of r-TMS in Treatment of Anxiety Disorders
- S15-3 Min Seong Koo (Kwandong University, Korea)
Role of Dopamine in Pathophysiology and Treatment of Obsessive-compulsive Disorder
- S15-4 Joseph Zohar (Tel Aviv University, Israel)
PTSD - The Future of a Disorder where the Past is Always Present: Interplay between Preclinical, Clinical and Translational Research

Symposium 16

Psychopathology and Electrophysiological Abnormality of Schizophrenia Patients

Chair: Dae-Yeob Kang (Young-in Mental Hospital, Korea)

Co-Chair: He Yanling (Shanghai Mental Health Center, China)

14:30-16:10

Emerald B

- S16-1 Junghee Lee (University of California, USA)
Underlying Mechanisms of Social Cognitive Impairments in Schizophrenia
- S16-2 Toshiaki Onitsuka (Kyushu University, Japan)
Reduced High and Low Frequency Gamma Synchronisation and Auditory Hallucinations in Schizophrenia
- S16-3 Seung-Hwan Lee (Inje University, Korea)
Facial Perception Abnormality Reflect Psychopathology of Schizophrenia Patients
- S16-4 Mariko Tada (University of Tokyo, Japan)
Mismatch Negativity and Gamma Band Auditory Steady-state Response in Subjects with an At-risk Mental State and First-episode Schizophrenia Patients

Symposium 17

Genetics and Neuroimaging of Autism Spectrum Disorders (ASD): Targeting to the Pharmacological Approach

Chair: Nobumasa Kato (Showa University, Japan)

Co-Chair: Chul-Ho Jung (Keimung University, Korea)

14:30-16:10	Diamond
S17-1	Yeni Kim (Seoul National Hospital, Korea) Molecular Targets for Neuropharmacological Treatment in Autism Spectrum Disorders
S17-2	Tsukasa Sasaki (University of Tokyo, Japan) Overcoming Challenges in Genetic Studies of Autism-Spectrum-Disorder: Prior to Application to Pharmacology (In the Symposium: Genetics and Neuroimaging of Autism Spectrum Disorders (ASD): Targeting to the Pharmacological Approach)
S17-3	Hidenori Yamasue (University of Tokyo, Japan) Oxytocina and Autism, Imaging Genetics and Pharmatherapeutic Implication
S17-4	Susan Shur-Fen Gau (National Taiwan University, Taiwan) Genetics and Imaging on Autism Spectrum Disorders: Evidence from Taiwan Research

New Research 2 (Oral Presentation 2)

Chair: In-Won Chung (Dongguk University, Korea)

Co-Chair: Hsien-Yuan Lane (China Medical University, Taiwan)

14:30-16:10	Swan
NR2-1	Kyung Soon Shin (Seoul National University, Korea) Neuromagnetic Evidence of Abnormal Auditory Evoked Response and its Relation to Cortical Thickness in Ultra-High-Risk for Psychosis and Patients with Schizophrenia
NR2-2	Atsushi Sato (The University of Tokyo, Japan) Autism-like Behaviors in Mouse Models of Tuberous Sclerosis Complex and their Recovery by Rapamycin
NR2-3	Youl-Ri Kim (Inje University, Korea) Medical Findings in Korean Patients with Eating Disorders
NR2-4	Anu Kant Mital (Rajiv Gandhi Medical College, India) Neurological Correlates of Empathy in Psychiatric Disorders and Especially in Autism

KCNP Scientific Program

● ● Friday, September 23, 2011

K-Symposium 1

Some Big Questions for Bipolar Disorder

Chair: Baik Seok Kee (Chungang University, Korea)

Co-Chair: Youngmyo Jae (Bong Seng Hospital, Korea)

10:20-12:00

Flamingo

- K-S1-1 Jung Goo Lee (Inje University, Korea)
Is Recurrent Depression Bipolar Disorder?
- K-S1-2 Kyooseb Ha (Seoul National University, Korea)
Management of Bipolar Depression: Lamotrigine and Beyond
- K-S1-3 Hyun-Sang Cho (Yonsei University, Korea)
How to Deal with Cognitive Impairments in Bipolar Disorder?
- K-S1-4 Yoo-Sook Joung (Sungkyunkwan University, Korea)
Childhood Depressive Disorder and Bipolar Disorder

K-Symposium 2

Sleep and Wake: From Basic Science to Clinical Practice

Chair: In Young Yoon (Seoul National University, Korea)

Co-Chair: Doo-Heum Park (Kunkuk University, Korea)

13:50-15:30

Flamingo

- K-S2-1 Seockhoon Chung (University of Ulsan, Korea)
Energy Hypothesis and Sleep Regulation
- K-S2-2 Heon-Jeong Lee (Korea University, Korea)
Sleep Disorder and Circadian Rhythm Dysregulation
- K-S2-3 Hong Beom Shin (Komoki Sleep Center, Korea)
Antidepressant as a Hypnotic Drug
- K-S2-4 Seung Chul Hong (The Catholic University of Korea, Korea)
Modafinil, an Alerting Agent

K-Special Lecture 1

Chair: Seong Yoon Kim (University of Ulsan, Korea)

15:30-16:20

Flamingo

- K-SL1 Joseph D. Terwilliger (Columbia University, USA)
Perspectives on Psychiatric Genetics: What We Know and Why We Don't Know
What We Don't Know

K-Symposium 3

Evidence-based Treatment for ADHD: "Real-World" Practice Implications

Chair: Dong-Ho Song (Yonsei University, Korea)

Co-Chair: Young Sik Lee (Chungang University, Korea)

16:40-18:20

Flamingo

- K-S3-1 Jun-Won Hwang (Eulji University, Korea)
Is ADHD Overdiagnosed?
- K-S3-2 Soyoung Lee (Soonchunhyang University, Korea)
Effectiveness on Symptom, Cognitive Function, and Quality of Life
- K-S3-3 Keun-ah Cheon (Yonsei University, Korea)
Prediction of Treatment Response in ADHD
- K-S3-4 Hyo-Won Kim (University of Ulsan, Korea)
Safety of Psychostimulant, Myth or Reality?

● ● **Saturday, September 24, 2011**

K-Symposium 4

Discrepancies of Pharmacotherapy between Textbooks and Real World Clinical Practice, Part III

Chair: Hyo-Deog Rim (Kyungpook National University, Korea)

Co-Chair: Ihn-Geun Choi (Hallym University, Korea)

10:05-11:45 Flamingo

- K-S4-1 Sang-Yeol Lee (Wonkwang University, Korea)
Somatoform Disorder
- K-S4-2 Young Chul Shin (Sungkyunkwan University, Korea)
Pharmacotherapy of Pathological Gambling - Between Textbooks and
Real Clinical World-
- K-S4-3 Dai-Jin Kim (The Catholic University of Korea, Korea)
Discrepancies of Pharmacotherapy between Textbooks and
Real World Clinical Practice, Addiction
- Discussion

K-Special Lecture 2

Chair: Byoung Hoon Oh (Yonsei University, Korea)

11:45-12:30 Flamingo

- K-SL2 Ki Woong Kim (Seoul National University, Korea)
Dementia is a Mental Illness!

K-Symposium 5

Good Psychopharmacology Needs Good Nosology

Chair: Leen Kim (Korea University, Korea)

Co-Chair: Jeong-Gee Kim (Pusan Maryknoll Hospital, Korea)

14:30-16:10 Flamingo

- K-S5-1 Ung Gu Kang (Seoul National University, Korea)
Does Dopamine Prevail All Across the Psychiatric Manifestations?
- K-S5-2 Suk Kyoan An (Yonsei University, Korea)
Why Are Anti-schizophrenic Drugs Increasingly Used in Other Psychiatric
Disorders Recently?
- K-S5-3 Byung-Joo Ham (Korea University, Korea)
Is Treatment Resistant Depression Misnomer? Where Do Antidepressants Work?
- Discussion

Poster Session

●● Addiction

- P_001 Tzu-Yun Wang (National Cheng Kung University, Taiwan)
Possible Interaction between Serotonin Transporter and Serotonin Receptor 1 B G861C Genes Polymorphisms Associated with Antisocial Alcoholism among Han Chinese in Taiwan
- P_002 Yoko Nawata (Nagasaki International University, Japan)
Improvement of Cognitive Impairments on Withdrawal after Repeated Methamphetamine by Administration of a Cannabinoid CB1 Receptor Antagonist and a COX Inhibitor
- P_003 Yoshiaki Miyamoto (University of Toyama, Japan)
Knockdown of Dopamine D2 Receptor in the Nucleus Accumbens Attenuates Methamphetamine-induced Behavioral Responses in Mice
- P_004 Sung-Gon Kim (Pusan National University, Korea)
Effect of Capsaicin on Alcohol Intake in C57Bl/6 Mice
- P_005 Yen Kuang Yang (National Cheng Kung University Hospital, Taiwan)
The Economic Cost of Heroin Users and the Association Annual Heroin Expenditure and Striatal Dopamine Availability
- P_006 Masashi Ikeda (Fujita Health University, Japan)
Shared Risk between Methamphetamine-induced Psychosis and Schizophrenia
- P_007 Sung-Gon Kim (Pusan National University, Korea)
Association Study of Corticotropin-releasing Hormone Receptor 1 (Crhr1) Gene Polymorphism in Korean Alcohol-dependent Patients
- P_008 Min Kwon (The Catholic University of Korea, Korea)
Assessment of Cognitive Status in Diabetic Alcohol Dependent Patients
- P_009 Min Kwon (The Catholic University of Korea, Korea)
The Changes of Blood Glucose Control and Lipid Profiles after Short-term Smoking Cessation in Healthy Males
- P_010 Min Kwon (The Catholic University of Korea, Korea)
The Incidence of Pre-diabetes and Type 2 Diabetes Mellitus in Alcohol Dependent Patients
- P_011 Sung-Wan Kim (Chonnam National University, Korea)
Caffeine Counteracts Impairments in Task-oriented Psychomotor Performance Induced by Chlorpheniramine

●● Affective Disorders and Antidepressants

- P_012 Ji Hyun Baek (Sungkyunkwan University, Korea)
Association of Seasonality and Sleep-wake Cycle in Bipolar I and Bipolar II Disorder

- P_013 Yukio Ago (Osaka University, Japan)
Role of Brain Metabotropic Glutamate 2/3 Receptors in Social Isolation-induced Depressive Behavior of Mice
- P_014 Tung-Ping Tom Su (National Yang-Ming University, Taiwan)
Screening for Affective Bipolarity in Patients with Migraine
- P_015 Qing Zhao (Institute of Psychology, Chinese Academy of Sciences, China)
Further Exploration of Clinical Utility of Neurological Soft Signs: Discrimination of Bipolar Disorder from Major Depression
- P_016 Hyun-Sang Cho (Yonsei University, Korea)
Neurophysiological Findings of Semantic Processing in Bipolar Manic Patients: Comparisons with Schizophrenia
- P_017 Ra Yeon Ha (Yonsei University, Korea)
Effects of Emotional Stimuli on Time Perception in Bipolar Manic Patients
- P_018 Vin Ryu (Kunyang University, Korea)
Altered Probabilistic Reward Learning and its Related Changes of Feedback-related Negativity in Bipolar Patients: Preliminary Results
- P_019 Vin Ryu (Kunyang University, Korea)
Prodromes and Coping Types in Bipolar Patients with Non-psychotic or Psychotic Mania
- P_021 Seung-Hwan Lee (Inje University, Korea)
Clinical Characteristics Associated with Different Strength of Loudness Dependence of Auditory Evoked Potential (LDAEP) in Major Depressive Disorder
- P_022 Naoto Kajitani (Hiroshima University, Japan)
The Increase of FGF-2 Expression by Amitriptyline and Noradrenaline could be Mediated Different Mechanisms in Rat Primary Cultured Astrocytes
- P_023 Woojae Myung (Sungkyunkwan University, Korea)
Serotonin Transporter Gene Polymorphism in Depression: Clinical, Functional and Ethnic Phenotypic Correlates
- P_024 Hiroshi Shimagami (The University of Tokyo, Japan)
Chronic Corticosterone Induces Affective Behaviors and Dendritic Hypertrophy of Basolateral Amygdala Neurons
- P_025 Jayeun Sun (Yonsei University, Korea)
Autobiographical Memory and its Neuropsychological Correlates in Patients with Bipolar Disorder
- P_026 Kunwoo Kim (University of Ulsan, Korea)
Standardization of Korean Version of Depression and Somatic Symptom Scale (DSSS)

- P_027 Sun Hwa Jung (Pusan National University, Korea)
Delay in Recovery of Normal Sleep-wake Cycle after Disruption of Light-dark Cycle in Mice:
A Bipolar Disorder-prone Animal Model?
- P_028 Park Jin Young (Yonsei University, Korea)
Study on Explicit Self-esteem and Implicit Self-esteem in Bipolar Patients
- P_029 Won-Myong Bahk (The Catholic University of Korea, Korea)
A Naturalistic Study on the Drug Use Trend among Inpatients with Bipolar Disorder in a Hospital
- P_030 Won-Myong Bahk (The Catholic University of Korea, Korea)
The Drug Use Trend in the Treatment of Continuation Phase in Bipolar Disorder
- P_031 Won-Myong Bahk (The Catholic University of Korea, Korea)
Effect of Initial Ziprasidone Dose on Treatment of Korean Patients with Acute Manic or Mixed Episodes
- P_032 Won-Myong Bahk (The Catholic University of Korea, Korea)
The Change of Platelet Counts after Administrations of Escitalopram, Fluoxetine, Paroxetine,
Venlafaxine, Mirtazapine, Bupropion in Depressive Patients
- P_033 Won-Myong Bahk (The Catholic University of Korea, Korea)
Adjunctive Tianeptine for Partial or Nonresponders to Selective Serotonin Reuptake Inhibitor
Treatment in Major Depressive Disorder
- P_034 Naoki Hiramatsu (Osaka University, Japan)
Involvement of 5-HT_{1A} Receptors in Fluvoxamine-induced Enhancement
of Prefrontal Dopamine Release
- P_035 Yoshihiro Nakata (Hiroshima University, Japan)
Tricyclic Antidepressant Amitriptyline Increases Glial Cell Line-derived Neurotrophic Factor (GDNF)
Production through the Activation of Fibroblast Growth Factor Receptor (FGFR) in Glia
- P_036 Emi Tsujimoto (Kwansei Gakuin University, Japan)
Efficacy of Olanzapine for Depression in Mixed Episode
- P_037 Agus Japari (Hasanuddin University, Indonesia)
Comparison of Venlafaxine and Amitriptyline to the Degree Depression, Blood Pressure and
Sexual Dysfunction in Depressed Patient
- P_038 Hitoshi Takahashi (Tokyo Women's Medical University, Japan)
Effect of Another SSRI in Patients with Depression Who Are Intolerant to Nausea/Vomiting Induced
by an Ongoing SSRI
- P_039 Jae Seung Chang (Seoul National University, Korea)
Alterations in Central Autonomic Regulation in Young Women with Recurrent Major Depressive
Disorder Receiving Escitalopram or Venlafaxine

- P_040 Kazumi Miyawaki (Ehime University Graduate School of Medicine, Japan)
Desynchronization of Circadian Rhythm in Running Activity Following Restricted Feeding in Mice: Effect of Antidepressants
- P_041 Noriko Yamada (Ehime University Graduate School of Medicine, Japan)
Identification of Antidepressant-like Metabolites of Ginsenoside Rb1 Using a Menopausal Depressive-like State in Female Mice: A Possible Role of 5-HT_{2A}-Receptors
- P_042 Cheng-Ta Li (Taipei Veterans General Hospital, Taiwan)
rTMS Antidepressant Effect on Brain Oscillations and Networks in Medication-resistant Depression: A Combined MEG, PET and rTMS Study
- P_043 Ataru Inagaki (Keio University Graduate School of Health Management, Japan)
Antidepressant Prescription Patterns in Japanese Private Mental Hospitals
- P_044 Youhei Tomita (Yoshida General Hospital, Japan)
ECT Treatment was Effective and Safe for Senile Vascular Depression: Two Cases Report
- P_045 Sung-Gon Kim (Pusan National University, Korea)
An Open Prospective Study of Ziprasidone in Schizophrenia Patients with Depressive Symptoms: Multi-center Study
- P_046 Dong Hoon Oh (Hanyang University, Korea)
Neuropathological Abnormalities of Astrocytes, GABAergic Neurons and Pyramidal Neurons in the Dorsolateral Prefrontal Cortices of Patients with Major Depressive Disorder
- P_047 Hee-Ju Kang (Chonnam National University, Korea)
Comparative Validity of Depression Assessment Scales for Screening Poststroke Depression
- P_048 Jong-Min Woo (Inje University, Korea)
Different Incidence of Serious Outcome of Depression According to Comorbid Diabetes Mellitus in Patients with Depressive Disorders
- P_049 Su-Jin Yang (Chonnam National University, Korea)
Antidepressants Treatment Outcomes in Major Depressive Disorder with Melancholic Features: The CRESCEND Study
- P_050 Jae-Min Kim (Chonnam National University, Korea)
Stress and Treatment Outcomes in Depressive Patients in Korea: The CRESCEND Study
- P_051 Su-Jin Yang (Chonnam National University, Korea)
Sex Differences in Antidepressant Treatment Outcomes in Korea: The CRESCEND Study
- P_052 Tae Young Kim (Yonsei University, Korea)
Reward Learning in Patients with Bipolar Disorder: Findings from a Probabilistic Reward Task
- P_053 Jae-Min Kim (Chonnam National University, Korea)
Early Improvement and Later Treatment Outcomes in Korean Patients with Depressive Disorders: The CRESCEND Study

- P_054 Hong Lee (Samsung Biomedical Research Institute, Korea)
The Relationship of Nonclinical Personality Trait to Treatment Outcome in Depressed Outpatients:
24 Weeks Longitudinal Study
- P_055 Jeong-Lan Kim (Chungnam National University, Korea)
Comparison of Anger between Hwa-Byung and Depressive Disorder in Korean Elderly
- P_056 Shigeru Morinobu (Hiroshima University, Japan)
Are the DNA Methylation Profiles within the CpG Island at the Promoter of Exon I of the Brain-derived
Neurotrophic Factor (BDNF) Gene a Potent Diagnostic Biomarker in Psychiatric Disorders?
- P_057 Hsien-Yuan Lane (China Medical University, Taiwan)
Glycine Transporter I Inhibitor, N-Methylglycine (Sarcosine) for Treatment of Depression
- P_058 Sung-Gon Kim (Pusan National University, Korea)
Time to Antidepressant Discontinuation in Major Depressive Disorder During a 24-Week Treatment
- P_059 Sung-Gon Kim (Pusan National University, Korea)
Correlation between Starting Dose of Escitalopram and its Treatment Efficacy
in Major Depressive Disorder
- P_060 Masaki Kato (Kansai Medical University, Japan)
Clinical Utility of Early Partial Improvement in Combination with Genetic Variants as a Predictor
of Treatment Outcome in Patients with Major Depressive Disorder - The Result of Two Pooled Rct -
- P_061 Keisuke Motomura (Kyushu University, Japan)
A Case of Recurrent Brief Depressive Disorder Successfully Treated with Aripiprazole
- P_062 Chi-Un Pae (The Catholic University of Korea, Korea)
A 6 Week Randomized Double-blind Placebo-controlled Trial of Ziprasidone
for the Acute Depressive Mixed State
- P_063 Jae-Min Kim (Chonnam National University, Korea)
Physical Comorbidity and Antidepressants Treatment Outcomes in Korean Patients
with Depressive Disorders: The CRESCEND Study
- P_064 Kyung-Yeol Bae (Chonnam National University, Korea)
Prescription of Antidepressants in Korea Results from the Nationwide Clinical Research Center
for Depression (CRESCEND) Study
- P_065 Sung-Wan Kim (Chonnam National University, Korea)
Suicidal Behavior and Antidepressant Treatment Outcomes in Korean Patients with Depression
- P_066 Jaehyun Kim (Wonkwang University, Korea)
Mirtazapine and Nightmare (Unpleasant Dream)
- P_067 Zhi Xu (Medical School of Southeast University, China)
Association of Glutamatergic and Gabaergic System Gene Polymorphisms
on Antidepressant Response

P_068 Zhi Xu (Medical School of Southeast University, China)
The Effect of Signal Transduction Pathway Genes and their Interaction with Environment Factors on Antidepressant Treatment Response

● ● Anxiety Disorders and Anxiolytics

- P_069 Daeyoung Roh (Yonsei University, Korea)
Development of a Computer Based Symmetry and Arrangement Symptoms Measures in Obsessive-compulsive Disorder
- P_070 Yukihiro Noda (Faculty of Pharmacy, Meijo University, Japan)
Social Defeat Stress During Juvenile Stage Impairs Social Behaviors Associated with Alteration of Brain Monoaminergic Functions in Mice
- P_071 Seung-Hwan Lee (Inje University, Korea)
The Source Imaging of P300 Auditory Evoked Potentials and Clinical Correlations in Patients with Posttraumatic Stress Disorder
- P_072 Mitsuhiro Yoshioka (Hokkaido University, Japan)
Parabolic Flights Activate the Serotonergic Synthetic Pathway in the Mouse Brain
- P_073 Hiroshi Nomura (The University of Tokyo, Japan)
Anxiolytic-like Behavior in Rats with Dentate Gyrus Lesions
- P_074 Ye Seul Shin (Seoul National University, Korea)
Switching Strategy Underlies Verbal Fluency Impairment in Obsessive-compulsive Disorder
- P_075 Young Shin Na (Seoul National University, Korea)
Impaired Body but Not Face Perception in Patients with Obsessive-compulsive Disorder
- P_076 Ho-Suk Suh (CHA University, Korea)
Medication Algorithm for Generalized Anxiety Disorder in Korea: Treatment Strategies for Initial Treatment, Long-term Treatment and Comorbid Conditions
- P_077 Osamu Takashio (Showa University School of Medicine, Japan)
An Analysis of Pharmacotherapy Combined Cognitive-behavioral Group Therapy for Panic Disorder with Agoraphobia
- P_078 Geumsook Shim (Seoul National University, Korea)
A Naturalistic Open-label Study of the Optimal Dose of Escitalopram for the Treatment of Obsessive-compulsive Disorder
- P_079 Min Soo Byun (Seoul National University, Korea)
Predictors of Poor Clinical Response to Escitalopram in Obsessive-compulsive Disorder
- P_080 Hye Youn Park (Seoul National University, Korea)
Psychosocial Deficits in Obsessive-compulsive Disorder and the Effect of Pharmacotherapy

● ● **Basic and Clinical Neuroscience**

- P_081 Jaesuk Yun (Nagoya University, Japan)
The Role of Npas4 in Neurite Outgrowth and phosphorylation of Synapsin I
- P_082 Soichiro Ide (Hokkaido University, Japan)
Involvement of Corticotropin-releasing Factor within the Dorsolateral Part of the Bed Nucleus of the Stria Terminalis in Pain-induced Aversion
- P_083 Koichi Kawada (Chiba Institute of Science, Japan)
Influence of Tunicamycin-induced Endoplasmic Reticulum Stress on the Regulation of Neuronal Differentiation
- P_084 Masahiro Segawa (Hiroshima University, Japan)
Electroconvulsive Seizure Induced Tissue-plasminogen Activator (t-PA) Expression in Rat Hippocampus
- P_085 Koichi Fujikawa (Kanazawa University, Japan)
Expression Profiles of the Osteoblastogenesis Regulator Runt Related Transcription Factor-2 in Murine Astrocytes
- P_086 Takaya Katsurayama (Kanazawa University, Japan)
Artificial Orchestration of Functional NMDAR Channels in HEK293 Cells
- P_087 Miki Kou (Kanazawa University, Japan)
Expression Profiles of Ifrd1 mRNA in Brains of Mice with Middle Cerebral Artery Occlusion
- P_088 Le Quynh Nguyen (Kanazawa University, Japan)
Possible Functional Expression of Clock Genes in Murine Astroglia
- P_089 Zhang Qi Ming (Kanazawa University, Japan)
Postnatal Expression Profiles of Different Markers in Brains of Mice Defective of GABABR1 Subunit
- P_090 Tatsuo Shiba (Setsunan University, Japan)
Involvement of Ca²⁺ Channels in Proliferation of Neural Stem/Progenitor Cells Derived from the Subventricular Zone of Adult Mice
- P_091 Shinn-Won Lim (Sungkyunkwan University, Korea)
Serum Pro-BDNF(Brain Derived Neurotrophic Factor) in Depressed Patients and Antidepressant Treatment
- P_092 Hiroko Kubo (Institute of Health Biosciences, University of Tokushima Graduate School, Japan)
Effects of Lithium on the Cognitive Function in Healthy Volunteers
- P_093 Tong Zhao (Chonbuk National University, Korea)
Effects of Chronic Social Defeat Stress on Behavior in Adult Mice

- P_094 **Guang Biao Huang** (Chonbuk National University, Korea)
Choline Acetyltransferase Expression in Rat Hippocampus and Prefrontal Cortex after Acute and Chronic Exposure to Haloperidol, Risperidone, and Amisulpride
- P_095 **Jin Young Park** (Yonsei University, Korea)
Coupling between Slow and Fast Oscillations on Working Memory Load
- P_096 **Hitoshi Hashimoto** (Graduate School of Pharmaceutical Sciences, Osaka University, Japan)
Psychiatric Implications of Pituitary Adenylate Cyclase-activating Polypeptide (PACAP)-Dependent Stress Responses
- P_097 **Kayo Akiyama** (University of Tsukuba, Japan)
The Role of Exercise on Dopaminergic Brain Functions
- P_098 **Jihye Choi** (The Catholic University of Korea, Korea)
Effects of Smoking Cessation on the Plasma Levels of Leptin, Ghrelin, Glucagon-like Peptide 1, and Nerve Growth Factor
- P_099 **Jin Young Park** (Yonsei University, Korea)
Korean Facial Expressions of Emotion (KOFEE): Development and Standardization
- P_100 **Seockhoon Chung** (University of Ulsan, Korea)
Adenosine A1 Receptor Agonists and Modafinil Reduce the Neurite Outgrowth in Cultured Cortical Neuron
- P_101 **Chieh-Hsin Lin** (Chang Gung University, Taiwan)
Synergistic Effects of COMT and TPH2 on Social Cognition

● ● Child and Adolescent Disorders

- P_102 **Atsushi Sato** (The University of Tokyo, Japan)
Autism-like Behaviors in Mouse Models of Tuberous Sclerosis Complex and their Recovery by Rapamycin
- P_103 **Yi Su** (Peking University, China)
Osmotically Released Methylphenidate and Atomoxetine for the Treatment of Attention Deficit Hyperactivity Disorder: Efficacy and Adherence
- P_104 **Heejong Tak** (University of Ulsan, Korea)
Rash in Psychiatric and Nonpsychiatric Adolescent Patients Receiving Lamotrigine in Korea: A Retrospective Cohort Study
- P_105 **Jangho Park** (University of Ulsan, Korea)
Case Series: Cardiovascular Effects of Methylphenidate and Atomoxetine in ADHD with Cardiac Abnormalities
- P_106 **Yukio Takamatsu** (Tokyo Metropolitan Institute of Medical Science, Japan)
Methylphenidate Enhances Motivation, Improves Learning and Increases Extracellular Dopamine in the Prefrontal Cortex in Mice Lacking Dopamine Transporter

● ● **Dementia and Neurological Disorders**

- P_107 Taku Yamaguchi (Nagasaki International University, Japan)
Liposome-encapsulated Hemoglobin Ameliorates Brain Dysfunction after Transient Cerebral Ischemia in Rats
- P_108 Kotaro Takasaki (Fukuoka University, Japan)
Neuroprotective Effects of CDP-choline on Impaired Spatial Memory in a Rat Model of Cerebrovascular Dementia
- P_109 So Yeon Kim (Sungkyunkwan University, Korea)
Alteration of E2F and pRb protien in lymphocyte of Patients with Alzheimer's Disease
- P_110 Seung-Hwan Lee (Inje University, Korea)
Clinical Implication of qEEG and Current Source Density in Patients with Alzheimer's Disease
- P_111 Hyoshin Kang (Sungkyunkwan University, Korea)
Comparative Assessment of Clinical Efficacy between the Naive and the Switching Group to Donepezil: 12 Months Prospective Study
- P_112 Jun Bae Choi (Sungkyunkwan University, Korea)
Association between Activities of Daily Living, Neuropsychiatric Symptoms and Extrapyrmidal Signs in Alzheimer Disease
- P_113 Jihye Song (Sungkyunkwan University, Korea)
Response to Galantamine Administration in Patients with Alzheimer's Disease; Exploring Subdomains of Cognitive Function
- P_114 Sang Joon Son (Yonsei University, Korea)
Anemia Associated with Executive Function in Mild Cognitive Impairment with Severe White Matter Hyperintensities
- P_115 Sang Joon Son (Yonsei University, Korea)
Heavy Alcohol Consumption (AC) Associated with Cognitive Impairment in the Community-dwelling Elderly with Larger Head Circumference (HC)
- P_116 Mi Hee Shin (Pusan National University, Korea)
Combining the Korean Version of the Mini-mental State Examination and Korean Dementia Screening Questionnaire is the Better Screening Tools for Dementia in the Elderly
- P_117 Hyoshin Kang (Sungkyunkwan University, Korea)
Comparative Assessment of Clinical Efficacy after 12-Month Clinical Trial of Donepezil between the Patients with Pure Alzheimer's Disease and Mixed Dementia
- P_118 Ai Nogami (Fukuoka University, Japan)
Effect of Toki, a Component of Yokukansan, on Memory Disturbance in Animal Model of Cerebrovascular Dementia

● ● Genetics

- P_119 Kazutaka Ohi (Osaka University, Japan)
Variants of the RELA Gene are Associated with Schizophrenia and their Startle Responses
- P_120 Kazuo Yamada (RIKEN, Brain Science Institute, Japan)
Genetic Association Study of Multiple GABA-related Genes with Schizophrenia
- P_121 Daisuke Nishizawa (Tokyo Metropolitan Institute of Medical Science, Japan)
Association Analysis between GIRK2 Gene Polymorphisms and Opioid Sensitivity
- P_122 Shinn-Won Lim (Sungkyunkwan University, Korea)
Triallelic Polymorphism in 5-HT Transporter Linked Polymorphism Region and Remission after Selective Serotonin Reuptake Inhibitor Treatment
- P_123 Ryota Hashimoto (Osaka University, Japan)
The KCNH2 Gene is Associated with Neurocognition and the Risk of Schizophrenia
- P_124 Yasuhisa Fukuo (Fujita Health University, Japan)
Possible Association between Ubiquitin-specific Peptidase 46 Gene and Major Depressive Disorders in the Japanese Population
- P_125 Toshiyuki Himichi (Kyoto University, Japan)
COMT Val 158 Met Gene Polymorphism Influences the Perception of Other's Pain
- P_126 Woojae Myung (Sungkyunkwan University, Korea)
Genetic Association Study of Individual Symptoms in Depression
- P_127 Sung-Il Woo (Soonchunhyang University, Korea)
Genetic Association Analysis of the ERBB4 Polymorphisms with the Risk of Schizophrenia in a Korean Population
- P_128 Daimei Sasayama (National Institute of Neuroscience, National Center of Neurology and Psychiatry, Japan)
Association of Plasma IL-6 and Soluble IL-6 Receptor Levels with the Asp358Ala Polymorphism of the IL-6 Receptor Gene in Schizophrenic Patients
- P_129 Xiaofeng Hu (Peking University, China)
Association Study of DRD3 Gene Ser9Gly Polymorphism with the Therapeutic Effects of Two Antipsychotics
- P_130 Su Jin Shin (Soonchunhyang University, Korea)
No Association of One Single Nucleotide Polymorphism (rs12416489) on Exon 9 of Neuregulin 3 Gene with Schizophrenia in a Korean Population
- P_131 Fang Wang (Peking University, China)
Lack of Association between FTO Polymorphism and Anti-psychotics Induced Weight Gain in a Chinese Han Population

- P_132 Jae-Min Kim (Chonnam National University, Korea)
Physical Health and Incident Late-life Depression: Modification by Genes Affecting Cytokine Function
- P_133 Jaehwa Kim (The Catholic University of Korea, Korea)
Comparison of Gene Expression between Success and Failure in Smoking Cessation
- P_134 Jae-Min Kim (Chonnam National University, Korea)
Associations of Cytokine Gene Polymorphisms with Post-stroke Depression
- P_135 Sung-Wan Kim (Chonnam National University, Korea)
Hopeful Attitude, Cellular Immunity, and Depression in Patients with Breast Cancer
- P_136 Jae-Min Kim (Chonnam National University, Korea)
Serotonergic Genes as Risks for Pathological Laughing and Crying after Stroke
- P_137 Jae-Min Kim (Chonnam National University, Korea)
A Genetic Association Study (Serotonin and BDNF Genes) of Poststroke Depression
- P_138 Jae-Min Kim (Chonnam National University, Korea)
BDNF Val66met Polymorphism and Depression in Breast Cancer Patients.
A One Year Longitudinal Study
- P_139 Yujin Lee (Sungkyunkwan University, Korea)
Association between the BDNF Val66Met Polymorphism and the Course of Depression
- P_140 Borah Kim (CHA University, Korea)
Association among Serotonin Transporter Gene (SLC6A4) Promoter Polymorphism (5-HTTLPR),
Early Life Parental Death and Anxiety Sensitivity of Panic Disorder: Preliminary Study
- P_141 Borah Kim (CHA University, Korea)
Panic Disorder and Catechol-O-Methyltransferase (COMT) Val158Met Genotype:
Association and Interaction with Environmental Stress
- P_142 Min Kwon (The Catholic University of Korea, Korea)
Development of Multi-dimensional Evaluation Scale of Nicotine Dependence and
Genetic Polymorphism of Nicotine Dependence in Korean Population
- P_143 Jee In Kang (National Health Insurance Corp. Ilsan Hospital, Korea)
Association of a HTR2A Gene Polymorphism with Disgust Sensitivity in Healthy Volunteers
- P_144 Jee In Kang (National Health Insurance Corp. Ilsan Hospital, Korea)
Genetic Influence of COMT and BDNF Polymorphisms on Resilience in Healthy College Students
- P_145 Shi Hyun Kang (Seoul National Hospital, Korea)
Association between LEPR Q223R and Dyslipidemia in Patients with Schizophrenia Taking Clozapine

● ● Neuroimaging

- P_146 Chun-Lung Lin (Taoyuan Armed Forces General Hospital, Taiwan)
Observational Study to Investigate Serotonin Transporter on Impulsivity Aggression between Health Volunteer and Bipolar Spectrum Disorder by 123I-ADAM Spect Imaging
- P_147 Kai-Chun Yang (Taipei Veterans General Hospital Yuanshan Branch, Taiwan)
Relationship between Cerebral Morphology and Striatal Dopamine Transporter Binding in Humans
- P_148 Tatsuya Nagai (University of Tokyo, Japan)
Mismatch Negativity in At-Risk Mental State Patients and First-episode Schizophrenia Patients
- P_149 Geumsook Shim (Seoul National University, Korea)
Functional Magnetic Resonance Imaging During Planning before and after Escitalopram Treatment in Obsessive-compulsive Disorder
- P_152 Jung Suk Lee (Bundang Jesaeng General Hospital, Korea)
Hippocampus and Nucleus Accumbens Activity During Neutral Word Recognition Related to Trait Physical Anhedonia in Patients with Schizophrenia: An fMRI Study
- P_153 Yoshihiko Demoto (Hiroshima University, Japan)
Effects of Acute Tryptophan Depletion on Brain Activation During Future Reward Evaluation
- P_154 Qinling Wei (SUN Yat-sen University, China)
Association of the ZNF804A Gene Polymorphism rs1344706 with White Matter Integrity Changes in Schizophrenia
- P_155 Bumseok Jeong (KAIST Medical Center, Korea Advanced Institute of Science and Technology, Korea)
Functional Connectivity of Default Mode Network in Schizophrenia
- P_156 Tu Pei-Chi (Taipei Veterans General Hospital, Taiwan)
Cortico-striatal Disconnection within the Cingulo-opercular Network in Schizophrenia Revealed by Intrinsic Functional Connectivity Analysis: A Resting fMRI Study
- P_157 Seon-Koo Lee (National Health Insurance Corp. Ilsan Hospital, Korea)
Deficit of Integrative Emotional Processing in Patient with Schizophrenia: An fMRI Study
- P_158 Je-Yeon Yun (Seoul National University, Korea)
Executive Dysfunction and Resting State Functional Connectivity Alteration in Obsessive-compulsive Disorder
- P_159 Jaehwa Kim (The Catholic University of Korea, Korea)
In vivo Evidence for Long-term CNS Toxicity Associated with Chronic Binge Use of Methamphetamine
- P_160 Young-Heon Song (Chonnam National University, Korea)
Comparison of Size of Corpus Callosum in Patients with Mild Cognitive Impairment and Alzheimer's Disease

- P_161 **Wi Hoon Jung** (Seoul National University, Korea)
Regional Brain Atrophy and Functional Disconnection in Broca's Area
in Ultra-high Risk and Schizophrenia
- P_162 **Sung Nyun Kim** (Seoul National University, Korea)
Neural Correlates of Impaired Response Inhibition in Patients with Obsessive-compulsive
Disorder before and after Treatment
- P_163 **Won-Jung Choi** (Yonsei University, Korea)
Relationship of White Matter Abnormalities with the Score of the Revised Delirium Rating Scale
in Delirious Patients
- P_164 **Jee In Kang** (National Health Insurance Corp. Ilsan Hospital, Korea)
Reduced Binding of GABA-A/benzodiazepine Receptor in Individuals at Ultra-high Risk for Psychosis:
An [18F]-Fluoroflumazenil PET Study
- P_165 **Jung In Son** (University of Ulsan, Korea)
Structural Brain Abnormality Related to the Past Drinking Habits in Patients
with Alzheimer's Dementia

● ● Neuropsychopharmacology

- P_166 **Toshitaka Nabeshima** (Meijo University, Japan)
Pubertal Interaction of Mutant DISC1 and Psychological Stress Produces Aetiopathology
of Psychiatric Disorders
- P_167 **Hidehiro Oshibuchi** (Tokyo Women's Medical University, Japan)
Valproate Treatment While Acquisition of Fear Conditioning Shows No Significant Effect
on Basolateral Amygdala Dopamine Response by Re-exposure to the Conditioned Fear Stress
- P_168 **Yosuke Fujita** (Hiroshima University, Japan)
Vorinostat, a Histone Deacetylase Inhibitor, Facilitates Fear Extinction by Enhancing the Gene
Expression of Hippocampal NR2B-Containing Nmda Receptor
- P_169 **Jangho Park** (University of Ulsan, Korea)
Haloperidol and Clozapine Block the Formation of Autophagolysosomes in Cultured Cortical Neuron
- P_170 **Takeshi Takarada** (Kanazawa University Graduate School of Natural Science and Technology, Japan)
Possible Regulation of Adult Neurogenesis by Myosin VI Responsive to Traumatic Stress
in Murine Hippocampus
- P_171 **Takashi Watanabe** (Dokkyo Medical University, Japan)
Pharmacokinetic and Pharmacogenetic Analysis of Therapeutic Response of Japanese Patients
with Panic Disorder Treated with Paroxetine

- P_172 Takenao Koseki (Meijo University, Japan)
Enriched Environment in Adolescent Prevents Abnormal Behavior Associated with Histone Deacetylation in Phencyclidine-treated Mice
- P_173 Tadashi Saigusa (Nihon University School of Dentistry, Japan)
The Alpha-1 Adrenoceptor in the Nucleus Accumbens Exerts an Inhibitory Control upon the Accumbal Noradrenaline and Dopamine Efflux in Freely Moving Rats
- P_174 Atsumi Nitta (University of Toyama, Japan)
Over Expression of Piccolo C2A Domain Induces Depression-like Behavior in Mice
- P_175 Eriko Saika (University of Toyama, Japan)
Role of a Novel Molecule "Shati" in Animal Model of Dystonia
- P_176 Kenichi Osada (St. Marianna University, Japan)
The Investigation to the Substrate of P- Glycoprotein for Blonanserin
- P_177 Toshiaki Haga (St Marianna University, Japan)
Milnacipran was a Substrate for P-Glycoprotein in the Hippocampal Neuronal in vitro System of HT22 Cells
- P_178 Masao Abe (Ehime University Graduate School of Medicine, Japan)
Different Actions for 21- Day Administration of Mirtazapine on Serotonergic Transmission Associated with Raphe Nuclei and their Innervation Cortical Regions
- P_179 Noriyuki Iegaki (University of Toyama, Japan)
Overexpressions of "Shati" in the Dorsal Striatum or Nucleus Accumbens Affect Emotional Behaviors in Mice
- P_180 Yurie Matsumoto (Nagoya University, Japan)
Vulnerability to Rearing Environmental Changes in Early Life Plays a Crucial Role in the Aetiopathology of Psychiatric Disorders
- P_181 Kanako Takayama (University of Toyama, Japan)
Expression of TMEM168, a Multi-pass Membrane Protein, is Induced in the Nucleus Accumbens by Methamphetamine Treatment in Mice
- P_182 Akihiro Mouri (Meijo University, Japan)
Mouse Strain Differences in Phencyclidine-induced Behavioral Changes
- P_183 Hideko Yamamoto (Tokyo Metropolitan Institute of Medical Science, Japan)
Phencyclidine-induced Motor Impairment: Role of the GluN2D Subunit of the N-methyl-D-Aspartate Receptor
- P_184 Kimihiko Watanabe (Sapporo Medical University, Japan)
Serum BDNF as a Potential Biomarker for Fetal Alcohol Effects
- P_185 Cheol-Soon Lee (Gyeongsang National University, Korea)
Proteomic Profiling of the Effect of the Antidepressant Fluoxetine in HEK293A-TREK-2 Cells

- P_186 Jong-Woo Paik (Kyung-Hee University, Korea)
Construction of Clinical Trial Database for Psychotropic Drug in Korea
- P_187 Suk-Hoon Kang (Seoul National University, Korea)
Changes of Cholesterol Level and Impulsiveness after Pharmacologic Treatments in Patients with Bipolar Disorder
- P_188 Mi Kyoung Seo (Inje University, Korea)
A Common Mechanism of Antidepressants Action in Human Neuroblastoma SH-SY5Y Cells
- P_189 Chan Hong Lee (Paik Institute for Clinical Research, Korea)
Effects of Antipsychotic Drugs on Synaptic Protein in Rats Hippocampus with Immobilization Stress
- P_190 Chan Hong Lee (Paik Institute for Clinical Research, Korea)
Effects of Antipsychotic Drugs on BDNF, GSK-3 β , and β -catenin Expression in Rats with Immobilization Stress
- P_191 Hye Yeon Cho (Paik Institute for Clinical Research, Korea)
Atypical Antipsychotic Drugs Increase Neurite Outgrowth in Rat Hippocampal Cells via PI3K Pathway
- P_192 Jian-Jun Ou (Central South University, China)
The Effects of Clozapine and Olanzapine on Food Intake, Weight Gain and Glucose Transporter 4 Gene Expression in Skeletal Muscle of Rats
- P_193 Chan Hong Lee (Paik Institute for Clinical Research, Korea)
Effects of Antipsychotic Drugs on Expression of Synaptic Proteins in Rats Prefrontal Cortex with Immobilization Stress
- P_194 Chan Hong Lee (Paik Institute for Clinical Research, Korea)
Effects of Antidepressants on Expression of Synaptic Proteins in Hippocampal Neuronal Cultures
- P_195 Hye Yeon Cho (Paik Institute for Clinical Research, Korea)
Mechanisms of Antidepressant Drugs on Neurite Outgrowth in Rat Hippocampal Cells
- P_196 Chan Hong Lee (Paik Institute for Clinical Research, Korea)
Effects of Antipsychotic Drugs on Expression of Synaptic Proteins in Hippocampal Neuronal Cultures
- P_197 Hiroshi Kunugi (National Center of Neurology and Psychiatry, Japan)
Efficacy of a Dopamine Receptor Agonist, Pramipexole, in Treatment Resistant Depression: An Open Study
- P_198 Su Yeon Kim (Sungkyunkwan University, Korea)
Comparison of Serum Brain-derived Neurotrophic Factor Levels between Depression Patients and Normal Subjects
- P_199 Daeyoung Roh (Yonsei University, Korea)
Antipsychotic Polypharmacy in Schizophrenic Inpatients at a University Psychiatric Hospital in Korea: A Comparison of 2005 and 2010

- P_200 Kayo Akiyama (University of Tsukuba, Japan)
The Role of Music on Dopaminergic Brain Functions
- P_201 In-Won Chung (Dongguk University, Korea)
A Case of Lithium Toxicity in a Patient Treated with Maintenance Dose of Lithium
- P_202 Masafumi Shimada (Tohoku University, Japan)
Additive Suppressive Effects of δ -opioid Agonist KNT-127 Pretreatment and μ -opioid Receptor Deletion on Responses to Forced Swim Stress
- P_203 Makiko Yamada (Kurume University, Japan)
Dorsal Raphe Nucleus Serotonin Neurons in WKY Rats Demonstrates Subresponsivity to an Acute Application of Escitalopram: Effect of Repeated Escitalopram Treatment
- P_204 Hwang Bin Lee (Seoul National Hospital, Korea)
The Effect of Ziprasidone Augmentation of Clozapine in Refractory Schizophrenia
- P_205 Sunny Lee (Seoul Metropolitan Eunpyeong Hospital, Korea)
Changes of Appetite and Eating Behavior in Bipolar Disorder Patients Measurement with General-food Craving Questionnaire-traits and the Drug-related Eating Behavior Questionnaire
- P_206 Jhing Goo Chang (Yonsei University, Korea)
Medication Prescribing Pattern for Inpatients with Schizophrenia and Related psychosis in a University Psychiatric Hospital

● ● Psychotic Disorders and Antipsychotics

- P_207 Hitoshi Ueda (Morioka Cocoro Clinic, Japan)
Clinical Evaluation and Patients' and their Family's Subjective Evaluation of Risperidone Long Acting Injectable (RLAI) in Treatment of Clinic Outpatients
- P_208 Won-Myong Bahk (The Catholic University of Korea, Korea)
The Changes of WBC, Platelet Counts after Administrations of Olanzapine, Quetiapine, Risperidone, Aripiprazole in Schizophrenic Patients
- P_209 Won-Myong Bahk (The Catholic University of Korea, Korea)
A Naturalistic Study on the Drug Use Trend among Inpatients with Schizophrenia in a Hospital
- P_210 Seunghyong Ryu (Sungkyunkwan University, Korea)
Symptom Structures of Atypical Antipsychotics-induced Obsessive Compulsive Symptoms in Schizophrenia Patients
- P_211 Yoko Hibi (Nagoya University, Japan)
Stress Reduces the Expression of Transcription Factor, Neuronal PAS Domain 4 (NPAS4)
- P_212 Yuki Kita (Osaka University, Japan)
Lithium Modulates Methamphetamine-induced Behaviors: Role of Prefrontal Monoaminergic Neurotransmission in Mice

- P_213 Kentaro Kawabe (Horie Hospital, Japan)
Efficacy and Safety of Blonanserin Monotherapy in Patients with Chronic Schizophrenia:
Result of 52-Week Study
- P_214 Yuka Kikuchi (Akita University, Japan)
Progress Report of Japanese Patient with Schizophrenia Treated with Clozapine
- P_215 Yoshiteru Takekita (Kansai Medical University, Japan)
A Open-label, Randomized Comparative Study of Perospirone and Aripiprazole
in Japanese Schizophrenia Patients
- P_216 Junya Fujino (Asakayama General Hospital, Japan)
QTc Prolongation in Schizophrenic Patients Receiving Antipsychotics
- P_217 Takahira Yamauchi (Nara Medical University, Japan)
Olanzapine Increases Cell Mitotic Activity and Oligodendrocyte-lineage Cells in the Hypothalamus
- P_218 Toshifumi Kishimoto (Nara Medical University, Japan)
Olanzapine Stimulates Proliferation but Inhibits Differentiation in Rat Oligodendrocyte
Precursor Cell Cultures
- P_219 Jen-Chin Lee (Taoyuan Psychiatric Center, Department of Health, Taiwan)
The Characteristics of Schizophrenic Patients with Metabolic Syndrome in a Mental Hospital
- P_220 Shinichiro Ochi (Ehime University Graduate School of Medicine, Japan)
Switching to Aripiprazole Monotherapy from Antipsychotic Polypharmacy
in Chronic Schizophrenia In-patients
- P_221 Keun-Young Oh (Chonbuk National University, Korea)
Efficacy and Safety of Aripiprazole in Patients with First Episode Psychosis:
An Open-label, Prospective Multi-center Study
- P_222 Xiaofeng Guo (Central South University, China)
Effects of Antipsychotic Medications on Quality of Life and Psychosocial Functioning in Patients with
Early-stage Schizophrenia: 1 Year Follow-up Naturalistic Study
- P_223 Ya-Min Li (Central South University, China)
Efficacy and Tolerability of Ziprasidone Versus Olanzapine in First-episode Schizophrenia: A
6-Week, Randomized, Open-label, Flexible-dose Study
- P_224 Maosheng Fang (Tongji Medical College of Huazhong University of Science and Technology, China)
Comparison of Risperidone Oral Solution (RIS-OS) and Intramuscular Haloperidol with the Latter
Shifting to Oral Therapy for the Treatment of Acute Agitation in Patients with Schizophrenia
- P_225 Masatsugu Moriwaki (Fujita Health University, Japan)
Effect of Aripiprazole, Risperidone, and Olanzapine on the Acoustic Startle Response
in Japanese Chronic Schizophrenia

- P_226 Namin Kang (Chonbuk National University, Korea)
Early Pharmacologic Intervention in Individuals at Ultra-high Risk for Psychosis: Results from 1-Year Follow Up Study in Korea
- P_227 Shiho Miyazawa (Tohoku University, Japan)
Does Neuropsychological Performance Predict Social Function in Patients with Schizophrenia?: Evaluation with the MATRICS-CCB Japanese Version
- P_228 Hirotake Hida (Faculty of Pharmacy Meijo University, Japan)
Combination of a Neonatal Viral Infection with an Adolescent Substance Use Affect Psychological Function in Adult
- P_229 Yoichiro Otake (Fujita Health University, Japan)
Investigation of Clinical Factors Influencing Cognitive Function in Japanese Schizophrenia
- P_230 Jieun Lee (CHA University, Korea)
The Tolerability of Mirtazapine Augmentation in Schizophrenic Patients Treated with Risperidone: A Preliminary Randomized Placebo-controlled Trial
- P_231 Tomo Okochi (Fujita Health University, Japan)
Clinical Effectiveness and Safety of Treatment with Paliperidone in Acute Japanese Schizophrenia
- P_232 Kenji Maeda (Otsuka Pharmaceutical Co Ltd, Japan)
Preclinical Pharmacology of Brexpiprazole (OPC-34712): A Novel Compound with Dopamine D2 Receptor Partial Agonist Activity
- P_233 Tae Young Lee (Seoul National University, Korea)
The Characteristics of People at Ultra High-risk for Psychosis on the Personality, Temperament, and Relationship Style with the Effect of 6-Month Pharmacotherapy
- P_235 Keun-Young Oh (Chonbuk National University, Korea)
Efficacy and Safety of Paliperidone ER in Patients with First Episode Psychosis: An Open-label, Prospective Multi-center Study
- P_236 Kotaro Hattori (National Institute of Neuroscience, National Center of Neurology and Psychiatry, Japan)
Analyses of Monoamine Metabolites in the Cerebrospinal Fluid of Patients with Schizophrenia and Depression
- P_237 Yuichiro Tsutsumi (Ongata Hospital, Japan)
Effectiveness of Blonanserin (BNS) in 70 In-patients with Acute Phase Schizophrenia
- P_238 Sung-Wan Kim (Chonnam National University, Korea)
A Survey on Attitudes of Korean Psychiatrists Toward Long-acting Injectable Antipsychotics: An Interim Analysis
- P_239 Sung-Wan Kim (Chonnam National University, Korea)
Effectiveness of Switching from Aripiprazole to Ziprasidone in Patients with Schizophrenia

- P_240 Jung Goo Lee (Inje University, Korea)
Effects of Weight Management Program and Factors Related to Weight Loss in Patients with Schizophrenia or Schizoaffective Disorder
- P_241 Joon Hwan Jang (Seoul National University, Korea)
Longitudinal Patterns of Social Functioning and Conversion to Psychosis in Subjects at Ultra-high Risk
- P_242 Bong Ju Lee (Inje University, Korea)
Effectiveness of Switching to Aripiprazole for Cognitive Symptoms and Hyperprolactinemia in Schizophrenia Treated with Risperidone
- P_243 Kee-Chan Ahn (University of British Columbia (UBC), Canada)
Effects of a Potentially New Antipsychotic, dl-Govadine on the Spontaneous Pacemaker Firing of Midbrain Dopaminergic Neurons
- P_244 Jaehyun Yoo (Sungkyunkwan University, Korea)
Tardive Movement Symptoms Associated with Atypical Antipsychotics
- P_245 Naohisa Tsujino (Toho University, Japan)
Efficacy and Tolerability of Perospirone for At-risk Mental State. - Comparison with Aripiprazole -
- P_246 Imhong Jeon (Yonsei University, Korea)
Deficits of the Facial Emotion Recognition and Biased to Threatening Emotion in Ambiguous Facial Expression in Patients with Schizophrenia
- P_247 Maorong Hu (Central South University, China)
Comparison of Memory Function in First-episode Schizophrenia Patients before and after Treatment of Risperidone
- P_248 Tae-Yeong Jeong (Inje University, Korea)
Change of Leptin, Lipid Levels, Fasting Glucose, Body Weight, Body Mass Index (BMI), PANSS Score after 8 Weeks Later from Taking Paliperidone by Patient with Schizophrenia
- P_249 Un Jung Cho (University of Ulsan, Korea)
Development of the Questionnaire for Early Detection of Relapse in Schizophrenia
- P_250 Yun Young Song (Yonsei University, Korea)
Impaired Quality of Life in Schizophrenia
- P_251 Kyungun Jhung (Yonsei University, Korea)
Small-World Networks in Ultra-high Risk for Psychosis and First-episode Schizophrenia
- P_252 Hye Yoon Park (Yonsei University, Korea)
Self-referential Bias of Negative Personality Adjectives in Schizophrenia Patients
- P_253 Xiangrong Zhang (Southeast University, China)
The Effect of Chronic Antipsychotic Drug Administration on Hypothalamic Expression of nNOS and DRD2 in the Male Rat

● ● Psychoimmunoendocrinology

- P_254 Sheng Chun Yang (National Chen Kung University, Taiwan)
BDNF and Cytokines Change in Different Mood States of Bipolar II Disorder
- P_255 Ayako Ohashi (Kyushu University, Japan)
Prolonged Activation of Microglia in Specific Brain Regions Induced by Systemic Lipopolysaccharide Administration in Mice
- P_256 Ji Hye Choi (The Catholic University of Korea, Korea)
The Effect of Chronic Ethanol Intake on OLET/LETO Rats
- P_257 Jaehwa Kim (The Catholic University of Korea, Korea)
The Role of Ghrelin and Leptin on the Development of Type 2 Diabetes Mellitus in Alcohol Dependence Patients
- P_258 Jaehwa Kim (The Catholic University of Korea, Korea)
The Difference of Plasma Brain-derived Neurotrophic Factor Levels by the Development of Diabetes Mellitus in the Patients with Alcohol Dependence
- P_259 Seon-Young Kim (Chonnam National University, Korea)
Plasma Cytokine Levels and Risk of Depression in Breast Cancer
- P_260 Chul-Eung Kim (Inha University, Korea)
The Relationship between Inflammation and the Metabolic Syndrome During Paliperidone Extended-release Treatment in Schizophrenia

● ● Women's Mental Health

- P_261 Huang-Li Lin (Chang-Gung University, Taiwan)
Premenstrual Exacerbation in Taiwanese Women with Major Depressive Disorder
- P_262 Akiko Jogamoto (Ehime University Graduate School of Medicine, Japan)
Type of Stress Coping Behavior and the Severity of Tiredness in Healthcare Professionals
- P_263 Reiko Taketani (Kwansei Gakuin University, Japan)
Efficacy of Traditional Japanese Medicines (Kampo) for Depressive States in Women

● ● Others

- P_264 Jae Yeon Hwang (Seoul National University, Korea)
Multidimensional Comparison on Personality of the Big Five Model, Impulsiveness and Affect between Pathological Gambling and Obsessive-compulsive Disorder
- P_265 Sung-Hyouk Park (Chookryoung Evangelical, Korea)
Alexithymia and the Recognition of Facial Emotion in Schizophrenia Patients

- P_266 Jung In Son (University of Ulsan, Korea)
Diversity of Diagnosis in the First Episode Psychosis in AMC Psychiatric Department
- P_267 Ah-Young Choe (CHA University, Korea)
Understanding the Relations among Increasing BMI, Body Dissatisfaction, and Depression in Early Adolescence
- P_268 Jisun Yun (Yonsei University, Korea)
Development Self-face Recognition Test
- P_269 Wakako Nakano (University of Occupational and Environmental Health, Japan)
Changes in Recent 10 Years in Antipsychotic Pharmacotherapy for Inpatients with Schizophrenia in East Asia -- Results from Research on East Asia Psychotropic Prescription Pattern (REAP)
- P_270 Yuji Ozeki (Dokkyo Medical University, Japan)
QTc Interval in Drug Naïve Schizophrenic Patients
- P_271 Shunji Matsuki (Kyushu Clinical Pharmacology Research Clinic, Japan)
How Should We Evaluate the Tolerability of Higher-dose Psychotropic Agents Given to Healthy Subjects in Bioequivalence Trials?
- P_272 Yu-Wen Chiu (Chang Gung Memorial Hospital, Taiwan)
Complaint of Insomnia as a Predictor of Aging Symptoms in Males at a Men's Health Clinic
- P_273 Takeo Tominaga (The University of Tokushima, Japan)
Seven Year-acute and Maintenance Modified Electroconvulsive Therapy for an Elderly Patient with Catatonia
- P_274 Chan Hong Lee (Inje University, Korea)
Differential Effects of Acute, Subchronic and Chronic Immobilization Stress on Synaptic Proteins Levels in Rat Hippocampus
- P_275 Changsu Han (Korea University, Korea)
Survey on Clinical Research Participation of Community Living Elderly
- P_276 Sung-Wan Kim (Chonnam National University, Korea)
Risperidone Versus Olanzapine for the Treatment of Delirium
- P_277 Ji-Eun Jang (Chonnam National University, Korea)
Association between Severity of Delirium and Mortality in Patients with Cancer
- P_278 Sang-Shin Lee (Kosin University, Korea)
The Efficacy of Ondansetron in Diarrhea-predominant Irritable Bowel Syndrome: A Case Report
- P_279 Jae Min Kim (Yonsei University, Korea)
Relevance for Anti-depressive Effect of Repetitive Transcranial Magnetic Stimulation and Changes of Functional Connectivity after rTMS in Depression

New Research (Oral Presentation) Award

- ● Soo-Hee Choi (Yonsei University, Korea)
Neural Network Functional Connectivity During an Episode of Delirium
- ● Jong-Hoon Kim (Gachon University, Korea)
Effects of Age on Dopamine D2/3 Receptor Availability in Striatal Subdivisions:
A High-Resolution Positron Emission Tomography Study
- ● Youl-Ri Kim (Inje University, Korea)
Medical Findings in Korean Patients with Eating Disorders
- ● Mamiko Koshiba (Tokyo University of Agriculture and Technology, Japan)
Multi-parametric Correlation Analysis of Behavioral and Biophysical Signals in Animal Models Can Be
Applicable to Diagnosis of Socio-emotional Development and QOL Improvement over All Generation
- ● Hsiao-Lun Ku (Taipei Veterans General Hospital, Taiwan)
Dynamic Associations between Neuroimage Findings and Emotional Changes One Week and
One Month after Ischemic Stroke
- ● Daeyoung Roh (Yonsei University, Korea)
Two-year Follow-up of Deep Brain Stimulation for Refractory Obsessive-compulsive Disorder
- ● Atsushi Sato (The University of Tokyo, Japan)
Autism-like Behaviors in Mouse Models of Tuberous Sclerosis Complex and Their Recovery by Rapamycin
- ● Kyung Soon Shin (Seoul National University, Korea)
Neuromagnetic Evidence of Abnormal Auditory Evoked Response and Its Relation to Cortical Thickness
in Ultra-High-Risk for Psychosis and Patients with Schizophrenia
- ● Reiji Yoshimura (University of Occupational and Environmental Health, Japan)
No Association between Responses to the Addition of an Atypical Antipsychotic Drug to a SSRI or SNRI and
BDNF (Val66Met) Polymorphism in Refractory Major Depressive Disorder in Japanese Patients

Young Investigator Fellowship Award

- ● Agus Japari (Hasanuddin University, Indonesia)
Comparison of Venlafaxine and Amitryptiline to the Degree Depression, Blood Pressure and Sexual Dysfunction in Depressed Patient
- ● Akihiro Mouri (Meijo University, Japan)
Mouse Strain Differences in Phencyclidine-induced Behavioral Changes
- ● Atsushi Sato (The University of Tokyo, Japan)
Autism-like Behaviors in Mouse Models of Tuberous Sclerosis Complex and their Recovery by Rapamycin
- ● Borah Kim (CHA University, Korea)
Association Among Serotonin Transporter Gene (SLC6A4) Promoter Polymorphism (5-HTTLPR), Early Life Parental Death and Anxiety Sensitivity of Panic Disorder: Preliminary Study
- ● Daeyoung Roh (Yonsei University, Korea)
Development of a Computer Based Symmetry and Arrangement Symptoms Measures in Obsessive-compulsive Disorder
- ● Daisuke Nishizawa (Tokyo Metropolitan Institute of Medical Science, Japan)
Association Analysis between GIRK2 Gene Polymorphisms and Opioid Sensitivity
- ● Dong Hoon Oh (Hanyang University, Korea)
Neuropathological Abnormalities of Astrocytes, Gabaergic Neurons and Pyramidal Neurons in the Dorsolateral Prefrontal Cortices of Patients with Major Depressive Disorder
- ● Fang Wang (Peking University, China)
Lack of Association between FTO Polymorphism and Anti-psychotics Induced Weight Gain in a Chinese Han Population
- ● Hiroshi Nomura (The University of Tokyo, Japan)
Anxiolytic-like Behavior in Rats with Dentate Gyrus Lesions
- ● Je-Yeon Yun (Seoul National University, Korea)
Executive Dysfunction and Resting State Functional Connectivity Alteration in Obsessive-compulsive Disorder
- ● Jian-Jun Ou (Central South University, China)
The Effects of Clozapine and Olanzapine on Food Intake, Weight Gain and Glucose Transporter 4 Gene Expression in Skeletal Muscle of Rats
- ● Jin Young Park (Yonsei University, Korea)
Coupling between Slow and Fast Oscillations on Working Memory Load
- ● Qinling Wei (SUN Yat-sen University, China)
Association of the ZNF804A Gene Polymorphism rs1344706 with White Matter Integrity Changes in Schizophrenia
- ● Kai-Chun Yang (Taipei Veterans General Hospital Yuanshan Branch, Taiwan)
Relationship between Cerebral Morphology and Striatal Dopamine Transporter Binding in Humans
- ● Kazutaka Ohi (Osaka University, Japan)
Variants of the Rela Gene are Associated with Schizophrenia and their Startle Responses

- ● Kimihiko Watanabe (Sapporo Medical University, Japan)
Serum BDNF as a Potential Biomarker for Fetal Alcohol Effects
- ● Kyungun Jhung (Yonsei University, Korea)
Small-world Networks in Ultra-high Risk for Psychosis and First-episode Schizophrenia
- ● Maorong Hu (Central South University, China)
Comparison of Memory Function in First-episode Schizophrenia Patients before and after Treatment of Risperidone
- ● Maosheng Fang (Mental Health Center, Tongji Medical College of Huazhong University of Science and Technology, China)
Comparison of Risperidone Oral Solution (RIS-OS) and Intramuscular Haloperidol with the Latter Shifting to Oral Therapy for the Treatment of Acute Agitation in Patients with Schizophrenia
- ● Qing Zhao (Institute of Psychology, Chinese Academy of Sciences, China)
Further Exploration of Clinical Utility of Neurological Soft Signs: Discrimination of Bipolar Disorder from Major Depression
- ● Sang Joon Son (Yonsei University, Korea)
Anemia Associated with Executive Function in Mild Cognitive Impairment with Severe White Matter Hyperintensities
- ● Sheng Chun Yang (National Chen Kung University, Taiwan)
BDNF and Cytokines Change in Different Mood States of Bipolar II Disorder
- ● Shiho Miyazawa (Tohoku University, Japan)
Does Neuropsychological Performance Predict Social Function in Patients with Schizophrenia?: Evaluation with the MATRICS-CCB Japanese Version
- ● Soichiro Ide (Hokkaido University, Japan)
Involvement of Corticotropin-releasing Factor within the Dorsolateral Part of the Bed Nucleus of the Stria Terminalis in Pain-induced Aversion
- ● Sun Hwa Jung (Pusan National University, Korea)
Delay in Recovery of Normal Sleep-wake Cycle after Disruption of Light-dark Cycle in Mice: A Bipolar Disorder-prone Animal Model?
- ● Sung Nyun Kim (Seoul National University, Korea)
Neural Correlates of Impaired Response Inhibition in Patients with Obsessive-compulsive Disorder before and after Treatment
- ● Tae Young Lee (Seoul National University, Korea)
The Characteristics of People at Ultra High-risk for Psychosis on the Personality, Temperament, and Relationship Style with the Effect of 6-Month Pharmacotherapy
- ● Takeshi Takarada (Kanazawa University, Japan)
Possible Regulation of Adult Neurogenesis by Myosin VI Responsive to Traumatic Stress in Murine Hippocampus
- ● Woojae Myung (Sungkyunkwan University, Korea)
Genetic Association Study of Individual Symptoms in Depression

- ● Xiaofeng Hu (Peking University, China)
Association Study of DRD3 Gene Ser9Gly Polymorphism with the Therapeutic Effects of Two Antipsychotics
- ● Ya-Min Li (Central South University, China)
Efficacy and Tolerability of Ziprasidone Versus Olanzapine in First-episode Schizophrenia: 6-Week, Randomized, Open-label, Flexible-dose Study
- ● Yi Su (Peking University, China)
Osmotically Released Methylphenidate and Atomoxetine for the Treatment of Attention Deficit Hyperactivity Disorder: Efficacy and Adherence
- ● Yoshiaki Miyamoto (University of Toyama, Japan)
Knockdown of Dopamine D2 Receptor in the Nucleus Accumbens Attenuates Methamphetamine-induced Behavioral Responses in Mice
- ● Yoshiteru Takekita (Kansai Medical University, Japan)
A Open-label, Randomized Comparative Study of Perospirone and Aripiprazole in Japanese Schizophrenia Patients
- ● Yukio Ago (Osaka University, Japan)
Role of Brain Metabotropic Glutamate 2/3 Receptors in Social Isolation-induced Depressive Behavior of Mice

Contribution Association

- ● Korean Academy of Anxiety Disorder
- ● Korean Academy of Child and Adolescent Psychiatry
- ● Korean chapter of the International Society for Bipolar Disorder
- ● Korean Society for Depressive and Bipolar Disorders
- ● Korean Society for Schizophrenia Research
- ● Korean Society of Biological Psychiatry
- ● Korean Society of Biological Therapies in Psychiatry

Exhibition & Sponsorship

● ● PLATINUM



● ● GOLD



● ● SILVER

Bukwang Pharm. Co., Ltd.
Dong Wha Pharm. Co., Ltd.
Hanlim Pharm. Co., Ltd.

Myung In Pharm. Co., Ltd.
Sandoz Korea

● ● BRONZE

Abbott Korea Ltd.
Chong Kun Dang Pharmaceutical Corp.
Eisai Korea Inc.
Hyundai Pharm Co., Ltd.
Ildong Pharmaceutical Co., Ltd.
JW Pharmaceutical
Kwangwon Medical

MSD Korea Ltd.
Novartis Korea
Korean Drug Co., Ltd.
Whanin Pharm Co., Ltd.
Jeil Pharmaceutical Co., Ltd.
Brains On-Line BV

Hotel Information

- ● Venue Hotel

Grand Hilton Seoul Hotel

Contact Sunny Lee
Tel 82-2-2287-8428~9
Fax 82-2-2287-8095
E-Mail reservation.grandseoul@hilton.com
Address #201-1 HONGEUN DONG, SEODAEMUN GU, SEOUL, SOUTH KOREA,
 Grand Hilton Seoul Hotel
Website www.hilton.com (English)

Hotel	Room Type	Rate	Distance	Remarks
Grand Hilton Seoul Hotel	Single Room	KRW180,000	Venue	Tax & SVC excluded
	Twin / Double Room	KRW180,000		
	2 Bedroom (3 persons)	KRW 208,000		
	3 Bedroom (4 persons)	KRW 256,000		
	4 Bedroom (5 persons)	KRW 304,000		

NOTE

1. The room rates are fixed in Korean Won (KRW).
2. The above rates are per room per night and do not include breakfast.
3. The reservation form must be made through the hotel. If you click the reservation button, you can make reservation directly to the hotel by filling out the reservation form. Please do not send the reservation form to the 2nd AsCNP Secretariat via fax or e-mail.
4. For the guarantee of your room reservation, you must provide your credit card information to us when applying.
5. The reservation form must be accompanied by payment information by July 31, 2011 to guarantee your room. And the total payment shall be charged upon check-out.
6. Cancellation received a week prior or no-show: One night room rate will be charged.



● ● **Sub-hotels**

Best Western Premier Seoul Hotel

Contact Youn-Ho, Jeong
 Tel 82-2-710-7227
 Fax 82-2-711-6595
 E-Mail yhjeong@seoulgarden.co.kr
 Address 169-1, Dohwadong, Maogu, Seoul, Korea
 Website <http://www.seoulgarden.co.kr>



Class	Room Type	Rate	Distance	Remarks
★★★★	Single	KRW 130,000	20 minutes by car	Including breakfast (1 person)
	Double	KRW 150,000		Including breakfast (1 person)
	Twin	KRW 160,000		Including breakfast (2 persons)

Lotte City Hotel

Contact Leo Ok
 Tel 82-2-6009-1000
 Fax 82-2-4512-1004
 E-Mail reservationmapo@lotte.net
 Address Gongdeok-dong 467, Mapo-gu, Seoul, Korea
 Website <http://www.lottcityhotel.co.kr>

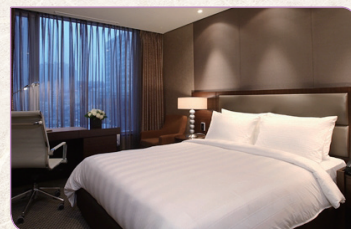

Class	Room Type	Rate	Distance	Remarks
★★★★	Double	KRW 135,000	20 minutes by car	Excluding breakfast
	Twin	KRW 145,000		

Tour Program

Korea is an exciting tourist destination with many interesting places to visit and many different cultures to experience. To explore Korea's diversified and unique heritage, various kinds of tour packages are provided below as an option.

Half day Tour

● ● HT-1 (Half day Tour-1)

Theme	Morning Clam Tour (Not including lunch)
Hours	Daily 09:30 - 12:30 Min. 2 Pax
Price (KRW/USD)	KRW 38,000
Itinerary	Hotel → Jogye Buddhist Temple → The Royal Guard Changing Ceremony → Gyeongbok Palace → The National Folk Museum → Pass by the Presidential Blue House → Amethyst Factory or Ginseng Outlet → Drop off at Itaewon Shopping Street



Gyeongbok Palace

Built 1394 as the main palace of the Joseon Dynasty (1392-1910) by its founder King Taejo, it is the most comprehensive and grandest of the five palaces of the period. There are many designated Cultural Assets in the Palace.



National Folk Museum

The National Folk Museum displays the lifestyle of ancient Koreans. There are 20,000 vestiges, with a total of 4000 folk relics. The National Folk Museum holds a 'Korean Folk Concert' every Saturday at the auditorium. The National Folk Museum designates the first Sunday every month as 'Visit the Museum' Day in admission fee is waived.



Jogye Buddhist Temple

Jogye Buddhist Temple is the center of Zen Buddhism in Korea, and is famous for being located in the city. The first things you will see when you enter inside are the lovely trees. These locust trees and Baeksong trees in front of the Daeungjeon, the main temple building, are about 500 years old.

● ● **HT-2 (Half day Tour-2)**

Theme	Afternoon Cultural Tour (Not including lunch)
Hours	Daily 13:00 - 17:30 Min. 2 Pax
Price (KRW/USD)	KRW 40,000
Itinerary	Hotel → Changdeok Palace → Insadong Antique Shop Alley → Namdaemun Market → Amethyst Factory or Ginseng Outlet → Hotel



Changdeok Palace

Gyeongbok Palace might be Seoul's largest Palace, but for many, Changdeok Palace is its most beautiful. A UNESCO World Heritage Site, Changdeok Palace is the epitome of Korean traditional architecture, its structures striking a fine balance with the natural landscape.



Insadong Antique Shop Alley

Seoul's most noted center for the Korean traditional arts and crafts, Insadong is an alley (actually, several alleys) full of small galleries, craft shops, art supply stores, Korean restaurants and traditional tea shops.



Namdaemun Market

Korea's most famous traditional outdoor market, the sprawling Namdaemun Market is home to countless shops selling just about everything under the sun, including clothes, curios, ginseng, food and more.

Full day Tour

● ● FT-1 (Full day Tour-1)

Theme	Full Day Tour (Including lunch)
Hours	Daily 09:00 - 17:00 Min. 2 Pax
Price (KRW/USD)	KRW 85,000
Itinerary	Hotel → Pass by the Presidential Blue House → Gyeongbok Palace → The National Folk Museum → Jogye Buddhist Temple → Lunch → Changdeok Palace (secret garden) → Insadong Art Galleries → Amethyst Factory or Ginseng Outlet → Namdaemun Market → Hotel



Gyeongbok Palace

The oldest and grandest of Seoul's royal palaces, Gyeongbok Palace is a masterpiece of Korean traditional architecture and one of Seoul's most visited locations.



Changdeok Palace

Gyeongbok Palace might be Seoul's largest Palace, but for many, Changdeok Palace is its most beautiful. A UNESCO World Heritage Site, Changdeok Palace is the epitome of Korean traditional architecture, its structures striking a fine balance with the natural landscape.



Insadong Antique Shop Alley

Seoul's most noted center for the Korean traditional arts and crafts, Insadong is an alley (actually, several alleys) full of small galleries, craft shops, art supply stores, Korean restaurants and traditional tea shops.



Namdaemun Market

Korea's most famous traditional outdoor market, the sprawling Namdaemun Market is home to countless shops selling just about everything under the sun, including clothes, curios, ginseng, food and more.

● ● **FT-2 (Full day Tour-2)**

Theme	DMZ Tour (Not including lunch)
Hours	Daily 08:00 - 14:30 Min. 2 Pax
Price (KRW/USD)	KRW 46,000
Itinerary	Hotel → Imjingak Park → The Unification Bridge → ID Check → DMZ → Film Presentation & Exhibition Hall → The 3 rd Infiltration Tunnel → Dora Observatory → Dorasan Station → Pass by Unification Village → Amethyst Factory or Ginseng Outlet → Drop off at Itaewon



DMZ

Korea is home to the World's last remaining Cold War frontiers, the Korean Demilitarized Zone (DMZ). This rare opportunity to peek into mysterious North Korea is just an hour's drive north of Seoul.

● ● **FT-2 (Full day Tour-2)**

Theme	DMZ Tour (Not including lunch)
Hours	Daily 08:00 - 14:30 Min. 2 Pax
Price (KRW/USD)	KRW 46,000
Itinerary	Hotel → Imjingak Park → The Unification Bridge → ID Check → DMZ → Film Presentation & Exhibition Hall → The 3 rd Infiltration Tunnel → Dora Observatory → Dorasan Station → Pass by Unification Village → Amethyst Factory or Ginseng Outlet → Drop off at Itaewon



The Korean Folk Village

The Korean Folk Village is home to numerous collections of Korean cultural artifacts, providing an opportunity for Korean children to experience and learn the culture of their ancestors firsthand. The site provides a venue to promote traditional Korean culture to both domestic and international visitors, and provides an open-air learning place for succeeding generations. The village has been developed to convey the wisdom and the spirits of our ancestors to both domestic and international tourists.

1. General Announcement

- Tours should be confirmed 2 days before your tour date depending on the minimum of persons joining each tour.

2. Cancellation Policy

- Day tours
 - Cancellation 2 days before tour date: 50% of tour fee will be deducted from the refund.
 - Cancellation 1 day before tour date: tour fee will not be refunded.
- Overnight tours
 - Cancellation 7 days before tour date: 50% of tour fee will be deducted from the refund.
 - Cancellation 3 days before tour date: 70% of tour fee will be deducted from the refund.
 - Cancellation 1 day before tour date: 100% of tour fee will be deducted from the refund.

For inquiries regarding Hotel and Tours, please contact

Kim's Travel Service / Official Tour Bureau

6F, Yuil B/D 411-14 Dogog-dong, Gangnam-gu, Seoul 135-270, Republic of Korea
Tel: +82-2-572-9998 Fax: +82-2-575-9932 E-mail: kims05@kimstravel.com

Registration

Registration

- For Registration, Please Sign-up first, and then follow the process for registration.
- Acknowledgement of registration will be sent to you via e-mail immediately after you complete the online registration.

● ● Registration Guideline

(USD1=KRW1,150 as of Feb. 10)

	Early-bird (by July 31)	Pre-registration (by August 31)	On-Site Registration
Specialist	KRW 240,000 (USD 210)	KRW 300,000 (USD 270)	KRW 350,000 (USD 310)
Trainee	KRW 70,000 (USD 70)	KRW 100,000 (USD 90)	KRW 150,000 (USD 140)
Life Member (KCNP)	KRW 120,000 (USD 110)	KRW 150,000 (USD 140)	KRW 200,000 (USD 180)

- Registration fee includes Name badge, Abstracts, Welcome Reception

● ● On-line registration

On-line registration will be available from August 31 via the official website of the 2011AsCNP at <http://www.2011ascnp.org>

● ● Cancellation Policy

Faxed, electronically mailed or post-marked

Cancellation received to July 31	Full refund
Cancellation received from August 1 to August 31	50% refund
Cancellation received after September 1	No refund

- All refunds will be made after the meeting.
- All bank services charges and administration fees will be deducted from all registration refunds.

● ● Payment Methods

Payment of registration fees should be made in US dollar or Korean Won by one of the following methods.

- Credit Card
 - Visa, Master, or JCB are available.
 - Payment by credit card is available only via the on-line registration process.
 - All service charges on credit card will be paid by participants

- Bank Transfer

Faxed, electronically mailed or post-marked

Bank Name	Woori Bank
Account Number	1005-301-300623
Swift Code	HVBKCRSEXXX
Branch Name	Woori Bank Tongyuido Br.
Bank branch address	61-3 Life Officetels Yeouido-dong Yeongdeungpo-gu Seoul, Korea
Account Name	Korean College of Neuropsychopharmacology

1. Sender's name should be same with registrant's name.
2. All bank remittance charges will be paid by participants.
3. A copy of the bank remittance receipt should be faxed to the Congress Secretariat.
4. Please ensure the registrant's name is on the bank remittance receipt.

- • **Letter of Invitation (for applicant of Visa for admission into Korea)**

The letter of invitation will be issued for the participants who have completed the registration payment. This letter is NOT a commitment on the part of the 2nd AsCNP organizer to provide financial assistance to any participant or accompanying persons. Expenses incurred are the sole responsibility of the participant. For more detail information, please contact to secretariat 2011AsCNP@smileml.com.

2nd Congress of

AsCNP



Asian College of Neuropsychopharmacology

Jointly with 2011 Annual Meeting
of Korean College of Neuropsychopharmacology

*“Asian Collaboration
on Neuropsychopharmacology and Neuroscience”*