



THE 3rd CONGRESS OF ASIAN COLLEGE OF NEUROPSYCHOPHARMACOLOGY

September 11-14, 2013

China National Convention Center

Program and Abstracts

How to use advances of neuropsychopharmacology and neuroscience to improve clinical practice



Sponsored by:
Chinese Medical Association
Chinese Society of Psychiatry

Organized by:
Peking University Institute of Mental Health



Table of Message

001	Welcome Message
002	Floor Plan of CNCC
005	Invited Speakers
020	Committees
021	General Information
023	Travel Fellowship
024	Information for Presenters
025	Information for Chairs
026	Program
034	Information for Poster Display
035	Posters
058	Abstracts



Welcome Message



YU Xin

Since Asia plays the pushing role in the world economic development, the progress of science in Asia needs to be more presented. AsCNP is the youngest among the world leading neuropsychopharmacological organizations but it grows in a fast way.

Psychiatry evolves with the advances of neuroscience, psychology, and social science.

Neuropsychopharmacology is not the one of the therapeutic measures for clinical service but the instrument to understand the brain as well as the pathology of neuropsychiatric disorders.

With the fast growth of the population and tremendous change of social structure, Asian countries are facing the various mental health challenges. However, most of our treatment guidelines coming from scientific evidence conducted in United States and European countries, it is partially because of the leading position of those countries in terms of psychiatric research, partially because we have not established a collaborating network in this region. We are very pleased to note that the advances in psychiatric research in this region are quite impressive in recent years. AsCNP provide a good space to share our experiences, ideas, and results. The similarities of our research questions provide collaboration opportunities while differences make us think more thoroughly. Another point I would like to make is AsCNP give more focus on younger staff and investigators. Hopefully they can know each other, make friends, and become working partners someday.

I would like to thank our colleagues for their persistent contribution and support to AsCNP, particularly from other international organizations such as CINP, ECNP, and ACNP. There will be seven plenary speeches, one special lecture, two meet the expert sessions and 16 symposium and free communications. I truly believe AsCNP will benefit all of us, from now on to the future. Welcome you all to Beijing and wish the great success of this meeting.

Yu Xin, MD

Chair of Organizing Committee of AsCNP2013

President of Chinese Society of Psychiatry (CSP)

Professor, Peking University Institute of Mental Health



Floor Plan of CNCC

L1

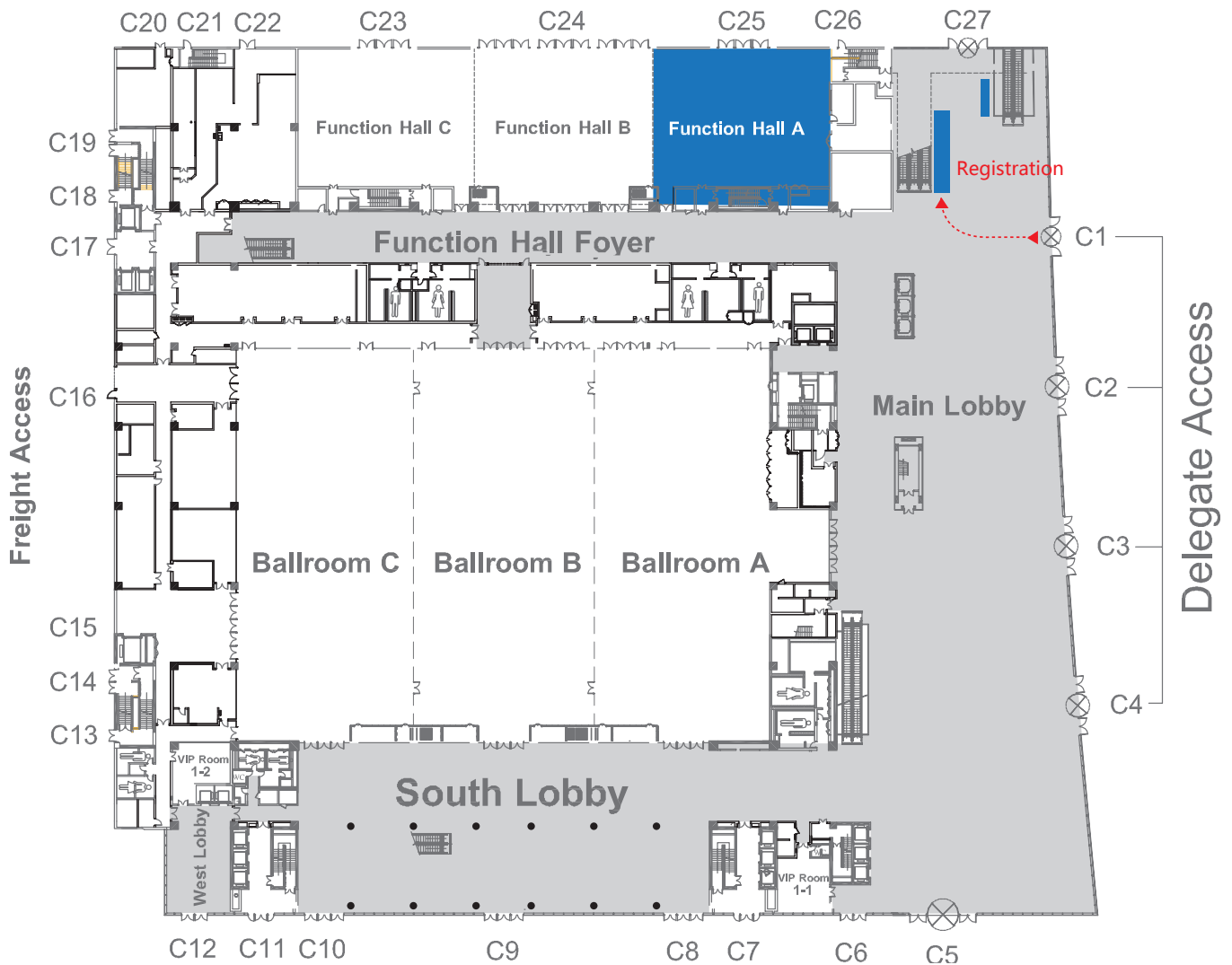



L2

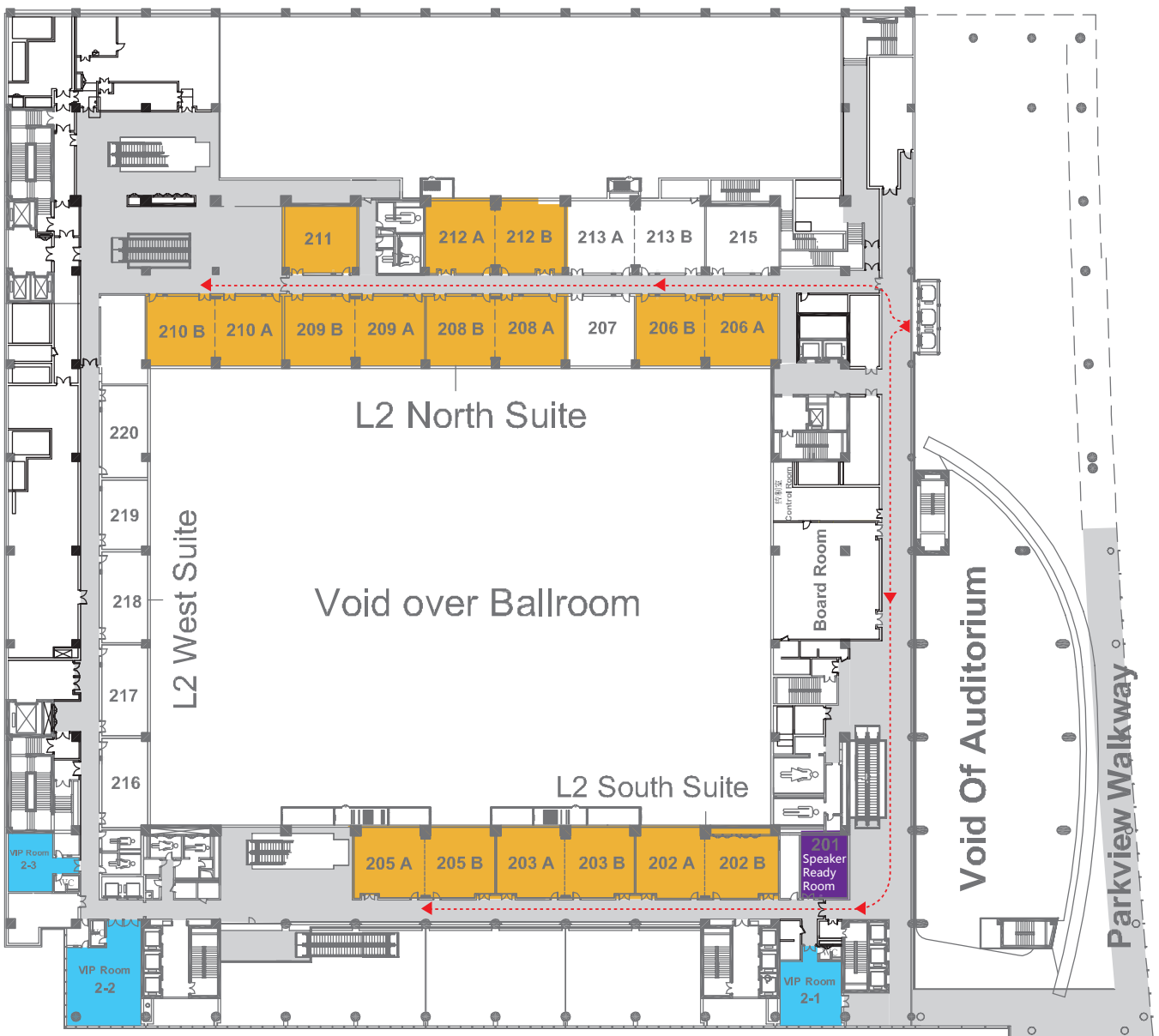



THE 3rd CONGRESS OF ASCNP ASIAN COLLEGE OF NEUROPSYCHOPHARMACOLOGY

L4

Walkway To CNCC Grand Hotel

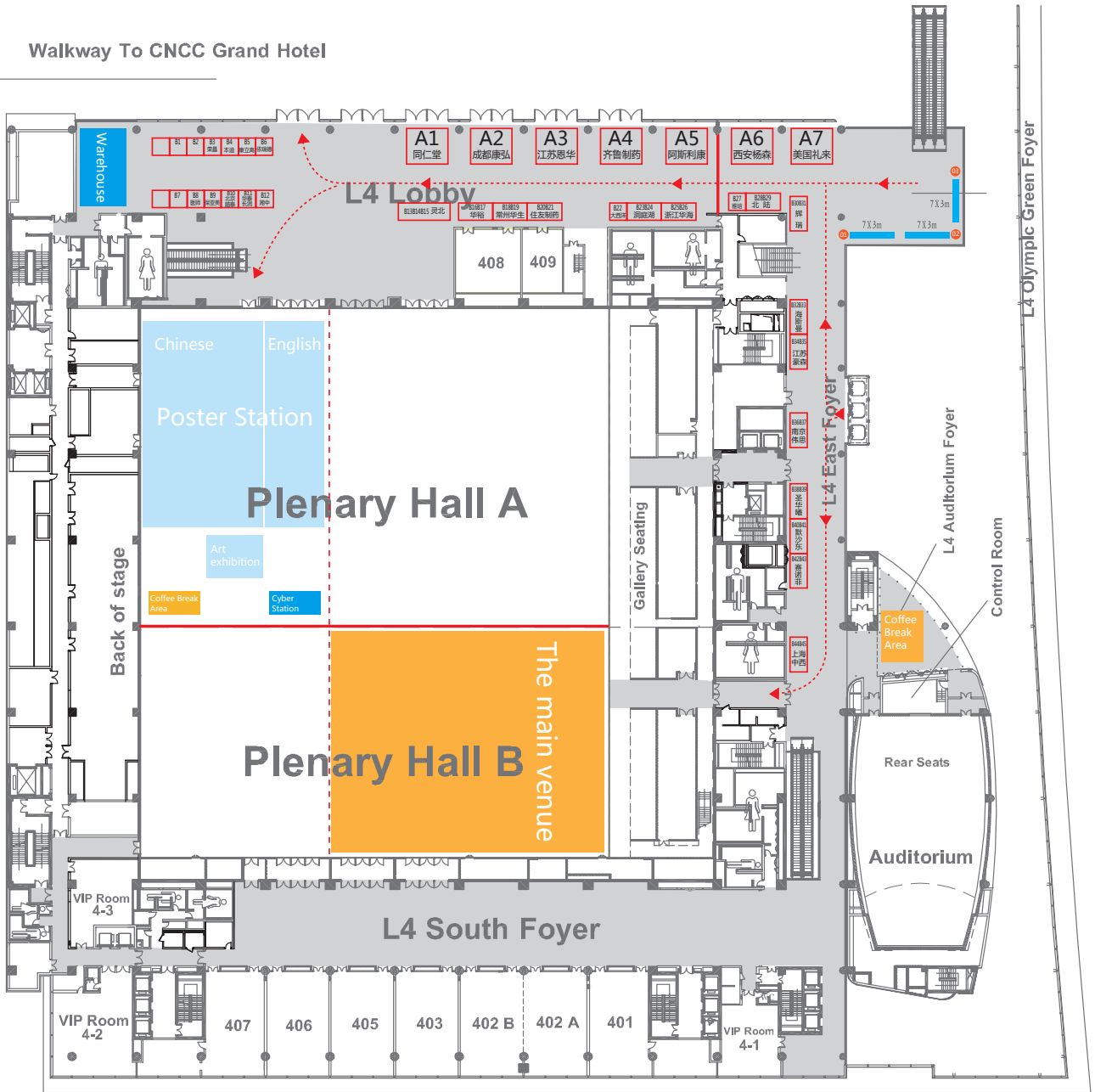



Invited Speakers



Christoph U. Correll

Christoph U. Correll, MD, is professor of psychiatry and molecular medicine at Hofstra North Shore-LIJ School of Medicine and medical director of the Recognition and Prevention (RAP) Program at the Zucker Hillside Hospital, both in New York.

Professor Correll completed his medical studies at the Free University of Berlin and Dundee University Medical School in Scotland. He is a board certified general psychiatrist and child and adolescent psychiatrist, having trained at The Zucker Hillside Hospital in Queens, New York.

Professor Correll's research and clinical work focus on the identification, characterization and treatment of adults and youth with severe psychiatric disorders. His areas of expertise include the prodrome, first episode, multi-episode and refractory illness phase of severe psychotic and mood disorders, including schizophrenia, bipolar disorder, major depression, as well as aggressive spectrum disorders. He further focuses on the risk-benefit evaluation of psychotropic medications, including the extent and mechanisms of cardiometabolic and neuromotor adverse effects.

Professor Correll has authored or co-authored over 200 journal articles. He has served on several expert consensus panels on the use of antipsychotics across a range of psychiatric disorders, is a reviewer for over 70 peer-reviewed journals and an editorial board member of 11 scientific journals. He is the principal investigator or Steering Committee member of several large, federally funded grants and has received over two dozen national and international research awards and fellowships for his work.



THE 3rd CONGRESS OF ASCNP ASIAN COLLEGE OF NEUROPSYCHOPHARMACOLOGY



Guy Goodwin

Guy Goodwin

University of Oxford, Oxford, UK

Guy Goodwin, FMedSci is currently WA Handley Professor of Psychiatry at the University of Oxford, Oxford, UK. He completed his medical degree and DPhil in physiology at the University of Oxford and, following his training in psychiatry, became a Clinical Scientist and Consultant Psychiatrist at the MRC Brain Metabolism Unit at the Royal Edinburgh Hospital, Edinburgh, UK.

Professor Goodwin's research interests are in the treatment of bipolar disorder and the application of neuroscience in understanding the neurobiology of mood disorders, with a focus on developing new treatments. He has been a lead investigator in clinical trials for bipolar affective disorder, including the BALANCE and CEQUEL studies. He works with industry in developing pre-clinical models of psychotropic drug action in man.

Professor Goodwin has served as a member of the Wellcome Trust Neurosciences Panel, the Council of the British Association for Psychopharmacology, the Clinical Fellowships Panel and Advisory Board of the Medical Research Council, INSERM's ANR panel and currently Council of ECNP. He is a Fellow of the American College of Neuropsychopharmacology, was previously President of the British Association for Psychopharmacology (2004–2005), is president elect of the European College of Neuropsychopharmacology and a NIHR Senior Investigator.



John M. Kane

John M. Kane, MD is Vice President for Behavioral Health Services of the North Shore - Long Island Jewish Health System and Chairman of Psychiatry at The Zucker Hillside Hospital. He is Chairman of Psychiatry and Professor of Psychiatry and Molecular Medicine at the Hofstra North Shore-LIJ School of Medicine. Dr. Kane received his B.A. from Cornell University and his M.D. from the New York University School of Medicine. He currently directs the NIMH-funded Advanced Center for Interventions and Services Research in Schizophrenia at The Zucker Hillside Hospital. He has been a member of the Board of Scientific Counselors for NIMH, and he has served on the council of the American College of Neuropsychopharmacology. He has chaired the NIMH Psychopathology and Psychobiology Review Committee as well as the Psychopharmacologic Drugs Advisory Committee of the Food and Drug Administration.

Dr. Kane is a recipient of the Arthur P. Noyes Award in Schizophrenia, the NAPPH Presidential Award for Research, the American Psychiatric Association Foundations' Fund Prize for Research, the Kempf Fund Award for Research Development in Psychobiological Psychiatry, the Lieber Prize for Outstanding Research in Schizophrenia, the Heinz E. Lehmann Research Award from New York State, and the Dean Award from the American College of Psychiatrists.



THE 3rd CONGRESS OF ASCNP ASIAN COLLEGE OF NEUROPSYCHOPHARMACOLOGY



KUA EE HEOK

Curriculum Vitae

KUA EE HEOK, MBBS, MD, FRCPsych,

Dr Kua Ee Heok is a Professor in the Dept of Psychological Medicine, National University of Singapore (NUS), and Senior Consultant Psychiatrist at the National University Hospital.

His postgraduate training in Psychiatry was at Oxford University and Geriatric Psychiatry at Harvard University. He was previously Head, Dept of Psychological Medicine, NUS; CEO and Medical Director, Institute of Mental Health; and Vice Dean, Faculty of Medicine, NUS.

A member of the WHO research team for the Global Study of Dementia, he has won many research prizes and has published 210 research papers and 20 books on ageing, dementia, and depression. He was the Past President of the Pacific-Rim College of Psychiatrists and Editor of the Asia Pacific Psychiatry journal.



Masatoshi TAKEDA

PROFESSOR Masatoshi TAKEDA, MD, PhD

Chairman Professor of Psychiatry

Osaka University Graduate School of Medicine

Prof. Takeda, MD, PhD, is the chairman professor of Department of Psychiatry, Osaka University Graduate School of Medicine since 1996. He graduated from Osaka University Medical School in 1979, and has been engaged with biological psychiatry research in Osaka University, University of Florida, Baylor Medical School. With his background of neurochemistry, molecular genetics, and cell biology, his research covers from basic to clinical psychiatry. He has published over 300 original papers in English, and over 300 Japanese papers in psychogeriatrics, and biological and clinical psychiatry. Recent research interest covers molecular biology of Alzheimer's disease, clinicopathology of schizophrenia, cognitive impairment in psychiatric disorders including, late life depression, PTSD and sleep disorders.

Prof. Takeda is the current President of Japanese Society of Psychiatry & Neurology (JSPN; 2012-2014), the largest academic organization in psychiatry with 16,000 psychiatrists.

He served as the President of Japanese Society of Biological Psychiatry (2009-2013), and as the chair of local organizing committee of the 11th WFSBP Congress in Kyoto, June 2013, where he is elected to the President-elect of WFSBP.

He organized the 13th Congress of International Psychogeriatric Association in Osaka, October 2007, and served as President of International Psychogeriatric Association (IPA; 2009-2011),

He serves as a board member of many academic societies, such as Japanese Society of Psychoneuropharmacology, Japanese Society of Dementia Research, Japanese Psychogeriatric Society, Japanese Society of Neurochemistry and many others.

He is the Editor-in-Chief of Psychogeriatrics (official journal of Japanese Psychogeriatric Society), Dementia Japan (official journal of Japanese Dementia Research Society), Cognition and Dementia, and Schizophrenia Frontier.



THE 3rd CONGRESS OF ASCNP ASIAN COLLEGE OF NEUROPSYCHOPHARMACOLOGY



Norman Sartorius

CURRICULUM VITAE

Norman Sartorius, M.D., M.A., D.P.M., Ph.D., FRC. Psych.

Dr Norman Sartorius, MD, MA, DPM, PhD, FRCPsych, obtained his M.D. in Zagreb (Croatia). He specialized in neurology and psychiatry and subsequently obtained a Masters Degree and a Doctorate in psychology (Ph.D.). He carried out clinical work and research and taught at graduate and postgraduate levels at the University of Zagreb, at the Institute of Psychiatry in London, at the University of Geneva and elsewhere.

Dr Sartorius joined the World Health Organization (WHO) in 1967 and soon assumed charge of the programme of epidemiology and in social psychiatry. He was the principal investigator of several major international studies on schizophrenia, on depression and on health service delivery. He was responsible for WHO's work on the classification of mental and neurological disorders. In 1977, he became the first Director of the Division of Mental Health of WHO, a position which he held until mid-1993. In June 1993 Professor Sartorius was elected President of the World Psychiatric Association (WPA) and served as its President until August 1999. Subsequently he became President of the Association of European Psychiatrists (EAP) a position held until December 2001. He is the President of the Association for the Improvement of Mental Health Programmes and a member of the Geneva Prize Foundation having been its President 2004-2008. Dr Sartorius holds professorial appointments at the Universities of London, Prague and Zagreb and at several other universities in the USA and China.

Professor Sartorius has published more than 400 articles in scientific journals, authored or co-authored books and edited a number of others.



Professor Sartorius is a corresponding member of the Croatian Academy of Arts and Sciences and of the Spanish Royal Academy of Medicine and a honorary member of the Medical Academies of Croatia, Mexico and Peru. He holds honorary doctorates of the Universities of Bath, Copenhagen, Prague and Umea and is a honorary fellow of the Royal College of Psychiatrists of the United Kingdom of Great Britain, of the American College of Psychiatry and of the Royal Australian and New Zealand College of Psychiatrists. He is also a Distinguished Fellow of the American Psychiatric Association. He is an Honorary Member of numerous professional associations and advisory boards, both national and international. He is the Co-editor of three scientific journals and a member of editorial and advisory boards of many scientific journals



THE 3rd CONGRESS OF ASCNP ASIAN COLLEGE OF NEUROPSYCHOPHARMACOLOGY



SW Tang

Professor Siu-wa Tang is the Director of Institute of Brain Medicine (International) (www.ibrainmedicine.org). He is Emeritus Professor of Psychiatry of the University of California, Irvine in USA and Honorary Professor of Anatomy of the University of Hong Kong SAR.

Professor Tang was the Former Head of Psychopharmacology Department at the Clarke Institute of the University of Toronto in Canada and was the Former Chair Professor in Psychiatry of the University of Hong Kong SAR. Professor Tang founded the Hong Kong SAR Society of Biological Psychiatry (HKSBP) in 2004 and entered the Society as a member of the World Federation of Societies of Biological Psychiatry.

His primary research and academic interests include: mood disorder, neuroanatomy and neurochemistry, clinical and molecular psychopharmacology, computer sciences and information technology as applied to medicine. He is the recipient of the 2010 Kraepelin-Alzheimer Medal, Munich, Germany and the 2011 World Federation of Biological Psychiatry (WFSBP) Excellence in Education award.



Hans-Jürgen Möler

BIOGRAPHICAL SKETCH

PROFESSOR DR.MED.

DR.H.C.MULT.

Hans-Jürgen Möler

Professor of Psychiatry Department of Psychiatry

Ludwig-Maximilians-University Munich, Germany

Hans-Jürgen Möler has been working in the field of psychiatry for 30 years. After obtaining his Doctor of Medical Science in 1972 from the Universities of Göttingen and Hamburg, Germany, he then specialised in psychiatry and postgraduate training at the Max Planck Institute of Psychiatry in Munich. Professor Möler completed a postdoctoral thesis (habilitation) in psychiatry in 1979. From 1980 to 1988 he was professor of psychiatry at Munich Technical University, and from 1988 to 1994 full professor of psychiatry and chairman of the Psychiatric Department at the University Bonn, Bonn, Germany. He is currently full professor of psychiatry in the Psychiatric Department at the Ludwig-Maximilians-University, Munich.

Professor Möler's main scientific contributions include clinical and neurobiological research into psychiatry, schizophrenia and depression and clinical psychopharmacology. He has been a member of the executive committees of several national and international psychiatric societies. In 2010 he was president of the European Psychiatric Association (EPA) where he is now past-president. He is an honorary member of the World Psychiatric Association (WPA) and serves as chairman of the Section on Pharmacopsychiatry. For two years he has been a member of the executive committee of the Collegium Internationale Neuro-Psychopharmacologicum (CINP), where he was president. From 1997 to 2001 he was president of the World Federation of Societies of Biological Psychiatry (WFSBP), where he is now honorary president.



THE 3rd CONGRESS OF ASCNP ASIAN COLLEGE OF NEUROPSYCHOPHARMACOLOGY

In addition to authoring and co-authoring over 1300 publications such as original articles, international papers and several books (IF: 2241; Hirsch-Index 64), he has acted as chief editor of The World Journal of Biological Psychiatry from 2000 to 2009. He is main editor of European Archives of Psychiatry and Clinical Neuroscience, and editor of one major German psychiatric journal Psychopharmakotherapie. He holds positions on the editorial boards of numerous national and international psychiatric journals.

In 2008, Professor Möler was awarded the prestigious Jean Delay Prize from the World Psychiatric Association. In 2009, he was awarded the honorary doctorate by the University Victor Babeş of Timisoara/Romania, the WFSBP Lifetime Achievement Award and the Aristotle Medal by the University of Thessaloniki. In 2010, he was awarded the honorary doctorate by the University of Cluj-Napoca/Romania, followed in 2011 by the honorary professorship by the University of Lima/Peru and the honorary doctorate by the University of Thessaloniki.



Shigeto Yamawaki

Shigeto Yamawaki, MD, PhD

Professor and Chairman

Department of Psychiatry and Neurosciences,

Hiroshima University School of Medicine

Prof. Shigeto Yamawaki graduated from the School of Medicine, Hiroshima University, Japan in 1979 and received his PhD in 1985. He was appointed Professor and Chairman in the Department of Psychiatry and Neurosciences of the School of Medicine, Hiroshima University in 1990. Currently, he is President-Elect of the International College of Neuropsychopharmacology (CINP), President of the Japanese Society of Neuropsychopharmacology (JSNP) and Past-President of the Asian College of Neuropsychopharmacology (AsCNP).

He has conducted many research projects as a principal investigator of both basic and clinical studies on mood disorders including treatment-resistant depression, vascular depression, and depression in cancer patients. His recent research has focused on the area of molecular neurobiology, including epigenetic mechanism of depression, and neuroimaging studies on mood/emotion regulation using various emotion tasks and reward prediction tasks in patients with depression and eating disorders. He has over 250 publications covering these topics in scientific international journals. He has served as an editorial board member of several international journals including the International Journal of Neuropsychopharmacology.



THE 3rd CONGRESS OF ASCNP ASIAN COLLEGE OF NEUROPSYCHOPHARMACOLOGY

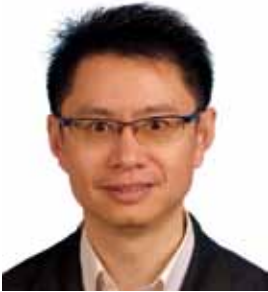

YU Xin

Name and Current Position

YU, Xin, Professor of Psychiatry

Affiliation

Peking University Institute of Mental Health

Education/Career

Residency in psychiatry, Institute of Mental Health, Beijing Medical University, (1988-1993)

Psychiatrist, Institute of Mental Health, Beijing Medical University, (1993-1998)

Pfizer/Old Age Psychiatry Fellowship, St. George Hospital, Department of Psychiatry, Melbourne University, Australia (1996-1997)

Hubert Humphrey Fellowship, School of Public Health, Johns Hopkins University, USA (1998-1999)

Head of Geriatric Psychiatric Department, Institute of Mental Health Peking University, Associate Professor of Psychiatry, Geriatric psychiatrist (1999-2001)

Assistant Director, Institute of Mental Health, Peking University (2000-2001)

Executive Director, Peking University, Institute of Mental Health (2001-2004)

Director, Peking University Institute of Mental Health (2004-2013)

Major research fields

Dementia, late life depression and psychosis, substance abuse, first onset schizophrenia, mental health and HIV/AIDS, bipolar disorders, neurocognition assessment in neuropsychiatric disorders.



Publications and Awards

Co-authored more than 90 original articles and more than 15 book chapters; Editor-in-chief of Chinese Mental Health Journal and editors of more than ten domestic and international peer-reviewed journals

Present Appointments and Titles

President of Chinese Society of Psychiatry (2013-2015);

Founding president of Chinese Psychiatrist Association (2005-2007);

Vice Chairman of Alzheimer's Disease of China (2010-20014)



THE 3rd CONGRESS OF ASCNP ASIAN COLLEGE OF NEUROPSYCHOPHARMACOLOGY



Jun Soo Kwon

Jun Soo Kwon, M.D., Ph.D.

Chair & Professor

Department of Psychiatry, Seoul National University College of Medicine.

Brain & Cognitive Science Program-WCU, Seoul National University, Korea

Education

1984 M.D. Seoul National University College of Medicine, Seoul, Korea.

1988- Board of Certificate, Psychiatry

1993 Ph.D. Seoul National University, Medicine, Seoul, Korea.

1996-1998 Clinical Research Training Program, Psychiatry, Harvard Medical School

Academic & Clinical Appointments

1996.4-1998.3 Visiting Assistant Professor, Dept. of Psychiatry, Harvard Medical School

1998-present Director, Obsessive-compulsive Disorder Clinic, Seoul National University Hospital

2004-present Director, Seoul Youth Clinic (High Risk Clinic), Seoul National University Hospital

2005.3-present Professor, Dept. of Psychiatry, Seoul National University Medical College

2000.3-present Professor, Integrated Program in Brain Science, Seoul National University

2008.11-present Professor, Brain & Cognitive Sciences-WCU program, Seoul National University

Major Academic Societies

2005-2008 President, Korean Society for Anxiety Disorder

2005-2007 Chair, Scientific Committee, WPA regional Meeting 2006 Seoul

2006-present Vice President, Korean College of Neuropsychopharmacology

2006-present Member, Korean Academy of Science & Technology



2008-2011	President, Korean Society of Schizophrenia Research
2008-2012	Councillor, Collegium Internationale Neuro-Psychopharmacologicum (CINP)
2008-present	Regional Editor, Asian Journal of Psychiatry
2009-present	Editorial Board, Early Intervention in Psychiatry, Psychiatry Research: Neuroimage
2009-2013	Councillor, Asian College of Neuropsychopharmacology
2009-2011	Chair, 2nd Asian Congress of Schizophrenia Research
2009-2011	Editor-in-Chief, Psychiatry Investigation (SCIE journal)
2010-2012	Member, Credentials and Membership Committee (CINP)
2010-present	Member, National Academy of Medicine of Korea
2011-present	Director, Institute of Human Behavioral Sciences, Medical Research Council, SNU
2011-2014	Board of Directors, Schizophrenia International Research Society (SIRS)

Honors and Awards

2000. 10	Paul Jassen Schizophrenia Research Award
2002. 10	The 1st GSK Academic Award (Korean Neuropsychiatric Association)
2004. 04	Young Researcher Award, Seoul National University Hospital
2004. 11	Siemens Human Brain Mapping Academic Award
2009. 05	2009 SNUH "Shim Ho Seob" Academic Award (Seoul National University Hospital)
2009. 11	Seoul National University Academic Research Award
2009. 11	2009 Wunsch Medical Award (Korean Medical Association)
2011. 08	Award from Asian Federation of Psychiatric Association
2011. 10	Academic Award from Korean Academy of Anxiety Disorder
2013. 03	Asan Medical Award



THE 3rd CONGRESS OF ASCNP ASIAN COLLEGE OF NEUROPSYCHOPHARMACOLOGY

Committees

AsCNP Officers

Founding President

Shigeto Yamawaki (Japan)

President

Yu, Xin (China)

Past President

Young-Hoon Kim (Korea)

AsCNP Council

Chou, Yuan-Hwa (Chinese Taipei)

Ikeda, Kazutaka (Japan)

Ishigooka, Jun (Japan)

Kanba, Shigenobu (Japan)

Kim, Chang-Yoon (Korea)

Kim, Chan-Hyung (Korea)

Kim, Young Hoon (Korea)

Kwon, Jun-Soo (Korea)

Lane, Hsien-Yuan (Chinese Taipei)

Liu, Chia-Yih (Chinese Taipei)

Ohmori, Tetsuro (Japan)

Shimoda, Kazutaka (Japan)

Su, Tom Tung Ping (Chinese Taipei)

Tanra, Andi J. (Indonesia)

Yamada, Kiyofumi (Japan)

Yoon, Jin-Sang (Korea)

Organizing Committee

Chair

Yu, Xin (China)

Jingping Zhao (China)

Secretary General

Yanbo Yuan (China)

Members

Jia, Fujun (China)

Li, Keqing (China)

Lv, Luxian (China)

Ma, Xin (China)

Ning, Yuping (China)

Shi, Shenxun (China)

Sun, Xueli (China)

Tan, Qingrong (China)

Tang, Jisheng (China)

Tian, Hongjun (China)

Wang, Xiangqun (China)

Wang, Zhe (China)

Xiao, Zeping (China)

Yang, Fude (China)

Zhang, Ning (China)

Zheng, Yi (China)

Scientific Program Committee

Chair

Tianmei Si (China)

Gang Wang (China)

Members

Fang, Yiru (China)

Gao, Chengge (China)

He, Yanling (China)

Hu, Jian (China)

Li, Lingjiang (China)

Li, Tao (China)

Liu, Tiebang (China)

Liu, Zhening (China)

Lu, Zheng (China)

Meng, Huaqing (China)

Tan, Yunlong (China)

Wang, Gaohua (China)

Wang, Xueyi (China)

Xie, Shiping (China)

Xu, Xiufeng (China)

Xu, Yi (China)

Zhang, Kerang (China)

Zhang, Ruiling (China)

Zhao, Min (China)



General Information

Registration Office and Opening Hours

- **Location:** Lobby of the China National Convention Center.

- **Opening hours:**

Thursday, September 12, 2013: 0800-1900

Friday, September 13, 2013: 0800-1700

Saturday September 14, 2013: 0830-1100

- **Participant Identification:**

Please wear your name badge for all conference activities. Access to meeting rooms and exhibition will be denied without a valid badge. Lost badges can be replaced at the registration desk (USD5 each).

Blue lanyard: Participant

Blue lanyard: Exhibitor

Red lanyard: Staff

Social Events

- **Opening Ceremony**

Venue: Plenary Hall B, Level 4, CNCC

Time and Date: 0830-0900, September 13, 2013

Admission: All registered participants, exhibitors and accompanying persons are invited to participate in the event.

- **Closing Ceremony**

Venue: Function Hall A, Level 1, CNCC

Time and Date: 11:40-12:00, September 14, 2013

Admission: All registered participants, exhibitors and accompanying persons are invited to participate in the event.

- **Special Lecture and Reception**

Venue: Auditorium, Level 3, CNCC

Time and Date: 18:00-20:00, September 12, 2013

Admission: By Invitation



THE 3rd CONGRESS OF ASCNP ASIAN COLLEGE OF NEUROPSYCHOPHARMACOLOGY

Post Congress Enquiry

If you have any questions after the congress, please contact:

AsCNP 2013

Chinese Medical Association

42 Dongsi Xidajie Beijing 100710, China

Tel: +86 10 8515 8147 Fax: +86 10 6512 3754

Email: zhuyz@cma.org.cn

Language

English is the only official language.

Business Center

There is a business center on the level 3 of the CNCC that provides services such as copying, fax transmittal and receiving the general office supplies.

Certificate of Attendance

All registered participants will be provided a certificate of attendance, which will be found inside the congress bag.

Meals

Lunches will be provided. Please refer to the meal coupons for pick-up information on the time and place.

Accommodations

For any enquiries about hotel rooms, please go to the registration office for information.

Money Exchange

The Yuan (RMB) is the official currency in China. After arriving you are recommended to exchange a small amount of money for taxi fare etc. The exchange rate is about \$1 USD = RMB 6.3 (September, 2013). Most major credit cards – Visa, Master Card and American Express – are accepted at most hotels, large restaurants and shopping centers.

Tipping

Tipping is not expected by service attendants in China, except for tour guides, hotel porters and housemaids.



Travel Fellowship

●The following applicants are awarded the travel fellowship by the Scientific Program Committee after peer review.

NAME	COUNTRY
Uchida Hiroyuki	Japan
Kishimoto Taishiro	Japan
Yanhui Liao	China
Nakajima Shinichiro	Japan
CHENG CHIN	Chinese Taipei
Allen Lee	Hong Kong SAR
Mizuno Yuya	Japan
Yabuki Yasushi	Japan
Oshibuchi Hidehiro	Japan
Li Lei	China
An Yan	China
shan wei	China
Sun Wei	China



THE 3rd CONGRESS OF ASCNP ASIAN COLLEGE OF NEUROPSYCHOPHARMACOLOGY

Information for Presenters

Each presenter is asked to check the program book for information of their presentation, such as date, time slot and meeting room, and required to comply with the time length. Please do not exceed the time limits. The time for each presentation and discussion will be at the decision of the chair(s) of the symposium.

Each speaker is required to check their slides at least 4 hours before the scheduled presentation at the Speaker Ready Room, and to leave your slides in the Speaker Ready Room after having the slides checked. The staff in the speaker ready room will be responsible for distributing the slides to the meeting rooms. The on-site staff in each meeting room will not accept unchecked slides.

The Speaker Ready Room is in Meeting Room 201 on the second level of CNCC. The opening hours of the speaker ready room are as follows:

Thursday, September 12, 2013: 1200-1900

Friday, September 13, 2013: 0800-1730

Saturday, September 14, 2013: 0800-1000

Tel: +86 10 84379019

Each speaker is asked to prepare their slides in format of Powerpoint 2010 or below with Microsoft Windows, and is NOT encouraged to use their own laptops. Each speaker is asked to arrive at the meeting room 10 minutes prior to the commencement of the session and communicate with chairs of the session after arrival.



Information of Chairs

- Each chair is asked to arrive at the meeting room 15 minutes prior to the commencement of the session. After arrival, please communicate with on-site staff and speakers who take the seats in the first row.
- Please ensure that each session goes as scheduled and stop any presentation if it exceeds the time limit;
- Please organize panel discussion when all presentations are finished, and provide assistance for language problems ;
- Please summarize the session before conclusion.



THE 3rd CONGRESS OF ASCNP ASIAN COLLEGE OF NEUROPSYCHOPHARMACOLOGY

Program

September 12th, 2013

- 16:00-18:00 Psychopharmacology Training Course 210A+B
Chair: Norman Sartorius (Switzerland), SW Tang (Hong Kong SAR)
- 16:00-16:30 Comorbidity of mental and physical illness: a major problem for the 21st Century
Norman Sartorius (Switzerland)
- 16:30-17:30 Psychopharmacology for Psychiatrist
SW Tang (Hong Kong SAR)
- 18:30-20:30 Special Lecture & Reception Auditorium, CNCC Chair: Xin Yu (China)
- 18:30-19:00 Psychiatry 2013 and its future
Norman Sartorius (Switzerland)

September 13th, 2013

- 07:30-08:30 Meet the expert 1: A Personal Journey into Academic Psychiatry
202A+B Chair: Kua Ee Hoek (Singapore)
- 08:30-08:50 Opening Ceremony Plenare Hall B Chair: Tianmei Si (China)
- 08:50-11:50 Plenary Lecture 1 Plenare Hall B
Chair: Young Hoon Kim (Korea), Jingping Zhao (China),
Tung-Ping Su (Chinese Taipei), Shenxun Shi (China)
- 08:50-09:25 The Pharmacologic Treatment of Schizophrenia: How Far Have We Come?
John M. Kane (USA)
- 09:25-10:00 Co-medication/Polypharmacy in psychiatric treatment – irrational or rational?
Hans-Jürgen Möller (Germany)
- 10:00-10:35 Neuroimaging of Social Brain and Emotional Brain
Shigeto Yamawaki (Japan)
- 10:35-11:10 Pharmacotherapy and clinical characteristics of clinical high risk (CHR) for psychosis
Jun Soo Kwon (Korea)
- 11:10-11:45 Update on the Acute and Maintenance Treatment in Bipolar Disorder
Christoph U. Correll (USA)
- 12:30-13:30 Meet the expert 2: Perspectives in dementia research -From epidemiology to molecular biology of dementia
206A+B Chair: Masatoshi Takeda (Japan)
- 14:00-15:30 Symposium 1 : Pharmacotherapy for Bipolar Disorder: A real world snapshot in Asian countries and future directions
202A+B Chair: Kyooseb Ha (Korea)
- 14:00-14:20 Efficacy and safety of olanzapine for treatment of patients with bipolar depression: Japanese subpopulation analysis of a randomized, double-blind, placebo-controlled study
Shigenobu Kanba (Japan)
- 14:20-14:40 Pattern of drug use in bipolar disorder in Hong Kong SAR
Michael Wong (Hong Kong SAR)



- 14:40-15:00 Pattern of pharmacotherapy in Korea and concordance with treatment guidelines
Kyooseob Ha (Korea)
- 15:00-15:20 What is an ideal mood stabilizer?
Yuan-Hwa Cho (Chinese Taipei)
- 14:00-15:30 Symposium 2: Neuromodulation in the treatment of mental disorders, experience in Asia
203A+B Chair: Tung-Ping Su (Chinese Taipei)
- 14:00-14:20 Launching and spreading of repetitive transcranial magnetic stimulation (rTMS) treatment in psychiatric practice
Jeong-Ho Chae (Korea)
- 14:20-14:40 rTMS on the possible neurocircuits in the treatment of refractory major depression: efficacy and mechanisms
Cheng-Ta Li (Chinese Taipei)
- 14:40-15:00 Effect of rTMS on cerebral glucose metabolism and brain connectivity
Tung-Ping Su (Chinese Taipei)
- 15:00-15:20 Deep Brain Stimulation for Refractory Psychiatric Disorders
Bomin Sun (China)
- 14:00-15:30 Symposium 3: New targets for pharmacotherapy of substance use disorders
205A+B Chair: Kazutaka Ikeda (Japan)
- 14:00-14:20 Synaptic Glutamate Spillover and Relapse to Drug Seeking
Haowei Shen (China)
- 14:20-14:40 Involvement of sigma-1 receptor as a molecular chaperone on the rewarding effects of methamphetamine
Tomohisa Mori (Japan)
- 14:40-15:00 Actin polymerization-dependent increase in synaptic Arc/Arg3.1 expression in the amygdala is crucial for the expression of aversive memory associated with drug withdrawal
Jing-gen Liu (China)
- 15:00-15:20 NMDA receptor channel subunit GluN2D as a key target of phencyclidine
Kazutaka Ikeda (Japan)
- 14:00-15:30 Symposium 5: Advances in pharmacotherapy of mental disorders in children and adolescents
208A+B Chair: Jing Liu (China), Stan Kutcher (Canada)
- 14:00-14:20 Treatment of Tic disorders in China
Yi Zheng (China)
- 14:20-14:40 Med Ed: Youth Oriented and Informed Resources to Support Psychopharmacotherapeutic Decision-Making
Stan Kutcher (Canada)
- 14:40-15:00 Pharmacogenomics of ADHD medication
Li Yang (China)
- 15:00-15:20 Pharmacological treatments to children with Autism Spectrum Disorder in China
Xiaoyan Ke (China)



THE 3rd CONGRESS OF ASCNP ASIAN COLLEGE OF NEUROPSYCHOPHARMACOLOGY

- 15:50-17:20 Symposium 6: Novel Drug Targets for Potential Treatment of Neuropsychiatric Disorders
202A+B Chair: Xin-Min Li (Canada)
- 15:50-16:10 Regulation of serotonin transporter in the living brain: an old story but new insight
Yuan-Hwa [Cho](#) (Chinese Taipei)
- 16:10-16:30 Anti-inflammatory effects of statin treatment in primary cultured microglia
[Matthew A. Churchward](#) (Canada)
- 16:30-16:50 Oligodendrocyte dysfunction, demyelination and schizophrenia-like behaviours
[Xin-Min Li](#) (Canada)
- 16:50-17:10 Arylalkylhydrazines and neuroprotective mechanisms
[Dmitriy Matveychuk](#) (Canada)
- 15:50-17:20 Symposium 7: Individualized MDD Treatment Forum
203A+B Chair: Xin Yu (China)
- 15:50-16:10 Opening
[Xin Yu](#) (China)
- 16:10-16:40 Individualized MDD Treatment
[Sidney H. Kennedy](#) (Canada)
- 16:40-17:10 Panel Discussion
[Kaida Jiang](#) (China), [Tianmei Si](#) (China), [Fujun Jia](#) (China)
- 17:10-17:20 Summary
[Xin Yu](#) (China)
- 15:50-17:20 Symposium 8: Recent neuropsychopharmacological studies of the amino acid neurotransmission for the understanding and treatment of schizophrenia and neurodevelopmental disorders
205A+B Chair: Tetsuro Ohmori (Japan)
- 15:50-16:10 Sarcosine (N-methyl-glycine) in treatment for attention deficit hyperactivity disorder
[Ruu-Fen Tzang](#) (Chinese Taipei)
- 16:10-16:30 Modulation of glutamatergic neurotransmission in the treatment of obsessive compulsive disorder
[Po-Lun Wu](#) (Chinese Taipei)
- 16:30-16:50 Glutamate and GABA concentrations in schizophrenia patients and the effects of antipsychotic medication: results from proton magnetic resonance spectroscopy studies
[Masahito Nakataki](#) (Japan)
- 16:50-17:10 Dysregulation of D-serine and NMDA receptor in the brain: Implication for schizophrenia
[Naoki Yamamoto](#) (Japan)



- 15:50-17:20 Symposium 9: Phase Specific Treatment of Schizophrenia: Evidence and Clinical Practice
208A+B Chair: John Kane (USA), Taishiro Kishimoto (Japan)
- 15:50-16:10 The Identification and Treatment of the Schizophrenia Prodrome
Christoph U. Correll (USA)
- 16:10-16:30 The Treatment of First Episode
John Kane (USA)
- 16:30-16:50 Health service utilization and long-acting injectable antipsychotic treatment: results from the national claim-based database in Chinese Taipei
Kuan-Pin Su (Chinese Taipei)
- 16:50-17:10 Medical decision making about clozapine and long-acting antipsychotic injections: results from a global survey
Taishiro Kishimoto (Japan)
- 15:50-17:20 Symposium 10: Pharmacotherapy of schizophrenia and mood disorders in Asian Countries: Research on Asian Psychotropic Prescription Pattern (REAP) project
211 Chair: Shinfuku Naotaka (Japan) , Wei Hao (China)
- 15:50-16:10 REAP : Factors deciding the prescription of anti-psychotics in Asia
Shinfuku Naotaka (China)
- 16:10-16:30 What is the Evidence of Antidepressant use in East Asia?
Tan Chay Hoon (Singapore)
- 16:30-16:50 REAP Study in China
Yanling He (China)
- 16:50-17:10 Common use of high doses of antipsychotic medications in older Asian patients with schizophrenia (2001-2009)
Yutao Xiang (China)



THE 3rd CONGRESS OF ASCNP ASIAN COLLEGE OF NEUROPSYCHOPHARMACOLOGY

September 14th, 2013

- 08:30-10:00 AsCNP Symposium 11: Bridging Brain Imaging Data to Real-World Clinical Practice
206A Chair: Hiroyuki Uchida (Japan)
- 08:30-08:50 Predicting therapeutic dose for each individual patient with schizophrenia
Hiroyuki Uchida (Japan)
- 08:50-09:10 Association of serotonin transporter and BDNF in models of SERT genotypes in human subjects: a new insight for the development of antidepressant
Yuan-Hwa Cho (Chinese Taipei)
- 09:10-09:30 Predicting brain occupancy from plasma level by combining pharmacokinetics with pharmacodynamics
Euitae Kim (Korea)
- 09:30-09:50 Dopamine D2 Receptor Blockade with Antipsychotics and Cognition in Schizophrenia
Shinichiro Nakajima (Canada)
- 08:30-10:00 AsCNP Symposium 12: Recent advances in neuropsychopharmacology: translational study from bench to clinic
206B Chair: Tung-Ping Su (Chinese Taipei)
- 08:30-08:50 Pharmacological Treatments for Alcohol-related Disorders in China: A Developing Story
Wei Hao (China)
- 08:50-09:10 Management of major depressive disorder after an inadequate response to first-line treatment
Cjhia-Yi Liu (Chinese Taipei)
- 09:10-09:30 The translational study in affective disorders from diagnosis to treatment using brain imaging and neurostimulation techniques
Tung-Ping Su (Chinese Taipei)
- 09:30-09:50 Early use of clozapine in First-Episode Patients
Tianmei Si (China)
- 08:30-10:00 AsCNP Symposium 13: Recent update of Addictive Phenomen in South-East Asian Countries, Indonesia and Malaysia View
208A Chair: Andi J Tantra (Indonesia)
- 08:30-08:50 The Relation between Cannabis Abuse and Cognitive Function
Kristina Siste (Indonesia)
- 08:50-09:10 Perceived Stress, Coping Strategy and Psychopathology Among HIV Seropositive People who Injecting Drug (PWID) in Working Group on AIDS Cipto Mangunkusumo Hospital, Scientific Light Foundation on HIV, Tebet Primary Health Center and Kios Atmajaya University Jakarta
Khamelia Malik (Indonesia)
- 09:10-09:30 Managing heroin dependence syndrome through harm reduction: challenges and opportunity
Hussain Habil (Malaysia)
- 09:30-09:50 Genetic Variation of the μ opioid receptor gene among opioid abuser in Indonesia
Andi J Tantra (Indonesia)



- 08:30-10:00 AsCNP Symposium 14: Understanding cognitive dysfunction in depression
208B Chair: Lingjiang Li (China), Young Hoon Kim (Korea)
- 08:30-08:50 Shortcomings of current antidepressant treatments – is there need for new treatments?
Tianmei Si (China)
- 08:50-09:10 Understanding cognitive dysfunction in depression – clinical picture, prevalence
Roger McIntyre (Canada)
- 09:10-09:30 From experiment to daily practice: clinical research tools for assessing cognitive dysfunction in depressed patients
Barbara Sahakian (UK)
- 09:30-09:50 Clinical evidence for antidepressant effect on cognitive dysfunction – what will multimodal treatments bring to the table?
Phil Cowen (UK)
- 08:30-10:00 AsCNP Symposium 15: Management of antipsychotic-induced side effects in different psychiatric conditions: challenges and research opportunities
209A Chair: Keming Gao (USA), Jingping Zhao (China)
- 08:30-09:00 Indications and Off-label Use of Antipsychotics in Psychiatric Disorders: Evidence and Effect Size
Zuowei Wang (China)
- 09:00-09:30 Treatment of antipsychotic-induced side effects: Focus on weight gain and dyslipidemia
Renrong Wu (China)
- 09:30-10:00 Differential Safety and Tolerability of Antipsychotics in Different Psychiatric Disorders: Focus on Somnolence/Sedation, Extrapyramidal Side Effects, and Weight Gain
Keming Gao (USA)
- 8:30-10:00 S16 The neurobiology of Depression Function Hall A
Chair: Yoon Jin-Sang (Korea)
- 08:30-08:50 Brain Functional Changes in MDD
Bumseok Jeong (Korea)
- 08:50-09:10 Neurofeedback treatment in MDD
Eun-Jin Cheon (Korea)
- 09:10-09:30 Clinical association between depression and medical diseases
Lee Jae-Heon (Korea)
- 09:30-10:00 Neural basis of cognitive behavioral therapy in major depression
Yasumasa Okamoto (Japan)
- 10:20-11:40 AsCNP Plenary Lecture 2 Function Hall A
Chair: Won Myong Bahk (Korea), Toshikazu Saito (Japan)
- 10:20-10:55 ECNP Taskforce on Nomenclature of Psychotropic Drugs
Guy Goodwin (UK)
- 10:55-11:30 Neuropsychological measurements: clinical and cultural implications
Xin Yu (China)
- 11:40-12:00 Closing Ceremony Function Hall A
Chair: Xin Yu (China)



THE 3rd CONGRESS OF ASCNP ASIAN COLLEGE OF NEUROPSYCHOPHARMACOLOGY

Information For Poster Display

The poster area is located on the 4rd level of CNCC. Poster presenters are requested to stay in front of their posters during breaks and lunch time while their posters are on display. Each poster is assigned a unique number, please put up and dismantle your poster according to the following schedule:

Discussion Time: 12:30-14:00 and 15:30-15:50 September 14, 2013

Putting-up: Before 09:00, September 13, 2013

Dismantling: After 16:00, September 13, 2013

On-site staff will be available for assisting with putting-up and dismantling of posters.



Posters

Topic: Addiction

ep010 Demographic and clinical features of Chinese heroin users experiencing the switch from non-injection to injection

Shaojuan Cui(0)

1) Beijing Anding Hospital

ep030 The Effects of Alcohol Abstinence on BDNF, Ghrelin and Leptin Secretions in Alcohol Dependent Patients with Glucose Intolerance

Dai-Jin Kim(0)

1) The Catholic University

ep031 The Changes of Blood Glucose Control and Lipid Profiles after

Dai-Jin Kim(0)

1) The Catholic University

ep033 The Effects of Smoking Cessation on Gene Expression

Dai-Jin Kim(0)

1) The Catholic University

ep068 Association between an opioid receptor-related gene polymorphism and smoking in Japanese

Shinya Kasai(1), Daisuke Nishizawa(1), Junko Hasegawa(1), Naomi Sato(2), Fumihiko Tanioka(3), Haruhiko Sugimura(2), Kazutaka Ikeda(1)

1) Addictive Substance Project, Tokyo Metropolitan Institute of Medical Science, Japan

2) First Department of Pathology, Hamamatsu University School of Medicine, Japan

3) Department of Pathology, Iwata City Hospital, Japan



THE 3rd CONGRESS OF ASCNP ASIAN COLLEGE OF NEUROPSYCHOPHARMACOLOGY

ep091 A self-reported survey on sleep problems in Chinese illicit drug abusers: comparison with non-drug-using controls

Yanhui Liao(1), Quansheng Tang(2), Qijian Deng(1), Guanbai Zhang(3), Chang Qi(1), Hangtao Cui(4), Bin Jiao (5), Xiaogang Chen(1), Wei Hao(1), Tieqiao Liu(1), Jinsong Tang(1)

- 1) Institute of Mental Health, the Second Xiangya Hospital of Central South University
- 2) Nanning Red Cross Hospital
- 3) Yunnan Institute for Drug Abuse
- 4) Department of Psychiatry, Hunan Brain Hospital
- 5) Department of Neurology, Xiangya Hospital, Central South University

ep099 A 12-week randomized, double-blind, placebo-controlled multicenter clinical trial of acamprosate for the treatment of alcohol dependence

SUN Wei(1), LI Bing(1), XU Xiu-feng(2), HUANG Ji-zhong(3), TAN Qing-rong(4), DENG He-huang(5), LI Ke-qing(6), GAO Jun-yu(7), QIU Yu-jia(1)

- 1) Peking University Institute of Mental Health, Key Laboratory of Ministry of Health (Peking University)
- 2) First Affiliated Hospital of Kunming Medical University
- 3) Shanghai Mental Health Center
- 4) First Affiliated Hospital of Fourth Military Medical University
- 5) Guangzhou Psychiatric Hospital
- 6) The Mental Health Center of Hebei Province
- 7) Affiliated Hospital of Academy of Military Medical Sciences

ep100 Distribution of disability attributable to mental and behavioral disorders due to psychoactive substance in China: data of the Second National Sampling Survey on Disability

Yating Ma(1), Yueqin Huang(1), Heng Li(1), Zhaorui Liu(1)

- 1) Institute of Mental Health, Peking University , Key Laboratory of Mental Health, Ministry of Health (Peking University), Beijing 100191, China



ep110 The Role of Early Life Stress as a Predictor for Impulsivity and Severity of Alcohol Dependence

Syung Shick Hwang(1), Chan-Hyung Kim(2), So Youn Kim(3), Se Joo Kim(4)

1) Syung Shick Hwang

2) Chan-Hyung Kim

3) So Youn Kim

4) Se Joo Kim

Topic: Affective disorders and antidepressants

ep008 A comparative study of Addition therapy of Choline Alfoscerate and omega 3fatty acid in older depressed patients with or without executive dysfunction.

kyunghil kwak(1), wooyoung chang(1)

ep016 An Observational Study to Evaluate the Clinical Benefit of Lamotrigine Add-on Therapy in Bipolar Patients in a Naturalistic Treatment Setting

Won-Myong Bahk(1), Young Sup Woo(1), Jong-Hyun Jeong(1), Duk-In Jon(1)

1) Department of Psychiatry, College of Medicine, Hallym University, Anyang, Korea

2) Department of Psychiatry, College of Medicine, The Catholic University of Korea, Seoul, Korea

ep014 Korean Medication Algorithm for Bipolar Disorder 2010: Comparisons with Other Treatment Guidelines

Duk-In Jon(1), Young Sup Woo(1), Won-Myong Bahk(1), Young-myoo Jae(0)

1) Department of Psychiatry, Bongseng Memorial Hospital, Busan, Korea

2) Department of Psychiatry, College of Medicine, Hallym University, Anyang, Korea

3) Department of Psychiatry, College of Medicine, The Catholic University of Korea, Seoul, Korea

ep015 Duloxetine-Induced Burning Paresthesia

Won-Myong Bahk(1), Young Sup Woo(1), Young-Myo Jae(0), Jong-Hyuk Choi(1)

1) Department of Psychiatry, Bongseng Memorial Hospital, Busan, Korea

2) Department of Psychiatry, Chuncheon National hospital, Chuncheon, Korea

3) Department of Psychiatry, College of Medicine, The Catholic University of Korea, Seoul, Korea



THE 3rd CONGRESS OF ASCNP ASIAN COLLEGE OF NEUROPSYCHOPHARMACOLOGY

ep017 One-year rehospitalization rates in patients with first-episode bipolar mania on lithium and valproate with adjunctive atypical antipsychotics

Young Sup Woo(1), Won-Myong Bahk(1), Jong-Hyun Jeong(1), Jong-Hyuk Choi (1)

1) Department of Psychiatry, Chuncheon National hospital, Chuncheon, Korea

2) Department of Psychiatry, College of Medicine, The Catholic University of Korea, Seoul, Korea

ep021 Effectiveness of duloxetine monotherapy compared to combination therapy with other antidepressants in patients with anxiety or depressive disorders : A comparison between male and female patients

Jun-Yeob, Lee(0), Jeong-Kyu, Sakong(1), Eun-Jin, Cheon(3), Sung-Won, Jung(2)

1) CHA Gumi Medical Center, Psychiatry

2) Dongguk University Gyeongju Hospital, Psychiatry

3) Keimyung University Dongsan Medical Center, Psychiatry

4) Yeungnam University Medical Center, Psychiatry

ep029 A Phase II Randomized, Double-Blind, Placebo-Controlled Trial of GLYX-13 for the Rapid Treatment of Major Depressive Disorder using Central Ratings

Danielle Popp(1), Ronald Burch(3), Janet BW Williams(2), Michael J Detke(0)

1) Department of Psychiatry, Indiana University

2) MedAvante, Inc.

3) MedAvante, Inc. Department of Psychiatry, Columbia University

4) Naurex, Inc.

ep034 Atypical Antipsychotics Augmentation in the patients with Major Depressive Disorder

Sang Hoon Kim(1), Sang Hag Park(1), Seung Gon Kim(1), Il Han Choo(1), (1), Hyun Jang(1)

1) Chosun University



- ep054 Sertraline and periodic limb movement during sleep: an 8-week, open-label study in depressed patients with insomnia
Bin Zhang(0), Yanli Hao(1), Fujun Jia(0), Xueli Li(0)
1) Guangdong General Hospital, Guangdong Academy of Medical Sciences, Guangdong Mental Health Centre
2) Department of Human Anatomy, Guang Zhou Medical University
- ep074 The ERBB signaling pathway is associated with susceptibility to subsyndromal symptomatic depression
Xiaoyun Guo(1), Zhenghui Yi(1), Zezhi Li(1), Haozhe Li(1), Chengmei Yuan(1), Wu Hong(1), Zhiguo Wu(1), Daihui Peng(1), Yiru Fang(1)
1) Division of Mood Disorders, Shanghai Mental Health Center, Shanghai Jiao Tong University School of Medicine, Shanghai, China
- ep081 Probabilistic models to distinguish bipolar depressive disorders from major depressive disorder: based on clinical characteristics and past hypomanic symptoms
Chen xiaodong(1), Xu guiyun(1), Lin kanguan(1)
1) Guangzhou psychiatric hospital
- ep082 Clinical features in bipolar patients who have been misdiagnosed
Xu guiyun(1), Chen xiaodong(1)
1) Guangzhou psychiatric hospital
- ep088 Effective connectivity of core emotional brain areas under positive and negative stimulus
Bi Kun(1), Liu Chu(1), Yao Zhi-jian(2), Lu Qing(1)
1) Research Center of Learning Science, Southeast University
2) Academic Department of Psychiatry, Nanjing Brain Hospital, Nanjing Medical University



THE 3rd CONGRESS OF ASCNP ASIAN COLLEGE OF NEUROPSYCHOPHARMACOLOGY

ep101 The association of insight with clinical symptoms in depressive patients

Qing Chang(1), Yufen Ou(1), Li Liang(1), Yuanfei Wu(1), Yuwei Chen(1), Yuping Ning(1), Hongbo He(1)

1) The association of insight with clinical symptoms in depressive patients

ep123 Clinical association between depression and medical disease

Jae-Hon Lee, MD(1), Sung Keun Park, MD(1)

1) Total Health Care Center, Kangbuk Samsung Hospital, Sungkyunkwan University

ep128 LncRNAs Expression profiles and Co-expression Network Revealed in Major Depressive Disorder by Microarray

Xinrong Li(1), Zhifen liu(1), Yaqin Meng(1), Ning Sun(1), Yong Xu(1), Kerang Zhang(1)

1) Department of Psychiatry, First Hospital of Shanxi Medical University

ep131 Alteration of platelet BDNF release function in the peripheral blood: Implications of alcohol and antidepressant

Toshikazu Saito(1), Eri Hashimoto(1), Wataru Ukai(1), Takao Ishii(1), Yoshiyasu Kigawa(1), Kengo Furuse(1),

Hanako Tsujino(1), Seiju Kobayashi(1), Toshihiro Yoshinaga(1)

1) Department of Neuropsychiatry, Sapporo Medical University, School of Medicine

ep132 Frequency of Undiagnosed Bipolar Disorder under Three Definitions in Chinese Patients with Current Depressive Episode (BRIDGE-CN)

Ma Yan-tao(1), Yu Xin(1), Wei Jing(2), Zheng Yi(3), Zhang Jin-bei(4), Mei Qi-yi(5), Zhang Xin-bao(6), Liu Tie-bang(7),

Miao Guo-dong(8), Gao Cheng-ge(9), Meng Qing-hua(10), Xu Xiu-feng(11), Tian Hong-jun(12), Sun Xue-li(13),

Liu Ying(14), Chen Zhi-yu(15), Wu Wen-yuan(16), Jiang Kai-da(17), Ji Jian-lin(18), Wang Guan-jun(19),

Lin li(20), Byron Good(21)

1) Key Laboratory of Mental Health, Ministry of Mental Health (Peking University). Peking University Institute of Mental Health, Beijing, 100191

2) Beijing Union Hospital, Union Medical University

3) Beijing Anding Hospital, Capital Medical University

4) 3rd Hospital of Zhongshan Medical University

5) Suzhou Guangji Hospital



- 6) Nanjing Brain Hospital
- 7) Shenzhen Mental Health Centre, Guangdong province
- 8) Guangzhou Psychiatry Hospital
- 9) 1st Hospital of Xian Jiaotong University
- 10) 1st Hospital of Chongqing Medical University
- 11) 1st Hospital of Kunming Medical University
- 12) Tianjing Anding Hospital
- 13) Huaxi Hospital of Sichuan University
- 14) 1st Hospital of China Medical University
- 15) Hangzhou 7th Hospital
- 16) Shanghai Tongji Hospital, Tongji University Medical School, Shanghai
- 17) Shanghai Mental Health Center, Shanghai Jiao Tong University School of Medicine
- 18) Shanghai Zhongshan Hospital
- 19) Qingdao 7th People Hospital
- 20) Fuzhou Psychiatry Hospital
- 21) Department of Global Health and Social Medicine, Harvard Medical School

Topic: Animal models

ep002 Norepinephrine within a restrict time window after extinction promotes the long term persistence of extinguished fear

Ning Chai (1), Xueyi Wang(1)

- 1) Department of Psychiatry, the First Hospital of Hebei Medical University

ep028 The mRNA and miRNA Expression of Dopamine Related Genes in the Rats with Chronic Stress

Zhang Yanhua(2), Yu Shunyong(2), Sheng Yifeng(1), Li Huafang(2)

- 1) Department of Psychiatry, Fudan University
- 2) Mental Health Institute, Shanghai Jiaotong University



THE 3rd CONGRESS OF ASCNP ASIAN COLLEGE OF NEUROPSYCHOPHARMACOLOGY

ep038 COCAINE SENSITIZATION REQUIRES RAPHE SEROTONERGIC NEURONS ACTIVITY; A STUDY USING DESIGNER RECEPTORS EXCLUSIVELY ACTIVATED DESIGNER DRUGS

Hidehiro Oshibuchi(1)

ep044 ST101, a novel cognitive enhancer stimulates CaMKII and PKC activities in the cognition-related brain regions in schizophrenia model rats.

Yasushi Yabuki(0), Osamu Nakagawasai(1), Kohji Fukunaga(0)

- 1) Department of Pharmacology, Graduate School of Pharmaceutical Sciences, Tohoku University, Sendai, Japan
- 2) Department of Pharmacology, Tohoku Pharmaceutical University, Sendai, Japan

ep047 The Effect of Fluoxetine on Behaviors in Transient Forebrain Ischemic model in Gerbil

Do Hoon Kim(1), Do Hoon Kim(1)

ep071 Causal role of unregulated mTOR signaling in autism-related behavioral deficits in mouse models of tuberous sclerosis complex

Atsushi Sato(1;2;3), Shinya Kasai(1), Toshiyuki Kobayashi(4), Yukio Takamatsu(1), Okio Hino(4), Kazutaka Ikeda(1), Masashi Mizuguchi(3)

- 1) Addictive Substance Project, Tokyo Metropolitan Institute of Medical Science
- 2) Department of Pediatrics, Graduate School of Medicine, The University of Tokyo
- 3) Department of Developmental Medical Sciences, Graduate School of Medicine, The University of Tokyo
- 4) Department of Molecular Pathogenesis, Graduate School of Medicine, Juntendo University

ep075 Critical period of inhibitory effect of methylphenidate on hyperactivity in dopamine transporter knockout mice

Yukio Takamatsu(1), Yumiko Kubo(2), Sarah Yukie Nagasawa(1;4), George R. Uhl(5), Ichiro Sora(2;3), Kazutaka Ikeda(1)

- 1) Addictive Substance Project, Tokyo Metropolitan Institute of Medical Science
- 2) Department of Biological Psychiatry, Tohoku University Graduate School of Medicine
- 3) Department of Psychiatry, Kobe University Graduate School of Medicine
- 4) Department of Developmental Medical Sciences, Graduate School of Medicine, The University of Tokyo
- 5) Molecular Neurobiology Branch, Intramural Research Program, National Institute on Drug Abuse, NIH/DHHS



ep083 Altered emotional behavior and dopaminergic functions in Reelin Orleans mice

Wei Shan(1), Taku Nagai(1), Umi Fukaya(1), Md. Ali-Bin-Saifullah(1), Kiyofumi Yamada(1)

1) Department of Neuropsychopharmacology and Hospital Pharmacy, Nagoya University Graduate School of Medicine, 466-8560 Japan

ep096 The Influences of Light Therapy on Behavioral and Physiological Indicators and the Rhythm of Melatonin Secretion of SD Rats in the Chronic Stress Model

Tianhang Zhou(1), Xin Yu(1), Guoyi Zhang(2), Weimin Dang(1), Yongzhi Wang(2), Tianmei Si(1), Jian Lin(3),

Yantao Ma(1), Li Zhao(4), Jitao Li(1), Kuo Zhang(6), Cantao Zhong(2), Zhongkai He(2), Rongfeng Niu(5), Wei Wei(2)

1) Institute of Mental Health, Peking University

2) School of Physics, Peking University

3) Guangdong Prevention and Treatment Center for Occupational Diseases

4) The Third Hospital of Peking University

5) School of Life Science, Peking University

6) Department of Laboratory Animal Science, Peking University

ep120 Impaired working memory by repeated neonatal MK-801 treatment is ameliorated by galantamine in adult rats

Yun-Ai Su(1;2), Run-Hu Huang(1;2), Ji-Tao Li(1;2), Xiao-Dong Wang(1;2), Tian-Mei Si(1;2)

1) Institute of Mental Health, Peking University, Beijing, China

2) Key Laboratory of Mental Health, Ministry of Health (Peking University) , Beijing, PR China

Topic: Anxiety disorders and anxiolytics

ep022 Plasma oxytocin levels and social anxiety in patients with social anxiety disorder.

Kang Seob Oh(1), Hyemin Kim(1), Sewon Lim(1), Jeong-Kyu Sakong(0)

1) Dongguk University

2) Sungkyunkwan University

ep039 Threat induced autonomic dysregulation in panic disorder evidenced by heart rate variability measures

Sheng-Min Wang(1), Chung Tai Lee(1), Jeong-Ho Chae(1), Sheng-Min Wang(1), Chung Tai Lee(1), Jeong-Ho Chae(1), (1)

1) Department of Psychiatry, College of Medicine, The Catholic University of Korea, Seoul, Korea



THE 3rd CONGRESS OF ASCNP ASIAN COLLEGE OF NEUROPSYCHOPHARMACOLOGY

ep092 A self-report survey on life events, anxiety and depression among the emergency department staffs in Changsha, China
Hongliang Zhang(1), Yamin Li(1), Zhijuan Feng(2), Shubao Chen(2), Tieqiao Liu(2), Xiaogang Chen(2),
Jinsong Tang(2), Yanhui Liao(2)

1) Department of Emergency, the Second Xiangya Hospital of Central South University

2) Institute of Mental Health, the Second Xiangya Hospital of Central South University

ep098 The Study of electroencephalogram non-linear dynamics on patients with generalized anxiety disorder

Yiming Wang(1), Fangxian Chai(1), Xingde Liu(1)

1) Yiming Wang

ep121 Insight in patients with manic disorder

Li Liang(1), Changqing(1), Yufen Ou(1), Yuanfei Wu(1), Yuwei Chen(1), Yuping Ning(1), Hongbo He(1)

1) Guangzhou Psychiatric Hospital

Topic: Child and adolescent disorders

ep006 Facial Emotion Recognition in Children with Attention Deficit Hyperactivity Disorder

Byeong Moo Choe(0), Jae Hong Park(0)

1) Byeong Moo Choe

ep111 Effect of Parents' Personality Traits and Family Environment on Children's Depressive Symptoms: A Cross-Sectional Survey from Chongqing China

Li Lei(1), Lian Du(1), Pinghong Chen(1), Hui Wang(1), Na Yong(1), Zhili Zou(1), Ting Wang(1), Huaqing Meng(1), Hua Hu(1)

1) Department of Psychiatry, the First Affiliated Hospital of Chongqing Medical University, No. 1, Youyi Road, Yuzhong district of Chongqing 400016, China.

ep124 Prevalence and Distribution of Disability Attributed to Autism Spectrum Disorders in Children and Adolescents in China
Ning Ji(1), Yue-qin Huang(1), Ya-ting Ma(1), Heng Li(1), Zhao-rui Liu(1), Yun-tao Liu(1)

1) Peking University Key Laboratory of Mental Health, Ministry of Health (Peking University)



Topic: Dementia and neurological disorders

ep001 Association between sleep and mild cognitive impairment in elderly people Running title: Effects of sleep on cognitive function

Cuixia An (0), Lulu Yu(0), Minwei Wang (1), Xueyi Wang (1)

1) Department of Psychiatry, the First Hospital of Hebei Medical UniversityThe Mental Health Institute of Hebei Medical University

2) Hebei Brain Ageing and Cognitive Neuroscience LaboratoryDepartment of Internal Neurology, the First Hospital of Hebei Medical University

ep004 Increased prevalence of clinical depression in elderly Chinese subjects with cardiovascular diseases

Mei Song (1), Yumei Wang(1), Shunjiang Xu (1), Xueyi Wang(1)

1) Department of Psychiatry, the First Hospital of Hebei Medical University

ep007 Oral Anti-Diabetic Medications in Relation to Dementia

Chin Cheng(1), Ching-Heng Lin(2), Tsuo-Hung Lan(0)

1) Department of Psychiatry, National Yang-Ming UniversityDepartment of Psychiatry, National Yang-Ming University

2) Department of Public Health and Primary Care, University of CambridgeDepartment of Public Health and Primary Care, University of Cambridge

3) Department of Research, Taichung Veterans General HospitalDepartment of Research, Taichung Veterans General Hospital

Topic: Dementia and neurological disorders

ep023 The effects of albumin and white matter hyperintensity on cognitive function in the elderly

Kang Soo Lee(1), Sang Joon Son(2), Chang Hyung Hong(0)

1) AJou university

2) CHA university

3) Myoungji Hospital



THE 3rd CONGRESS OF ASCNP ASIAN COLLEGE OF NEUROPSYCHOPHARMACOLOGY

Topic: Genetics

ep058 Association study of 42 SNPs within 10 candidate genes for mood disorders

Chi-Un Pae(0)

1) CUMC

ep097 Obsessive-compulsive Personality Disorder and SLC6A4 genetic predisposition in University Freshmen

Qi Guo(1), Yueqin Huang(2), Hong Wang(3), Yuedan Wang(1), Qinghua Cui(1)

1) School of Basic Medical Sciences , Peking University, Beijing 100191, China

2) Institute of Mental Health, Peking University; Key Laboratory of Mental Health, Ministry of Health (Peking University), Beijing 100191,China

3) School of Public Health, Peking University, Beijing 100191, China

ep125 The expression of related molecules on Notch signal pathway in peripheral blood with Major Depression

Ning Sun(1), Yong Xu(1), Xinrong Li(1), Lei Lei(1), Suping Li(1), Kerang Zhang(1)

1) Department of Psychiatry, First Hospital of Shanxi Medical University

ep005 Comparison of plasma neuregulin 1 immunoreactivity in control subjects and patients with distinct psychiatric diseases

Ran Wang(1), Lulu Yu(1), Lan Wang(1), Xueyi Wang(1)

1) Department of Psychiatry, the First Hospital of Hebei Medical University

Topic: Molecular neurobiology/pharmacology

ep009 A New Screening Method of Antipsychotic Chinese Herbal Active Ingredients

Yan Zhang(0), Jianguo Shi(0), Feihu Liu(0)

1) Xi'an Institute of Mental Health, Xi'an, Shaanxi, China
The Affiliated Mental Health Institute of Xi'an School of Medicine, Xi'an, Shaanxi, China.



Topic: Molecular neurobiology/pharmacology

ep018 Lithium stimulates chemokine production in monocytic cells

Zhiqian Yu(1;2), Chiaki Ono(1;2), Ichiro Sora(3), Hiroaki Tomita(1;2)

1) Department of Disaster Psychiatry, IRIDeS Tohoku University

2) Tohoku Medical Megabank Organization, Tohoku University

3) Department of Biological Psychiatry, Graduate School of Medicine, Tohoku University

ep059 Effects of Mood Stabilizers on Synaptic Protein Levels and Dendritic Outgrowth in Hippocampal Neuronal Cultures

Hye Yeon Jo (1), Chan Hong Lee(1), Mi Kyoung Seo(1), Le Hoa Nhu(3), Jung Goo Lee (1;2;3), Bong Ju Lee(2),

Wongi Seol (4), Sung Woo Park (1;3), Young Hoon Kim (1;2;3)

1) Paik Institute for Clinical Research, Inje University, Busan, Republic of Korea.

2) Department of Psychiatry, School of Medicine, Haeundae Paik Hospital, Inje University, Busan, Republic of Korea. Neuroscience, Health Science & Technology, Inje University, Busan, Republic of Korea.

3) Neuroscience, Health Science & Technology, Inje University, Busan, Republic of Korea.

4) InAm Neuroscience Research Center, Wonkwang University, Sanbon Hospital, Gunpo, Republic of Korea.

ep060 Effects of Antipsychotic Drugs on the Expression of Synaptic-associated Proteins in the Frontal Cortex of Rats Subjected to Immobilization Stress

Chan Hong Lee (1), Mi kyoung Seo(1), Hye Yeon Jo(1), Cheol Min Choi (3), Jung Goo Lee(1;2;3), Bong Ju Lee(2),

Sung Woo Park (1;3), Young Hoon Kim (1;2;3)

1) Paik Institute for Clinical Research, Inje University, Busan, Republic of Korea.

2) Department of Psychiatry, School of Medicine, Haeundae Paik Hospital, Inje University, Busan, Republic of Korea

3) Neuroscience, Health Science & Technology, Inje University, Busan, Republic of Korea.



THE 3rd CONGRESS OF ASCNP ASIAN COLLEGE OF NEUROPSYCHOPHARMACOLOGY

ep061 Effects of Antidepressant Drugs on Synaptic Protein Levels and Dendritic Outgrowth in Hippocampal Neuronal Cultures

Mi Kyoung Seo (1), Chan Hong Lee (1), Hye Yeon Jo(1), Ji Eun Kim (2), Jung Goo Lee (1;2), Bong Ju Lee (2),
Wongi Seol (3), Sung Woo Park (1), Young Hoon Kim (1;2)

1) Paik Institute for Clinical Research, Inje University, Busan, Republic of Korea.

2) Department of Psychiatry, School of Medicine, Haeundae Paik Hospital, Inje University, Busan, Republic of Korea.

3) InAm Neuroscience Research Center, Wonkwang University, Sanbon Hospital, Gunpo, Republic of Korea.

ep062 Differential Effects of Antidepressant Drugs on mTOR Signaling in Rat Hippocampal Neurons

Sung Woo Park (1), Mi Kyoung Seo (1), Chan Hong Lee (1), Hye Yeon Jo (1), Bong Ju Lee(2), Wongi Seol (3),
Jung Goo Lee (1;2), Young Hoon Kim (1;2)

1) Paik Institute for Clinical Research, Inje University, Busan, Republic of Korea.

2) Department of Psychiatry, School of Medicine, Haeundae Paik Hospital, Inje University, Busan, Republic of Korea.

3) InAm Neuroscience Research Center, Wonkwang University, Sanbon Hospital, Gunpo, Republic of Korea

ep063 Effects of Tianeptine on mTOR Signaling in Rat Hippocampal Neurons

Mi Kyoung Seo (1), Chan Hong Lee (1), Hye Yeon Cho (1), Nguyen Ngoc Ly (3), Sung Woo Park (1;3),
Bong Ju Lee(2), Wongi Seol (4), Jung Goo Lee (1;2;3), Young Hoon Kim (1;2;3)

1) Paik Institute for Clinical Research, Inje University, Busan, Republic of Korea.

2) Department of Psychiatry, School of Medicine, Haeundae Paik Hospital, Inje University, Busan, Republic of Korea.
Neuroscience, Health Science & Technology, Inje University, Busan, Republic of Korea.

3) Neuroscience, Health Science & Technology, Inje University, Busan, Republic of Korea.

4) InAm Neuroscience Research Center, Wonkwang University, Sanbon Hospital, Gunpo, Republic of Korea

ep076 Differential regulation of haloperidol and olanzapine on JAK2/STAT3 pathway in rat prefrontal cortex

Chongsheng SONG(1;2), Mei HAN(2;3), HongQin WANG(2), Xu-Feng HUANG(2;3)

1) Beijing Huilongguan Hospital

2) University of Wollongong, Wollongong, NSW, 2522, Australia

3) Schizophrenia Research Institute, Sydney, NSW, 2010, Australia



ep087 Anxiolytic effects of mirtazapine microinjection in the median raphe nucleus and subchronic lithium carbonate enhances this effect

Yan An(1), Takeshi Inoue(1), Yuji Kitaichi(1), Takeshi Izumi(1), Shin Nakagawa(1), Nin Song(1), Chong Chen(1), Ichiro Kusumi(1)

1) Department of Psychiatry, Hokkaido University Graduate School of Medicine

ep122 PACAP induces internalization of serotonin 2A receptor in a protein kinase C-dependent manner

Atsuko Hayata(1;2), Naoki Encho(1), Keita Moriguchi(1), Tomohiro Fujino(1), Norihito Shintani(1), Atsushi Kasai(1;3), Akemichi Baba(4), Hitoshi Hashimoto(1;2;5)

1) Laboratory of Molecular Neuropharmacology, Graduate School of Pharmaceutical Sciences, Osaka University, Osaka, Japan

2) United Graduate School of Child Development, Osaka University, Osaka, Japan

3) Institute for Academic Initiatives, Osaka University, Osaka, Japan

4) Hyogo University of Health Science, Kobe, Japan

5) iPS Cell-based Research Project on Brain Neuropharmacology and Toxicology, Osaka University, Osaka, Japan

Topic: Neuroimaging

ep065 Amplitude of low frequency fluctuation in female depressed patients and its relationship with the severity of depressive symptoms: an resting-state fMRI study

YAN Rui(1), YAO Zhi-jian(1), WEI Mao-bin(2), TANG Hao(1), CHENG Jian-huai(1), Hua Ling-ling(1), LU Qing(2)

1) Academic Department of Psychiatry, Nanjing Brain Hospital, Nanjing Medical University

2) Research Center of Learning Science, Southeast University

ep067 Predicting Dopamine D2 Receptor Occupancy Following Antipsychotic Dose Reduction: A Pilot PET Study

Hiroyuki Uchida(1;2), Robert R. Bies(2;3), Takefumi Suzuki(1), Ariel Graff-Guerrero(2),

Bruce G. Pollock(2), Benoit H. Mulsant(2), David C. Mamo(2)

1) Dept. of Neuropsychiatry, Keio University School of Medicine, Tokyo, Japan

2) Geriatric Mental Health Program, Centre for Addiction and Mental Health, Toronto, Canada

3) Indiana University School of Medicine, Division of Clinical Pharmacology, Indianapolis, USA



THE 3rd CONGRESS OF ASCNP ASIAN COLLEGE OF NEUROPSYCHOPHARMACOLOGY

ep084 Predicting brain occupancy from plasma level by combining pharmacokinetics with pharmacodynamics

Euitae Kim(1)

1) Seoul National University Bundang Hospital, Department of Neuropsychiatry

ep089 Structural and functional connectivity of depression between the left amygdala and left dorsolateral prefrontal cortex under negative stimulus

Bi Kun(1), Liu Chu(1), Yao Zhi-jian(2), Lu Qing(1)

1) Research Center of Learning Science, Southeast University

2) Academic Department of Psychiatry, Nanjing Brain Hospital, Nanjing Medical University

ep090 Functional magnetic resonance imaging study of Ketamine cue, smoking cue and erotic cue induced brain activation in ketamine users, cigarette smokers and healthy controls

Yanhui Liao(1), Jinsong Tang(1), Jianbin Liu(2), Mei Yang(3), Mingdong Ma(4), Xuyi Wang(1), Tieqiao Liu(1), Xiaogang Chen(1), Hongxian Chen(1), Qijian Deng(1), Xiaojun Xiang(1), Paul C. Fletcher(5), Wei Hao(1)

1) Mental Health Institute, the Second Xiangya Hospital of Central South University

2) Department of Radiology, The People's Hospital of Hunan Province

3) Department of Addiction Medicine, Hunan Brain Hospital

4) Kangda Voluntary Drug Rehabilitation Centers

5) University of Cambridge, Department of Psychiatry, Addenbrooke's Hospital

ep127 Reduced Gray Matter Volumes of Violent Schizophrenia

Liu Jian-mei(1;2), Shen Dan-lin(1), Lv Pan(1), Hu Jun-mei(1)

1) Department of Forensic Psychiatry, West China School of Preclinical and Forensic Medicine, Sichuan University

2) Department of Student Affairs, Sichuan Vocational and Technical College of Communication

ep093 Interaction of Resting-state Networks in Major Depressive Disorder

Maobin Wei (1), Rui Yan (2), Zhijian Yao (2), Qing Lu (1)

1) Research Center of Learning Science, Southeast University, 2 sipailou, Nanjing 210096, China

2) Academic Department of Psychiatry, Nanjing Brain Hospital, Nanjing Medical University, 249 Guangzhou Road, Nanjing 210029, China



ep094 The Betweenness Centrality of White Matter Structural Networks in Depression

Jiaolong Qin(1), Jianhuai Chen(2), Hao Tang(2), Rui Yan(2), Zhijian Yao(2), Qing Lu(1)

1) Research Center of Learning Science, Southeast University, 2 sipailou, Nanjing 210096, China

2) Academic Department of Psychiatry, Nanjing Brain Hospital, Nanjing Medical University, 249 Guangzhou Road, Nanjing 210029, China

ep095 The Betweenness Centrality of White Matter Structural Networks in Schizophrenia

Jiaolong Qin(1), Jianhuai Chen(2), Rui Yan(2), Hao Tang(2), Zhijian Yao(2), Qing Lu(1)

1) Research Center of Learning Science, Southeast University, 2 sipailou, Nanjing 210096, China

2) Academic Department of Psychiatry, Nanjing Brain Hospital, Nanjing Medical University, 249 Guangzhou Road, Nanjing 210029, China

ep109 Decreased neurophysiologic connectivity in resting-state of female, first-episode major depressive disorder

TANG Hao(1), LIU Chu(2), YAN Rui(1), LU Qing(2), YAO Zhi-jian(1)

1) Affiliated Nanjing Brain Hospital of Nanjing Medical University

2) Research Center of Learning Science, Southeast University

ep105 The Betweenness Centrality of Nodes in Weighted Structural Cortical Networks in Schizophrenic patients

CHEN Jian-Huai(1), YAO Zhi-jian(1), QIN Jiao-Long(2), LU Qing(2)

1) Academic Department of Psychiatry, Nanjing Brain Hospital, Nanjing Medical University

2) Research Center of Learning Science, Southeast University

ep106 The Global Efficiency in Structural Cortical Networks of Schizophrenia

CHEN Jian-Huai(1), YAO Zhi-jian(1), QIN Jiao-Long(2), LU Qing(2)

1) Academic Department of Psychiatry, Nanjing Brain Hospital, Nanjing Medical University

2) Research Center of Learning Science, Southeast University



THE 3rd CONGRESS OF ASCNP ASIAN COLLEGE OF NEUROPSYCHOPHARMACOLOGY

ep107 The Topological Efficiency in Structural Cortical Networks of Depression

CHEN Jian-Huai(1), YAO Zhi-jian(1), QIN Jiao-Long(2), LU Qing(2)

1) Academic Department of Psychiatry, Nanjing Brain Hospital, Nanjing Medical University

2) Research Center of Learning Science, Southeast University

ep108 The abnormal effective connections of prefrontal-amygdala during major depressive patients recognizing happy face

Hua Ling-ling (1), Li Hao-ran(2), Tang Hao(3), Lu Qing(2), Yao Zhi-jian(1;3)

1) Nanjing University

2) Southeast University

3) Academic Department of Psychiatry, Nanjing Brain Hospital, Nanjing Medical University

ep126 A Combined Study of GSK3 β polymorphisms and brain network topological metrics in major depressive disorder

Zhifen liu(1), Hao Guo(2), Xiaohua Cao(1), Chunxia Yang(1), Chen Xu(3), Jianying Li(1), Aixia Zhang(1),

Kerang Zhang(1)

1) Department of Psychiatry, First Hospital of Shanxi Medical University

2) College of Computer Science and Technology, Taiyuan University of Technology

3) Department of Radiology, Shanxi Provincial Hospital

ep129 White Matter Abnormalities in Medication-naïve Adults with Major Depressive Disorder: Tract-based Spatial Statistical Analysis

Aixia Zhang(1), Cheng Xu(2), Xi-Nian Zuo(3), Qiang Gao(2), Yangfang Wang(1), Xia Li(4), Zhifen Liu(1),

Xiaohua Cao(1), Kerang Zhang(1)

1) Department of Psychiatry, First Hospital of Shanxi Medical University, Taiyuan

2) Department of Magnetic Resonance Imaging, People's Hospital of Shanxi Province, Taiyuan

3) Key Laboratory of Behavioral Science, Institute of Psychology, Chinese Academy of Sciences, Beijing

4) Department of Psychiatry, Shanxi Corps Hospital of Chinese People's Armed Police Forces, Taiyuan



Topic: Neurophysiology

ep102 Near-infrared spectroscopy for examination of prefrontal activation during cognitive tasks in patients with major depressive disorder: A meta-analysis of observational studies

Zhang Huijun(1), Dong Wentian(1), Dang Weimin(1), Quan Wenxiang(1), Tian Ju(1), Chen Ru(2), Yu Xin(1)

1) Peking University Sixth Hospital

2) Department of Epidemiology and Biostatistics, School of Public Health, Peking University Health Science Center

ep103 Effective connectivity by rapid interactions between amygdala and visual cortex

Chu Liu(1), Kun Bi(1), Qing Lu(1), Zhijian Yao(2)

1) Research Center of Learning Science, Southeast University, 2 sipailou, Nanjing 210096, China

2) Academic Department of Psychiatry, Nanjing Brain Hospital, Nanjing Medical University, 249 Guangzhou Road, Nanjing 210029, China

Topic: Non-pharmacological Biological intervention (ECT, TMS, etc.)

ep003 Controlled study of repetitive transcranial magnetic stimulation combined with paroxetine for first-episode depression in Chinese

Ning Li (1), YumeiWang(1), Mei Song (1), Xueyi Wang (1)

1) Department of Psychiatry, the First Hospital of Hebei Medical University

ep025 Korean Medication Algorithm for Depressive Disorder(VI) : Non-pharmacological Biological Treatments

Jong-Hyun Jeong(1), Joo Eon Park(2), Duk-In Jon(3), Kyoung Joom Min(0), Kyoung Joon Min(4)

1) Department of Psychiatry, St. Vincent's Hospital, The Catholic University of Korea, Suwon, Korea

2) Keyo Hospital, Uiwang, Korea

3) Department of Psychiatry, Sacred Heart Hospital, College of Medicine, Hallym University, Anyang, Korea

4) Department of Psychiatry, College of Medicine, Chung-Ang University, Seoul, Korea



THE 3rd CONGRESS OF ASCNP ASIAN COLLEGE OF NEUROPSYCHOPHARMACOLOGY

ep056 An Event-related potentials research on high-frequency repetitive transcranial magnetic stimulation in the treatment of mild cognitive impairment

Linlin Yang(1), Keyan Han(1), Xueyi Wang(0)

1) Department of Psychiatry,

2) Department of Psychiatry, the First Hospital of Hebei Medical University

ep079 Optimization of Treatment for Major Depressive Disorder by Repetitive Transcranial Magnetic Stimulation

Xiaoyan Ma(1), Yueqin Huang(1), Yi Jin(1), Zhaorui Liu(1)

1) Institute of Mental Health, Peking University

Topic: Pharmacogenetics / pharmakinetics

ep133 Pharmacokinetic study of bitopertin, a glycine reuptake inhibitor, in Chinese healthy volunteers

John (Suoping) Zhai, Haiyan Li(1), Alice Wang, Meret Martin-Facklam, Rose Luo(9),

Alice Wang, Meret Martin-Facklam, Rose Luo (1)

1) 14. Pharmacogenetics/pharmakinetics

Topic: Post Traumatic Stress disorder/Obsessive-Compulsive Disorders

ep055 Change on clinical symptoms and personality traits with posttraumatic stress disorder patients of childhood traumatic experience

Yuanyuan Gao(1), Guixing Jin(1), Xueyi Wang(1), Cuixia An (1), Lan Wang(1), (1), (1), (1)

1) Department of Psychiatry,

2) Department of Psychiatry, the First Hospital of Hebei Medical University



Topic: Psychotic disorders and antipsychotics

ep024 A survey of attitude towards long-acting injectable antipsychotic agents in patients with first-episode psychosis and multiple-episode psychosis

Young-Chul Chung(0), Jin-Mahn Jang (1), Hong-mae Kim (2), Min-gul Kim(2), Nam-in Kang MD(1), Jong-Il Park MD(1)

1) 1Department of Psychiatry, Chonbuk National University Medical School, Jeonju, Korea
2Research Institute of Clinical Medicine of Chonbuk National University-Biomedical Research Institute of Chonbuk National University Hospital, Jeonju, Korea

2) Department of Psychiatry, Chonbuk National University Medical School, Jeonju, Korea

3) Research Institute of Clinical Medicine of Chonbuk National University-Biomedical Research Institute of Chonbuk National University Hospital, Jeonju, Korea

ep027 Contingent negative variation in first episode deficit and non-deficit schizophrenia

LI Zhe(0), DENG Wei(0), ZHENG Zhong(0), LI Tao(0)

1) The Mental Health Center, West China Hospital, Sichuan University

ep080 Polypharmacy to Counteract Antipsychotic-Induced Metabolic Adverse Effects in Schizophrenia: A Systematic Review and Meta-analysis

Yuya Mizuno(1), Takefumi Suzuki(1;2), Atsuo Nakagawa(1;3), Masaru Mimura(1), W. Wolfgang Fleischhacker(4), Hiroyuki Uchida(1;5)

1) Department of Neuropsychiatry, Keio University School of Medicine

2) Department of Psychiatry, Inokashira Hospital

3) Center for Clinical Research, Keio University School of Medicine

4) Department of Psychiatry and Psychotherapy, Medical University Innsbruck

5) Geriatric Mental Health Program, Centre for Addiction and Mental Health



THE 3rd CONGRESS OF ASCNP ASIAN COLLEGE OF NEUROPSYCHOPHARMACOLOGY

ep046 Mismatch negativity is a stronger indicator of functional outcomes than neurocognition or theory of mind in patients with schizophrenia

Seung-Hwan Lee(0)

1) Inje University

ep073 Antipsychotics Prescribing Patterns of Patients with First-episode Schizophrenia in Korea:

A comparison of 2005 and 2010

Daeyoung Roh(1), Jhin-Goo Chang(1), Sung Kil Min(2), Chan-Hyung Kim(1;2)

1) Severence Mental health Hospital

2) Institute of Behavioral Science in Medicine, Yonsei University College of Medicine, Korea

ep077 Insight in Schizophrenia: Comparison of Symptomatology in China and the US

Somaia Mohamed(1), Robert Rosenheck(1), Yuping Ning(2), Hongbo He(2)

1) Yale Medical School

2) Guangzhou Psychiatric Hospital

ep085 The association of insight with clinical symptoms and therapeutic side effects in patients with schizophrenia

Jie Zhang(1), Robert Rosenheck(2), Somaia Mohamed(2), Yanling Zhou(1), Yingmei Chen(1), Weijie Huang(1),

Yuping Ning(1), Hongbo He(1)

1) Guangzhou Psychiatric Hospital, Guangzhou, China;

2) Yale Medical School, New Haven, CT, USA

ep104 Differences of clinical symptoms, insight, and treatment compliance between first and multiple hospitalized schizophrenic patients

Yingmei Chen(1), Yanling Zhou(1), Jie Zhang(1), Weijie Huang(1), Yuwei Chen(1), Yuping Ning(1), Hongbo He(1)

1) Guangzhou Psychiatric Hospital, Guangzhou, China



ep116 Long Acting Injectable vs. Oral Antipsychotics in Schizophrenia: A Systematic Review and Meta-Analysis of Cohort Studies

Taishiro Kishimoto(1;2;3;4), Masahiro Nitta(2), Masaru Mimura(1), John M. Kane(2;3;4;5), Christoph U. Correll(2;3;4;5)

- 1) Keio University School of Medicine, Tokyo, Japan
- 2) The Zucker Hillside Hospital, Glen Oaks, NY, USA
- 3) Hofstra North Shore-LIJ School of Medicine, Hempstead, NY, USA
- 4) Feinstein Institute of Medical Research, Manhasset, NY, USA
- 5) Albert Einstein College of Medicine, Bronx, NY, USA

ep112 Abnormal involuntary movement and estimated dopamine D2 receptor occupancy in patients with schizophrenia:

Analysis of the CATIE data

Kazunari Yoshida(1), Robert R. Bies(2;3;4), Takefumi Suzuki(1;6), Bruce G. Pollock(2;5), Ryosuke Tarumi(1), Masaru Mimura(1), Hiroyuki Uchida(1;2)

- 1) Department of Neuropsychiatry, Keio University School of Medicine, Tokyo, Japan
- 2) Geriatric Mental Health Program, Centre for Addiction and Mental Health, Toronto, ON, Canada
- 3) Division of Clinical Pharmacology, Indiana University School of Medicine, Indianapolis, IN, USA
- 4) Indiana Clinical and Translational Sciences Institute, Indianapolis, IN, USA
- 5) Department of Psychiatry, University of Toronto, Toronto, ON, Canada
- 6) Department of Psychiatry, Inokashira Hospital, Tokyo, Japan

ep118 Correlation between medication adherence and quality of life among schizophrenic patients

Xuehua Yan(1), Yue Zou(1), Xiaozhen Su(1), Zhaojun Huang(1), Jieying Zhu(1), Yuping Ning(2), Hongbo He(2)

- 1) Department of Nursing, Guangzhou Psychiatric Hospital, Guangzhou
- 2) Neuropsychiatric Research Institute, Guangzhou Psychiatric Hospital, Guangzhou



THE 3rd CONGRESS OF ASCNP ASIAN COLLEGE OF NEUROPSYCHOPHARMACOLOGY

Topic: Women's mental health

ep130 Alterations of the cortisol awakening response and DHEA in postpartum depression

Ho-Suk Suh(1), Ryun-Sup Ahn(2), Chan-Hyung Kim(3), Yong-Koo Kim(4)

1) School of Medicine CHA University, Dept. of Psychiatry, Seoul, South-Korea

2) Graduate School of Complementary Alternative Medicine CHA University, Dept. of Endocrinology, Seoul, South-Korea

3) Yonsei University College of Medicine, Dept. of Psychiatry, Seoul, South-Korea

4) Korea University College of Medicine, Dept. of Psychiatry, Seoul, South-Korea

Topic: Others

ep036 Determinants of suicidal ideation in patients with breast cancer

Jin-Sang Yoon(1), Young-Woo Park(2), Jae-Min Kim(1), Ji-Eun Jang(1)

1) Department of Psychiatry, Chonnam National University Medical School, and Depression Clinical Research Center, Chonnam National University Hospital, Gwangju, Korea

2) Department of Neuropsychiatry, Daegu Fatima Hospital, Daegu, Korea

ep042 Perceived Stress, Coping Strategy and Psychopathology Among HIV Seropositive People who Injecting Drug (PWID) in Working Group on AIDS Cipto Mangunkusumo Hospital, Scientific Light Foundation on HIV, Tebet Primary Health Center and Kios Atmajaya University Jakarta

Khamelia Malik(0), Nurmiati Amir(0), Suryo Dharmono(0)

1) Department of Psychiatry, Faculty of Medicine, University of Indonesia

ep045 The Differentiation between Patients with Depression and Schizophrenia by means of the PAI

Min Cheol Park(0), Sang Woo Oh(0)

1) Wonkwang Univ Hosp

ep078 The association between quality of life and clinical symptoms in patients with severe mental illness: A prospective study

Bin Sun(1), Robert Rosenheck(2), Somaia Mohamed(2), Xuehua Yan(1), Gang Zeng(1), Yue Zou(1), Jieying Zhu(1), Huimei Feng(1), Zhaojun Huang(1), Yuping Ning(1), Hongbo He(1)

1) Guangzhou Psychiatric Hospital, Guangzhou, China

2) Yale Medical School, New Haven, CT, USA



ep086 A Cross-cultural Study of Family Functioning in Non-clinical Couples between North America and China

Wang Jikun(1), Abigail K. Mansfield(2), Gabor Keitner(2), Zhao Xudong(1)

1) Department of Clinical Psychology, Dongfang Hospital of Tongji University

2) Warren Alpert Medical School of Brown University, Providence, RI

ep117 Survey of rights and interests in psychiatric inpatients in Guangzhou city

Su jinghua(1)

1) Guangzhou psychiatric hospital

ep119 Psychometric comparison between Chinese and English version of SCIP (The Screen for Cognitive Impairment in Psychiatry) in health control

Li Li(1), Mei Shuang(1), Jian Huang(1), Yanping Bao(2), S.V. Tourjman(3), S. Purdon(4)

1) Institute of Mental Health, Peking University, Key laboratory of mental Health,Ministry of Health(Peking University)Beijing, China

2) Institute of Drug independence, Peking University,China

3) Department of Psychiatry, Louis H. Lafontaine University Mental Health Institute, Centre de Recherche Fernand Seguin, Université de Montréal,Canada

4) University of Alberta, Edmonton, Alberta,Canada

ep134 Escitalopram in the acute treatment of severe depression: a single-arm, open-label multicenter trial in Chinese population

Tianmei Si (1), Gang Wang(2)

1) Peking University Institute of Mental Health, Beijing, China

2) Beijing Anding Hospital, Beijing, China

ep135 Escitalopram in long-term treatment of major depressive disorder with associated anxiety symptoms: a single-arm, open-label multicenter trial in Chinese population

Kaida Jiang(1), Maosheng Fang(2)

1)Shanghai Mental Hospital, Shanghai, China

2)Wuhan Mental Hospital, Wuhan, China

