

# The 5<sup>th</sup> Congress of AsCNP

Asian College of  
Neuropsychopharmacology

PROGRAM  
BOOK

“Leap of Recent Neuropsychopharmacology Achievements in This Decade”

27-29<sup>th</sup>  
April 2017

Welcome to  
Bali,  
Indonesia



[www.ascnp2017.com](http://www.ascnp2017.com)



# UNIVERSITY OF HASANUDDIN MAKASSAR, INDONESIA



**Address:**  
Perintis Kemerdekaan Street KM.10  
Tamalanrea, Makassar 90245  
South Sulawesi - Indonesia

**Phone:** +62411-586200, +62411-584200  
**Fax:** +62411-585188  
**Website:** [www.unhas.ac.id](http://www.unhas.ac.id)



# CONTENTS

<b>Welcome Message .....</b>	<b>02</b>
<b>Program Introduction .....</b>	<b>03</b>
<b>About AsCNP .....</b>	<b>04</b>
<b>Congress Organizers &amp; Committees .....</b>	<b>06</b>
<b>Acknowledgements .....</b>	<b>07</b>
<b>Exhibitions .....</b>	<b>08</b>
<b>Congress Information .....</b>	<b>09</b>
<b>Invited Speakers .....</b>	<b>11</b>
<b>Floor Plan .....</b>	<b>12</b>
<b>Program at a Glance .....</b>	<b>13</b>
<b>Information for Speakers .....</b>	<b>16</b>
<b>Daily Program .....</b>	<b>17</b>
<b>Information for Young Psychiatrist Awards .....</b>	<b>35</b>
<b>Information for Poster Presenters .....</b>	<b>35</b>
<b>Poster Sessions .....</b>	<b>36</b>
<b>Experience Bali .....</b>	<b>46</b>



# WELCOME MESSAGE

**Dear Friends and Dear Colleagues,**

It is my great honor and special pleasure to welcome you to Bali for the 5th Asian College of Neuropsychopharmacology (AsCNP) Congress 2017 that being held in Bali International Convention Centre, Nusa Dua Bali - Indonesia, from 27th – 29th April 2017.

Following the impressive success of the previous AsCNP 2015 congress in Taipei, Bali is believed to be an excellent setting to focus on discussion under the theme “Leap of Recent Neuropsychopharmacology Achievements of This Decade”.

Today, neuropsychopharmacology, either in basic or clinical setting, is one of the most advance field in psychiatry. The development of clinical research and novel drugs, the current progress in molecular biology and modern neuroscience, the new nomenclature and perspective of psychotropic drugs, and still we face the challenges and difficulties in our approach to psychiatry disorders and mental health care. Moreover, as we progress through the 21st century, the challenges of integrating comorbid physical, mental and social care, altogether with primary and secondary care, are truly important. I believe that the AsCNP 2017 is going to provide a great opportunity to stimulate and share the most up to date achievements in the field of neuropsychopharmacology and mental health.

During the congress, the worldwide opinion leaders, especially in Asia, will share with us the recent innovations in their respective fields. The International and Local Scientific Committee have organized high scientific sessions of keynote lectures, plenary lectures, attractive symposia, interactive workshops, posters, young scientists and educational sessions.

Taking this wonderful opportunity, I encourage and invite you to experience the congress and take advantage to take part in all scientific programs that have been arranged. I believe with your support and participation, we will make this congress successful and remarkable. More importantly, please make sure to spend more days to explore the beauty, miracle, culture, and hospitality of one of the best exotic island in the world, Bali!

With open arms and warm regards, I look forward to meet you in Bali, Indonesia, and interacting with you both socially and professionally.



Sincerely Yours,

**Prof. Andi J. Tanra, M.D., Ph.D.**  
President of The 5th AsCNP 2017

## PROGRAM INTRODUCTION

**Dear Colleagues,**

The Asian College of Neuropsychopharmacology is dedicated to developing the field of neuropsychopharmacology in the Asian region. The mission of the College is to raise awareness of developments in the field of neuropharmacology at the level of clinical, translational and basic science. This mission is highlighted by the program of the College Scientific Meeting in Bali which includes plenary lectures and special lectures covering all aspects of current findings in the field. The strength of the Society is highlighted by the 24 Symposium and 2 Oral sessions that includes key thought leaders in many areas of neuropsychopharmacology. Appropriate to our Societies aims and objectives, the scientific program contains a number of presentations highlighting issues and developments within the region which makes the meeting unique. The power of the Asian region in the field of neuropsychopharmacology is emphasised by the excellent program that will be presented at the 5th Scientific Meeting of the Asian College of Neuropsychopharmacology. I would like to thank all the members of the Scientific Advisory Committee for their efforts in creating such an excellent program and the members of the Asian College of Neuropsychopharmacology in agreeing to participate. I look forward to meeting you all at our meeting in Bali where we will all learn about the exciting developments in our field.



Kind Regards,



**Prof. Brian Dean, HND Appl.Biol., MSc., PhD.**  
Chair of International Scientific Committee  
The 5th AsCNP 2017



## Asian College of Neuropsychopharmacology

### AsCNP Executive Committee

January 01, 2017 ~ December 31, 2018



President  
Andi J. Tanra  
(Indonesia)



President-elect  
Kazutaka Ikeda  
(Japan)



Past-president  
Tung-Ping Tom Su  
(Taiwan)



Honorary President  
Shigeto Yamawaki  
(Japan)



Vice-president  
Chan Hyung Kim  
(Korea)



Vice-president  
Xin Yu  
(China)



Treasurer  
Shih-Ku Lin  
(Taiwan)



Secretary of  
Central Office  
Astumi Nitta  
(Japan)

### Council Members

1) ~ December 31, 2018



Brian Dean  
(Australia)



Tianmei Si  
(China)



Xin Yu  
(China)



Shigenobu Kanba  
(Japan)



Hisatsugu Miyata  
(Japan)



Kazutaka Shimoda  
(Japan)



Chan Hyung Kim  
(Korea)



Jun Seo Kwon  
(Korea)



Kyung Joon Min  
(Korea)



Johnny Lokin  
(Philippine)



Shih-Ku Lin  
(Taiwan)



Winston W. Shen  
(Taiwan)

2) ~ December 31, 2020



Yanling He  
(China)



Gang Zhu  
(China)



Naren Rao  
(India)



Andi J. Tanra  
(Indonesia)



Kazutaka Ikeda  
(Japan)



Norio Ozaki  
(Japan)



Kiyofumi Yamada  
(Japan)



Won Myong Bahk  
(Korea)



Young-Chul  
Chung  
(Korea)



Chay Hoon Tan  
(Singapore)



Ya-Mei Bai  
(Taiwan)



Yen-Kung Yang  
(Taiwan)



Pichat Udoeratan  
(Thailand)



Auditor

~ December 31, 2020

Toshikazu Saito  
(Japan)



### Publications



An academic journal, *Clinical Psychopharmacology and Neuroscience*, became an Associate Journal of AsCNP.

<http://www.cpn.or.kr/>

Asian College of Neuropsychopharmacology  
(AsCNP) Secretariat  
c/o Convention Linkage, Inc.  
2 Sanbancho Chiyoda-ku, Tokyo 102-0075, Japan  
Phone : +81-3-3263-8688  
FAX : +81-3-3263-8693  
E-mail : [secretariat@ascnp.org](mailto:secretariat@ascnp.org)

# CONGRESS ORGANIZERS & COMMITTEES

## Host Organization



**Asian College of Neuropsychopharmacology  
(AsCNP)**



**Indonesian Association of Biological Psychiatry & Psychopharmacology  
(IABPP)**

## AsCNP Executive Committees

<b>President</b>	Andi J. Tanra	Indonesia
<b>President-elect</b>	Kazutaka Ikeda	Japan
<b>Past-president</b>	Tung-Ping Tom Su	Taiwan
<b>Honorary president</b>	Shigeto Yamawaki	Japan
<b>Vice-president</b>	Chan Hyung Kim	Korea
	Xin Yu	China
<b>Treasurer</b>	Shih-Ku Lin	Taiwan
<b>Secretary of Central Office</b>	Astumi Nitta	Japan

## Local Organizing Committees (Indonesia)

<b>Chair</b>	Andi J Tanra
<b>Vice Chair</b>	Sonny T Lisal
<b>Secretary</b>	Rinvil Renaldi
<b>Vice secretary</b>	Kristian Liaury
<b>Treasurer</b>	Fanny Wijaya
<b>Members</b>	
AA Sri Wahyuni	Israeny Nur
Agus Japari	Lili Tunggal
Andi Suheyra Syauki	Luh Nyoman Alit Aryani
Cokorda Bagus J Lesmana	Ni Ketut Sri Diniari
Dany H Ludong	Noerachmi
Erlyn Limoa	Nurindah Kadir
Faisal Idrus	Rabiah Tanthawie
Hawaidah	Saidah Syamsuddin
Hidajah	Theodorus Singara
Ifa Tunisia	Wahidah Jalil
Indrawaty Suhuyanly	Wempy Thioritz
Irma Santy	



## International Scientific Committees

<b>Chair</b>	Brian Dean	Australia	
<b>Vice Chair</b>	Kazutaka Shimoda	Japan	
<b>Members</b>			
Andi J Tanra	Indonesia	Nurmiati Amir	Indonesia
Chan Hyung Kim	Korea	Pichet Udomratn	Thailand
Chay Hoon Tan	Singapore	Shigenobu Kanba	Japan
Gang Zhu	China	Shih-Ku Lin	Taiwan
Johnny Lokin	Philippine	Susan Shui Fen Gau	Taiwan
Jun Ishigooka	Japan	Tianmei Si	China
Jun Soo Kwon	Korea	Tjhin Wiguna	Indonesia
Kiyofumi Yamada	Japan	Won Myong Bahk	Korea
Kua Ee Heok	Singapore	Xin Yu	China
Margarita Maramis	Indonesia	Yan Mei Bai	Taiwan
Min Soo Lee	Korea	Yan-Ling He	China
Naren Rao	India	Yen Kunli Yang	Taiwan
Norio Ozaki	Japan	Young-Chul Chung	Korea

## Local Scientific Committees (Indonesia)

<b>Chair</b>	Nurmiati Amir
<b>Vice Chair</b>	Margarita M Maramis
<b>Members</b>	
AAAA Kusumawardhani	Khamelia Malik
Agustina Konginan	Mahar Agusno
Albert M Maramis	Martina Wiwie
Al Bahri	Much Syamsulhadi
Andri	Muh Fanani
Arifah Nur Istiqomah	Nalini Muhdi
Aris Sudyanto	Natalia Widiasih
Charles Damping	Petrin Redayanti
Mustafa M. Amin	Ronny Wirasto
Cokorda Bagus J Lesmana	Sasanti Yuniar
Fitrikasari	Sonny Teddy Lisal
Fidiansyah	Sri Wahyuni
Ike Siregar	Tuti Wahmurti



# ACKNOWLEDGEMENTS

The 5th Congress of AsCNP Organizing Committee would like to extend its great gratitude to the following Supporting Organizations and Sponsors who generously contribute and support to the success of The 5th Congress of Asian College of Neuropsychopharmacology in Nusa Dua, Bali, Indonesia.

## Supervising Organization



**Indonesian Psychiatric Association**



**Indonesian Medical Association**

## Main Sponsors



**Sumitomo Dainippon  
Pharma**



**Otsuka**



**TSUMURA & CO.**  
THE BEST OF NATURE AND SCIENCE



**Abbott**

## Sponsors



**NOVELL  
PHARMACEUTICAL  
LABORATORIES**



PT. SOHO Industri Pharmasi



*Good Quality Improves Life's Quality*



pt. tiara kencana

## Contributing University



**Departement of Psychiatry  
University of Hasanuddin, Makassar, Indonesia**



**Departement of Psychiatry  
University of Udayana, Bali, Indonesia**



# EXHIBITIONS

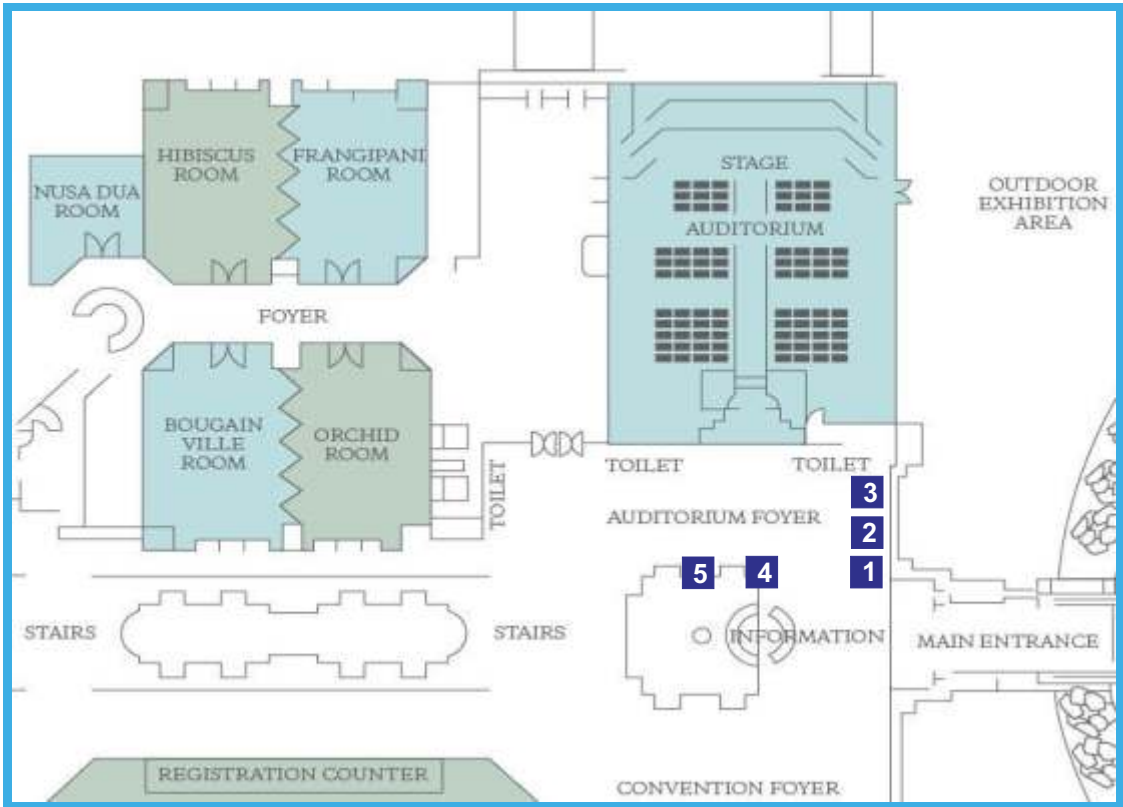

Booth No.	Exhibitor
1	Abbott
2	Pfizer
3	Soho
4	Otsuka
5	Novell

# CONGRESS INFORMATION

## REGISTRATION DESK

Registration Desk is located on **Convention Foyer, Level 1**. All congress materials and documentation are available at the Registration Desk.

Date	Service Hours
Thursday, April 27, 2017	08.00 – 17.30
Friday, April 28, 2017	07.30 – 17.30
Saturday, April 29, 2017	07.30 – 12.00

## ON-SITE REGISTRATION AND PAYMENT

On-site registration will be processed on a first-come, first-served basis. Priority will be given to pre-registered participants. Depending on the number of on pre-registered participants, availability of congress bags may be limited for on-site registered participants.

Registration Fees	Indonesian	Foreigner
Psychiatrist/Other Specialist	IDR 3,500,000	USD 500
Student/Resident/GP	IDR 2,500,000	USD 250
Accompanying Person	IDR 800,000	USD 100

\*On-site registration payment is available by **cash**, **debit card** (0,25% surcharge), or **credit card** (5% surcharge). We only accept **Visa** and **MasterCard**. Payment with debit and credit card will be converted to IDR. Payment under USD 10 is only accepted by cash.

Registration fee for psychiatrists, other specialists, students, residents, and general practitioners includes:

- Admission to all scientific sessions (exceptionally Indonesian Workshop)
- Admission to Opening Ceremony and Welcome Reception
- Admission to Exhibition
- Lunches from Friday to Saturday
- Coffee Breaks from Thursday to Saturday
- Congress materials (delegate bag, program book)

Registration fee for accompanying persons includes:

- Admission to Opening Ceremony and Welcome Reception

## CURRENCY

The currency in Indonesia is the Indonesian Rupiah (IDR). As of March 25, 2017, the USD 1 = IDR 13324.

## LANGUAGE

The official language is English, but there are workshop and symposia limited for Indonesian using Indonesian language. Simultaneous translation is NOT available.

## PREVIEW ROOM

Preview Room is located on **Executive Room 1, level 1**, and open daily at **08.00 - 17.00**.



# CONGRESS INFORMATION

## NAME BADGES

For recognition, all participants are required to wear the badges at all times during the congress period. The colours of the badges have the following significance:

Title	Colour
Participant, Exhibitor, Accompanying person	Blue
Committee	Red
Speaker	Green

## CERTIFICATE OF ATTENDANCE AND CERTIFICATE OF PRESENTATION

**Certificate of Attendance** will be provided to each registered participant during the check-in process at the registration desk. **Certificate of Presentation** will be provided to each registered participant after the congress at the registration desk.

## MESSAGE BOARD

Message board will be set up at the registration area for participants to exchange messages or obtain the congress updates.

## WIRELESS LAN / INTERNET

Wifi will be available with free of charge on the Level 1, Flower Foyer area. Information on how to access the wifi will be available from the Registration Desk.

## HOTEL RESERVATION

All questions related to hotel accommodation can be addressed to the Registration Desk. The staff will be pleased to give information regarding it.

## SECRETARIAT ROOM

Secretariat Room is located on **Executive Room 2, Level 1**. All payment invoices, official letters, and any other official documents matter can be obtained or inquired at the Secretariat Room. You can ask for printed copy of your invoice, sign and stamp papers at the Secretariat Room, the secretariat staff will be delighted to assist you.

## INFORMATION DESK

Information Desk is located on **Convention Foyer, Level 1**, next to the Registration Desk. Please feel free to visit if you have any questions or inquiries during the congress, our staffs will be pleased to help you.

Date	Service Hours
Thursday, April 27, 2017	08.00 – 17.30
Friday, April 28, 2017	07.30 – 17.30
Saturday, April 29, 2017	07.30 – 12.00

## CLOAK ROOM

Cloak Room is located inside the Secretariat Room.



# INVITED SPEAKERS (Order by Arranged Session Date)

## Keynote Lectures



**John H. Krystal**  
President of CINP,  
Professor of Neurobiology,  
Yale University School of Medicine, USA



**Anthony Albert Grace**  
Distinguished Professor of Neuroscience,  
Professor of Psychiatry & Psychology,  
University of Pittsburgh, USA



**Pierre Blier**  
Vice President of CINP,  
Professor of Psychiatry and Cellular & Molecular Medicine,  
Faculty of Medicine, University of Ottawa, Canada

## Plenary Lectures



**Kazuyuki Nakagome**  
Director General of  
National Institute of Mental Health,  
National Center of Neurology & Psychiatry,  
Tokyo, Japan



**Lakshmi N. Yatham**  
Professor of Psychiatry,  
University of British Columbia,  
Vancouver, Canada



**Norio Ozaki**  
Professor of Psychiatry,  
Chairman of Department of Psychiatry,  
Nagoya University School of Medicine,  
Japan



**Brian Dean**  
Professor and Head of Division of  
Neuroscience & Mental Health,  
Florey Institute for  
Neuroscience & Mental Health,  
Victoria, Australia

## Morning Lectures



**Jun Soo Kwon**  
Professor of cognitive science program,  
Seoul National University, South Korea



**Eric Chen**  
Professor and Head of the  
Department of Psychiatry,  
University of Hong Kong, Hong Kong



**Tung-Ping Su**  
Professor and Chairman Division of Psychiatry,  
Faculty of Medicine, National Yang Ming University,  
Taipei, Taiwan

## Special Lectures



**Kua Ee Heok**  
Professor and Senior Consultant Psychiatrist,  
Department of Psychological Medicine,  
National University of Singapore, Singapore



**Hiroyuki Uchida**  
Senior lecturer of Department of Neuropsychiatry,  
Keio University School of Medicine  
Psychopharmacology Research Program, Japan



**Masatoshi Takeda**  
President of WFSBP,  
Professor and President of  
Aino University, Osaka, Japan



# PROGRAM AT A GLANCE

Thursday, April 27, 2017

Time	Room	Auditorium (Level 1)	Frangipani (Level 1)	Hibiscus (Level 1)	Orchid (Level 1)	Bougainville (Level 1)
10.00 – 12.00 (120')			<b>SM</b> <b>TCNP</b> (Taiwanese College of Neuropsychopharmacology)			
12.45 – 14.15 (90')			<b>S 01</b> Long-Acting injection antipsychotics in Taiwan and Japan Chair: <b>Shih-Ku Lin (Taiwan)</b>	<b>IEW</b> <b>Child and Adolescent</b> Autism spectrum disorders: from early detection to treatment <i>*limited for Indonesian</i>	<b>S 02</b> Dopamine in social cognition: from rodents to primates Chair: <b>Yukiori Goto (Japan)</b>	<b>S 03</b> Recent topics on schizophrenia research in Asia Chair: <b>Jun Horiguchi (Japan)</b>
14.15 – 15.45 (90')			<b>S 04</b> Biomarker search for pathophysiology and treatment effect of affective disorders Chair: <b>Tung-Ping Su (Taiwan)</b>		<b>S 05</b> Evidence of biological markers in major depressive disorder Chair: <b>Tian-Mei Si (China)</b>	<b>S 06</b> Ketamine use disorder and ketamine-associated psychosis Chair: <b>Chih-Ken Chen (Taiwan)</b>
15.45 – 16.00		<b>Coffee Break @Exhibition Hall, Level 1</b>				
16.00 – 17.30 (90')		<b>KL</b> Speakers: <b>John H. Krystal (USA), Pierre Blier (Canada), Anthony Grace (USA)</b> Chair: <b>Andi J Tanra (Indonesia)</b> Co-Chair: <b>Kazutaka Ikeda (Japan)</b>				
17.30 – 18.15		<b>OPENING CEREMONY</b>				
18.20 – 20.20		<b>WELCOME RECEPTION @Exhibition Hall, Level 2</b>				
<b>Registration</b>		<b>@Convention Foyer, Level 1</b>				
<b>Exhibition</b>		<b>@Auditorium Foyer, Level 1</b>				

ABBREVIATION	
<b>KL</b>	Keynote Lecture
<b>ML</b>	Morning Lecture
<b>PL</b>	Plenary Lecture
<b>SL</b>	Special Lecture
<b>IEW</b>	Indonesian Educational Workshop
<b>EW</b>	Educational Workshop
<b>S</b>	Parallel symposium
<b>LS</b>	Lunch symposium
<b>IS</b>	Indonesian symposium
<b>RS</b>	REAP Study
<b>UCP</b>	Update Clinical Perspective
<b>SM</b>	Spring Meeting
<b>BM</b>	Business Meeting
<b>JM</b>	Joint Meeting
<b>EM</b>	Editorial Meeting
<b>OP</b>	Oral Presentation
<b>YPA</b>	Young Psychiatric Award



Time	Room	Auditorium (Level 1)	Frangipani (Level 1)	Hibiscus (Level 1)	Orchid (Level 1)	Bougainville (Level 1)
07.45 – 08.30 (45')		ML01 Speaker: Anthony A Grace (USA) Chair: Shigeto Yamawaki (Japan)	ML02 Speaker: Jun Soo Kwon (Korea) Chair: Nurmiati Amir (Indonesia)			
08.45 – 09.30 (45')		PL01 Speaker: Kazuyuki Nakagome (Japan) Chair: Tung-Ping Su (Taiwan)				
09.30 – 09.40		Coffee Break @Exhibition Hall, Level 1				
09.40 – 11.10 (90')		JM 01 Joint ASCNP-CIMP meeting future perspective issue of neuropsychopharmacology Chair: John H Krystal (USA)	S 07 New targets for drug development from animal models of psychiatric diseases Chair: Toshitaka Nabeshima (Japan)	S 08 Schizophrenia research in Asia: presenting of the past, collaborating for the future Chair: Hazli Zakaria (Malaysia)	UCP 01 Controversy, debate & consensus in bipolar disorder Chair: Sonny T Lisal (Indonesia)	S 09 Treatment of addiction in Asia Chair: Toshikazu Saito (Japan)
11.15 – 11.30 (15')		LS 01 Lunch symposium Otsuka	LS 02 Lunch symposium Sumitomo Dainippon Pharma Chair: Eric Chen (Hong Kong)	LS 03 Lunch symposium Tsumura Company Chair: Eriyn Limoa (Indonesia)		
11.30 – 12.15 (45')		Chair: Nurmiati Amir (Indonesia)				BM 01
12.15 – 12.30 (15')						ASCNP Board Meeting
12.30 – 13.00 (30')						
13.00 – 13.15						
13.15 – 14.15 (60')						
14.30 – 16.00 (90')		SL 01 Collaboration & networking among Asian psychiatrist Chair: Shigeto Yamawaki (Japan)	S 10 Hot topics of recent sleep research and clinical problem Chair: Jun Horiguchi (Japan)	YPA Young Psychiatrist Award Chair: Cheng-Ta Li (Taiwan)	OP 01 Oral Presentation Chair: Rinvl Renaldi (Indonesia)	IS 01 Indonesian Symposium Tiara Kencana Chair: Dwidjo Saputro (Indonesia)
16.00 – 16.15			S 11 Understanding pathways involved in the pathophysiology and treatment of schizophrenia Chair: Brian Dean (Australia)	S 12 Innovation of antiepileptic drugs with novel mechanisms related especially to epileptogenesis: modern and traditional medicines Chair: Masashi Sasa (Japan)	S 13 Microglial pathophysiology in psychiatric disorders from animal studies to human translational studies Chair: Takahiro A kato (Japan)	S 14 The problem of metabolic adverse events and cardiovascular disease among Japanese patients with schizophrenia: from a nationwide survey Chair: Toshiyuki Someya (Japan)
16.15 – 17.00 (45')		PL 02 Speaker: Lakshmi Yatham (Canada) Chair: Margarita Maramis (Indonesia)				
17.00 – 18.30 (90')		S 12 NBN Task Force Chair: Kazutaka Ikeda (Japan)	S 15 Clozapine treatment for treatment- refractory schizophrenia and future perspectives Chair: Jun Ishigooka (Japan)	S 16 Targeting traumatic memories through reconsolidation and forgetting Chair: Satoshi Kida (Japan)	S 17 Global perspectives on the treatment of mood disorders: CANMAT and Asian contributions Chair: Arun Ravindran (Canada)	S 18 Molecular aspects of pain toward future diagnosis and treatment Chair: Shogo Tokuyama (Japan)
18.30 – 20.00 (90')			BM 02 Early Career Psychiatrist Gathering Night Chair: Fransiska Kalligis (Indonesia)			
Registration		@Convention Foyer, Level 1				
Exhibition		@Auditorium Foyer, Level 1				
Poster		POSTER SESSION 1				
Social Event		PRESIDENTIAL DINNER*				
						@Flower Foyer, Level 1
						@Temple Garden, Level 1 *invited only



# Saturday, April 29, 2017

Time	Room	Auditorium (Level 1)	Frangipani (Level 1)	Hibiscus (Level 1)	Orchid (Level 1)	Bougainville (Level 1)
07.45 – 08.30 (45')	ML 03	Speaker: Eric Chen (Hong Kong) Chair: AAAA Kusumawardhani (Indonesia)	ML 04 Speaker: Tung-Ping Su (Taiwan) Chair: Handoko Daeng (Indonesia)			
08.45 – 09.30 (45')	PL 03	Speaker: Norio Ozaki (Japan) Chair: Jun Soo Kwon (South Korea)				
<b>Coffee Break @Exhibition Hall, Level 1</b>						
09.30 – 09.40	EW		S 19 New insights into neurotransmitters in pathophysiology and treatment of psychiatric disorders: novel findings from brain imaging studies Chair: Yuan Hwa Chou (Taiwan)	RS	S 20 Ketamine : from an abused drug to a rapid-onset antidepressant Chair: Kenji Hashimoto (Japan)	S 21 Child and adolescent psychopharmacology: a recent update based on clinical experiences Chair: Rinvil Renaldi (Indonesia)
09.40 – 11.10 (90')		Addiction problems in Asian Countries Chair: Kohji Takada (Japan)	UCP 02 Controversy, debate, & consensus in psychogeriatry Chair: Mathina Wiwie (Indonesia)			
11.15 – 12.15 (60')	LS 04	Lunch symposium Abbott Chair: Margarita Maramis (Indonesia)				
12.15 – 13.15				<b>Lunch and Praying @Exhibition Hall, Level 1</b>		
13.15 – 14.15 (60')	EM	How to write and submit a manuscript Chair: Eryln Limoa (Indonesia)			OP 02 Oral Presentation Chair: Andi Suheyra Syauki (Indonesia)	IS 02 Indonesian Symposium Pfizer Chair: Wempy Thioritz (Indonesia)
14.30 – 16.00 (90')	JIM 02	Joint ASCNP-JSNP meeting addiction research collaborations in Asia Chair: AJ Tanra (Indonesia)	S 22 Revised treatment guideline for bipolar disorders in Korea Chair: Wong Myong Bhak (South Korea)	S 23 Orexin systems in psychiatric diseases, progress, and ways to go Chair: Lih-Chu Chiou (Taiwan)	S 24 New findings in addiction issue Chair: Eva Suryani (Indonesia)	
16.00 – 16.15			<b>Coffee Break @Exhibition Hall, Level 1</b>			
16.15 – 17.00 (45')	PL 04	Speaker: Brian Dean (Australia) Chair: Kristian Liaury (Indonesia)				
17.00 – 17.30 (30')		<b>CLOSING CEREMONY</b>				
Registration		07.30 – 12.00 @Convention Foyer, Level 1				
Exhibition		08.00 – 17.30 @Auditorium Foyer, Level 1				
Poster		13.15 – 14.15 <b>POSTER SESSION 2</b> @Flower Foyer, Level 1				

ABBREVIATION	
KL	Keynote Lecture
ML	Morning Lecture
PL	Plenary Lecture
SL	Special Lecture
IEW	Indonesian Educational Workshop
EW	Educational Workshop
S	Parallel symposium
LS	Lunch symposium
RS	Indonesian symposium
UCP	Update Clinical Perspective
SM	Spring Meeting
BM	Business Meeting
JIM	Joint Meeting
EM	Editorial Meeting
OP	Oral Presentation
YPA	Young Psychiatric Award



# INFORMATION FOR SPEAKERS

Please provide and test your presentation slides at least **one hour before** your presentation session at the Preview Room @Executive Room 1, Level 1 of BICC (Bali International Convention Center):

Date	Schedule	Preview Time
Thursday, April 27	SM	Before 09.00
	IEW	Before 12.00
	KL	Before 15.00
Friday, April 28	ML01, ML02, PL01 JM01, UCP01	April 27, Before 17.00
	LS01 – LS03, BM01	Before 10.00
	YPA, OP01, IS01	Before 12.00
	SL01	Before 13.30
	PL02	Before 15.00
	SL02	Before 16.00
	BM02	Before 17.00
Saturday, April 29	ML03, ML04, PL03 UCP02, EW	April 28, Before 17.00
	LS04, RS	Before 10.00
	EM, OP02, IS02	Before 12.00
	JM02	Before 13.30
	PL04	Before 15.00

Date	Schedule	Preview Time
Thursday, April 27	S01 – S03	Before 12.00
	S04 – S06	Before 13.30
Friday, April 28	S07 – S09	April 27, Before 17.00
	S10	Before 12.00
	S11 – S14	Before 13.30
	S15 – S18	Before 16.00
Saturday, April 29	S19 – S21	April 28, Before 17.00
	S22 – S24	Before 13.30

\*The Preview Room will open daily at **08.00 - 17.00**

- Duration for each session is varied (please refer to the Scientific Program); while the duration of each speaker/presenter and Q&A are arranged by the session chair/organizer. Please check with the organizer regarding it.
- Please arrive at your session room at least 20 minutes before your session starts to meet the chair and re-confirm your presentation slides.
- The Congress staff will be present at each session room to provide any relevant assistance.
- Each session room will be equipped with one laptop (installed with windows 10, Microsoft Power Point 2013/2016) and an LCD projector. It is highly encouraged that all speakers use the provided laptop to prevent the connection problems and save the installation time.
- If you plan to use your own laptop, please bring any necessary electrical adaptors and connectors for your laptop. We DO NOT provide any of them.
- Please prepare a backup copy in the USB drive or CD-ROM for your video clips.
- Kindly ensure your presentation fits within the allotted time.

KL	Keynote Lecture	S	Parallel symposium	SM	Spring Meeting
ML	Morning Lecture	LS	Lunch symposium	BM	Business Meeting
PL	Plenary Lecture	IS	Indonesian symposium	JM	Joint Meeting
SL	Special Lecture	RS	REAP Study	EM	Editorial Meeting
IEW	Indonesian Educational Workshop	UCP	Update Clinical Perspective	OP	Oral Presentation
EW	Educational Workshop			YPA	Young Psychiatric Award

# DAILY PROGRAM - DAY #1

## Thursday, April 27

10.00 – 12.00

Frangipani, Level 1

**SPRING MEETING\***  
**TCNP (Taiwanese College of Neuropsychopharmacology)**

**SM**

*\*Invited Only*

12.45 – 14.15

Frangipani, Level 1

**AsCNP SYMPOSIUM 01**  
**Long-Acting Injection Antipsychotics in Taiwan and Japan**

**S 01**

Chair	<b>Shih-Ku Lin (Taiwan)</b>
Co-Chair	<b>Satti Raja Sitanggang (Indonesia)</b>
<b>S01-1</b>	Quality of Life and Social Function in Patients with Schizophrenia or Bipolar Disorder Receiving Long-Acting Antipsychotics <b>Shih-Ku Lin (Taiwan)</b>
<b>S01-2</b>	The Picture of LAIs in Japan <b>Ken Inada (Japan)</b>
<b>S01-3</b>	Comparison of Side Effects on LAIs and Oral Antipsychotics <b>Chun-Hung Chang (Taiwan)</b>
<b>S01-4</b>	Potential treatment Strategy of Long-Acting Injectable Antipsychotics for Treatment-Resistant Schizophrenia <b>Hiroshi Kimura (Japan)</b>

12.45 – 15.45

Hibiscus, Level 1

**INDONESIAN EDUCATIONAL WORKSHOP 01 – *Child and Adolescent***  
**Autism Spectrum Disorders: From Early Detection to Treatment**

**IEW**

*\*Limited for Indonesian who has been registered*

12.45 – 14.15

Orchid, Level 1

**AsCNP SYMPOSIUM 02**  
**Dopamine in Social Cognition: from Rodents to Primates**

**S 02**

Chair	<b>Yukiori Goto (Japan)</b>
Co-Chair	<b>Irwan Supriyanto (Indonesia)</b>
<b>S02-1</b>	The Effects of Social Stress on Prefrontal Cortical Function in Rodents <b>Satoru Otani (Japan)</b>
<b>S02-2</b>	The Roles of Dopamine on Social Hierarchy of Rodents and Non-Human Primates <b>Young-A Lee (South Korea)</b>
<b>S02-3</b>	Dopamine Innervations in the Cortico-Basal Ganglia Pathway of Humans and Non-Human Primates, and Their Relevance to Social Cognition <b>Mary Ann Raghanti (USA)</b>
<b>S02-4</b>	Dopamine Modulation of Social and Non-Social Cue Processing and Associated Cortical Activity in Non-Human Primates <b>Yukiori Goto (Japan)</b>



12.45 – 14.15

Bougainville, Level 1

**AsCNP SYMPOSIUM 03****Recent Topics on Schizophrenia Research in Asia****S 03**

Chair	<b>Jun Horiguchi (Japan)</b>
Co-Chair	<b>Khamelia Malik (Indonesia)</b>
<b>S03-1</b>	Schizophrenia and Idiopathic Unconjugated Hyperbilirubinemia (Gilbert's Syndrome) <b>Tsuyoshi Miyaoka (Japan)</b>
<b>S03-2</b>	Prediction Model of Metabolic Syndrome Induced by Olanzapine in Schizophrenia Patients <b>Khamelia Malik (Indonesia)</b>
<b>S03-3</b>	Autoimmune Limbic Encephalitis Like Schizophrenia <b>Masayuki Nakamura (Japan)</b>
<b>S03-4</b>	Salivary Alpha-amylase (sAA) as a Biomarker for the Response of Therapy in Schizophrenia Patients <b>Andi J Tantra (Indonesia)</b>

14.15 – 15.45

Frangipani, Level 1

**AsCNP SYMPOSIUM 04****Biomarker Search for Pathophysiology and Treatment Effect of Affective Disorders****S 04**

Chair	<b>Tung-Ping Su (Taiwan)</b>
Co-Chair	<b>Sonny T Lisal (Indonesia)</b>
<b>S04-1</b>	Pro-Inflammatory Cytokines as the Biomarkers of Clinical Outcome and Neuroimaging Abnormalities in Bipolar Disorder <b>Ya-Mei Ba (Taiwan)</b>
<b>S04-2</b>	Do Human Plasma Metabolites Predict Severity of Depression and Suicidal Ideation? <b>Takahiro A Kato (Japan)</b>
<b>S04-3</b>	Pharmacogenetics of SSRI Therapeutic Response among Patients with Major Depression <b>Shih-Jen Tsai (Taiwan)</b>
<b>S04-4</b>	Central Mechanism and Ketamine's Biological Effects of Treatment -Resistant Depression <b>Cheng-Ta Li (Taiwan)</b>

14.15 – 15.45

Orchid, Level 1

**AsCNP SYMPOSIUM 05****Evidence of Biological Markers in Major Depressive Disorder****S 05**

Chair	<b>Tian-Mei Si (China)</b>
Co-Chair	<b>Elmeida Effendy (Indonesia)</b>
<b>S05-1</b>	Distinguishing MDD from Bipolar Depression: Implications for Diagnosis and Treatment <b>Philip Mitchell (Australia)</b>
<b>S05-2</b>	Similarities and Differentiations in Cortico-Limbic Neural System in Major Depressive Disorder and Bipolar Disorder <b>Yanqing Tang (China)</b>
<b>S05-3</b>	The Dysfunctioning of Rewarding Circuit in Major Depressive Disorder and the Effects of Antidepressants on the Rewarding Circuit <b>Tianmei Si (China)</b>
<b>S05-4</b>	The 33-Item Hypomania Checklist (HCL-33): A New Self-Completed Screening Instrument for Bipolar Disorder in Depressed Patients <b>Yu-tao Xiang (Macao)</b>



14.15 – 15.45

Bougainville, Level 1

**AsCNP SYMPOSIUM 06**
**Ketamine Use Disorder and Ketamine-Associated Psychosis**
**S 06**

Chair	<b>Chih-Ken Chen (Taiwan)</b>
Co-Chair	<b>Cokorda Bagus Jaya Lesmana (Indonesia)</b>
<b>S06-1</b>	Neural Substrates in the Limbic Forebrain Underlying Ketamine Addiction <b>Jin-Chung Chen (Taiwan)</b>
<b>S06-2</b>	Symptom Dimensions of Ketamine-Associated Psychosis in Comparison with Schizophrenia <b>Ke Xu (USA)</b>
<b>S06-3</b>	Comparison of Cognitive Function and Psychotic Profile of Patients with Ketamine Dependence who had Transient or Persistent Psychosis and Schizophrenia <b>Ming-Chyi Huang (Taiwan)</b>
<b>S06-4</b>	The Efficacy of Lamotrigine in the Treatment of Ketamine Dependence <b>Chih-Ken Chen (Taiwan)</b>

15.45 – 16.00

Exhibition Hall, Level 1

**COFFEE BREAK**

16.00 – 17.30

Auditorium, Level 1

**KEYNOTE LECTURE**
**KL**

Chair	<b>Andi J. Tanra (Indonesia)</b>
Co-Chair	<b>Kazutaka Ikeda (Japan)</b>
<b>KL-1</b>	Ketamine and the Pursuit of Rapid Acting Antidepressants <b>John H. Krystal (USA)</b>
<b>KL-2</b>	Interactions between Neurotransmitters: The Key to Remission in Major Depressive Episodes <b>Pierre Blier (Canada)</b>
<b>KL-3</b>	Translating from Animal Models to Human Schizophrenia : Insights into Pathophysiology, Treatment and Prevention <b>Anthony A. Grace (USA)</b>

17.30 – 18.15

Auditorium, Level 1

**OPENING CEREMONY**

18.20 – 20.20

Exhibition Hall, Level 2

**WELCOME RECEPTION**



# DAILY PROGRAM - DAY #2

Friday, April 28

07.45 – 08.30

Auditorium, Level 1

## MORNING LECTURE 01

The Neurocircuitry of Depression: Focus on Dopamine System Dysregulation

ML 01

Speaker Anthony A. Grace (USA)

Chair Shigeto Yamawaki (Japan)

07.45 – 08.30

Frangipani, Level 1

## MORNING LECTURE 02

Thalamo-Fronto-Temporal White Matter Connectivity in Schizophrenia and Schizotypal Personality Disorder: A Diffusion-Tensor Imaging Study

ML 02

Speaker Jun Soo Kwon (South Korea)

Chair Nurmiati Amir (Indonesia)

08.45 – 09.30

Auditorium, Level 1

## PLENARY LECTURE 01

Depression and Functionality

PL 01

Speaker Kazuyuki Nakagome (Japan)

Chair Tung-Ping Su (Taiwan)

09.30 – 09.40

Exhibition Hall, Level 1

COFFEE BREAK

Fri, April 28

09.40 – 11.10

Auditorium, Level 1

JOINT AsCNP-CINP MEETING Future Perspective Issue of Neuropsychopharmacology		JM 01
Chair	John H. Krystal (USA)	
Co-Chair	Atsumi Nitta (Japan)	
JM01-1	NMDA Receptor Channel Subunit GluN2D: A Dark Horse Molecule in Neuropsychopharmacology Kazutaka Ikeda (Japan)	
JM01-2	Can We Develop Blood Tests for Psychiatric Disorders? Brian Dean (Australia)	
JM01-3	Brain Image and Drug Development: The Past, Present, and Future Yuan-Hwa Chou (Taiwan)	
JM01-4	Functional Neurosurgical Interventions for Drug Refractory Obsessive -Compulsive Disorder: Where We Are Now Chang-Hyung Kim (South Korea)	

09.40 – 11.10

Frangipani, Level 1

AsCNP SYMPOSIUM 07 New Targets for Drug Development from Animal Models of Psychiatric Diseases		S 07
Chair	Toshitaka Nabeshima (Japan)	
Co-Chair	Hyoung-Chun Kim (South Korea)	
S07-1	Depressive Symptoms and L-Tryptophan-Kynurenine Pathway Metabolism: Focus on Neuro-Inflammation Kuniaki Saito (Japan)	
S07-2	An Animal Model for Tourette Syndrome: Striatal Slitrk-1 Knocked Down Mice Lih-Chu Chiou (Taiwan)	
S07-3	PolyIC Model of Schizophrenia: A Role of IFITM3 in the Neurodevelopmental Impairment Kiyofumi Yamada (Japan)	
S07-4	Role of Oxidative Stress-Responsible Genes in Methamphetamine-Induced Psychoneurotoxic Disorders Hyoung-Chun Kim (South Korea)	

09.40 – 11.10

Hibiscus, Level 1

AsCNP SYMPOSIUM 08 Schizophrenia Research in Asia: Presenting of the Past, Collaborating for the Future		S 08
Chair	Hazli Zakaria (Malaysia)	
Co-Chair	Fransiska Kaligis (Indonesia)	
S08-1	A Hybrid Setup of Transcranial Magnetic Stimulation - Electroencephalogram (TMS-EEG) and Selective Attention in Schizophrenia: An explorative Study Hazli Zakaria (Malaysia)	
S08-2	Psychosocial Intervention for early Psychosis Patients Fransiska Kaligis (Indonesia)	
S08-3	Schizophrenia: Bridging the Gap between Clinical and Biomedical Researches Woraphat Ratta-apha (Thailand)	
S08-4	Tobacco Dependence in Schizophrenia: Where is the Problem? Hussien Elkholy (Egypt)	

Fri, April 28



09.40 – 11.10

Orchid, Level 1

**UPDATE CLINICAL PERSPECTIVE 01**

**Controversies, Debate, and Consensus in Bipolar Disorders**

**UCP 01**

Chair	<b>Sonny T Lisal (Indonesia)</b>
<b>UCP01-1</b>	Controversies and International Consensus on the Treatment of Bipolar Disorders <b>Pierre Blier (Canada)</b>
<b>UCP01-2</b>	Controversies on Bipolar Disorders: Indonesian Study <b>Margarita Maramis (Indonesia)</b>

09.40 – 11.10

Bougainville, Level 1

**AsCNP SYMPOSIUM 09**

**Treatment of Addiction in Asia**

**S 09**

Chair	<b>Toshikazu Saito (Japan)</b>
Co-Chair	<b>Hisatsugu Miyata (Japan)</b>
<b>S09-1</b>	Treatment of Internet Addiction in Korea –Biological Aspect <b>Dai-Jin Kim (South Korea)</b>
<b>S09-2</b>	Nicotine Dependence and Its Treatment in Japan <b>Hisatsugu Miyata (Japan)</b>
<b>S09-3</b>	Treatment-Resisted Alcoholics- Psychiatric Complications <b>Masaya Tayama (Japan)</b>
<b>S09-4</b>	Efficacy of Electroacupressure as Adjunctive Therapy among Methadone Maintenance Treatment (MMT) Patient: RCT Study-Preliminary Result <b>Yee Hway Ann Anne Yee (Malaysia)</b>

11.15 – 12.15

Auditorium, Level 1

**LUNCH SYMPOSIUM 01**

**New Aspects of Schizophrenia Treatment with Long Acting Injectable: Practical Consideration to Maximize Treatment Effectiveness**

Otsuka

**LS 01**

Speaker	<b>Nagesh Brahmavar Pai (Australia)</b>
Chair	<b>Nurmiati Amir (Indonesia)</b>

11.15 – 12.15

Frangipani, Level 1

**LUNCH SYMPOSIUM 02**

**New Trends in Schizophrenia : From Neural Basis to Recovery**

Sumitomo Dainippon Pharma

**LS 02**

Chair	<b>Eric Chen (Hong Kong)</b>
<b>LS02-1</b>	Anti-psychotics Discontinuation Following First Episode Psychosis: a Critical Clinical Decision Informed by 10 Year Follow Data of an RCT <b>Eric Chen (Hong Kong)</b>
<b>LS02-2</b>	Neural Basis of Schizophrenia: Linking Clinical Features to Brain Imaging Features <b>Sim Kang (Singapore)</b>

Fri, April 28

11.15 – 12.15

Hibiscus, Level 1

**LUNCH SYMPOSIUM 03**

Tsumura Company

**New Strategy by the Yi-Gan San (Yokukansan): Treatment of Various Neuro-Psychiatric Disorders**

**LS 03**

Chair  
Speaker

**Erlyn Limoa (Indonesia)**  
**Jun Horiguchi (Japan)**

11.30 – 13.00

Bougainville, Level 1

**AsCNP BOARD MEETING**

**BM 01**

12.15 – 13.15

Exhibition Hall, Level 1

**LUNCH AND PRAYING**

13.15 – 14.15

Frangipani, Level 1

**AsCNP SYMPOSIUM 10**

**Hot Topics of Recent Sleep Research and Clinical Problem**

**S 10**

Chair  
Co-Chair

**Jun Horiguchi (Japan)**  
**Ilhamuddin (Indonesia)**

- |              |  |
|--------------|--|
| <b>S10-1</b> | Complementary and Alternative Medicine for Insomnia in Japan<br><b>Hidehisa Yamashita (Japan)</b>          |
| <b>S10-2</b> | Dual Orexin Receptor Antagonist for Treatment of Insomnia<br><b>Seiichi Kawada (Japan)</b>                 |
| <b>S10-3</b> | Efficacy and Safety of Sansoninto in Insomnia with Psychiatric Disorder<br><b>Tsuyoshi Miyaoka (Japan)</b> |

13.15 – 14.15

Hibiscus, Level 1

**YOUNG PSYCHIATRIST AWARD**

**YPA**

Chair  
Co-Chair

**Cheng-Ta Li (Taiwan)**  
**Santi Yuliani (Indonesia)**

- |              |  |
|--------------|--|
| <b>YPA-1</b> | The Cognitive Effects of Atypical Antipsychotic Monotherapy in Patients with Acute Schizophrenia<br><b>Hikaru Hori (Japan)</b>   |
| <b>YPA-2</b> | Plasma Levels and Estimated Dopamine D <sub>2</sub> Receptor Occupancy of Long-Acting Injectable Risperidone During Maintenance Treatment of Schizophrenia: A 3 -year Follow-up Study<br><b>Saeko Ikai (Japan)</b> |
| <b>YPA-3</b> | Effect of Escitalopram on Anti-inflammatory Markers in Obsessive Compulsive Disorder (OCD)<br><b>Sundar Gnanavel (UK)</b>  |
| <b>YPA-4</b> | Cognitive Function and Hippocampal Volume of Chronic Schizophrenic Patients Receiving Risperidone<br><b>Vita Camellia (Indonesia)</b>  |
| <b>YPA-5</b> | D-Amino Acid Oxidase Inhibition as a Novel Approach for Refractory Schizophrenia<br><b>Chieh-Hsin Lin (Taiwan)</b>   |
| <b>YPA-6</b> | Variability of 128 Schizophrenia-Associated Gene Variants across Distinct Ethnic Populations<br><b>Kazutaka Ohi (Japan)</b>  |

Fri, April 28





13.15 – 14.15

Orchid, Level 1

**ORAL PRESENTATION SESSION 1**

**OP 01**

Chair	<b>Rinvil Renaldi (Indonesia)</b>
Co-Chair	<b>Hasrini Rowawi (Indonesia)</b>
<b>OP01-1</b>	Psychotropic Drugs in CLP Setting <b>Azimatul Karimah (Indonesia)</b>
<b>OP01-2</b>	Methylphenidate in Alleviating Apathy in Dementia <b>Prem Kumar Chandrasekaran (Malaysia)</b>
<b>OP01-3</b>	Fluctuations in Hallucinatory Experiences within a Day in Relation to Dopamine D2 Receptor Blockade with Antipsychotics in Patients with Schizophrenia <b>Teruki Koizumi (Japan)</b>
<b>OP01-4</b>	Long-term Use of Valproic Acid Reduced the Mortality in Bipolar Disorder Patients in Taiwanese Population and Enhance the Biogenesis of Mitochondria <b>Sandy Yi-Ting Lee (Taiwan)</b>
<b>OP01-5</b>	Personalized Psychopharmacology : A Genetic Approach for Better Management of Psychiatric Disorders <b>Arum Siwinarni (Indonesia)</b>

13.15 – 14.15

Flower Foyer, Level 1

**POSTER SESSION 1 (COMPETITION)**

13.15 – 14.15

Bougainville, Level 1

**INDONESIAN SYMPOSIUM 01**

**Tiara Kencana**

**IS 01**

**Clinical Application BioNeurofeedback in Daily Practice: Useful or Unuseful**

Chair	<b>Dwidjo Saputro (Indonesia)</b>
<b>IS01-1</b>	Evidence Based on the Clinical Use of Neurofeedback for ADHD <b>Dwidjo Saputro (Indonesia)</b>
<b>IS01-2</b>	Biofeedback Application in Fertility Clinic <b>Debree Septiawan (Indonesia)</b>

14.30 – 16.00

Auditorium, Level 1

**SPECIAL LECTURE 01**

**Collaboration and Networking Among Asian Psychiatrist**

**SL 01**

Chair	<b>Shigeto Yamawaki (Japan)</b>
Co-Chair	<b>AJ Tantra (Indonesia)</b>
<b>SL01-1</b>	Direction of Psychiatric Research in DSM-5 Era <b>Masatoshi Takeda (Japan)</b>
<b>SL01-2</b>	An American Perspective on US-Asia Partnerships: Opportunities and Challenges <b>John H. Krystal (USA)</b>
<b>SL01-3</b>	Present and Future Directions of Organizing a Multicenter Clinical Study in Asia <b>Jun Soo Kwon (South Korea)</b>
<b>SL01-4</b>	Public Awareness and Anti-stigma Approaches in an Asian Setting <b>Eric Chen (Hong Kong)</b>

Fri, April 28

14.30 – 16.00

Frangipani, Level 1

**AsCNP SYMPOSIUM 11**

**Understanding Pathways Involved in the Pathophysiology and Treatment of Schizophrenia**

**S 11**

Chair	<b>Brian Dean (Australia)</b>
Co-Chair	<b>Sonny T Lisal (Indonesia)</b>
<b>S11-1</b>	Potential Role of Muscarinic Receptors in the Pathophysiology of Schizophrenia <b>Brian Dean (Australia)</b>
<b>S11-2</b>	The Involvement of Acetylcholine System in Hyperactivity in Dopamine-Deficient (DD) Mice <b>Kazutaka Ikeda (Japan)</b>
<b>S11-3</b>	The Neurobiology of Treatment Resistant and Responsive Schizophrenia with Respect of Dopaminergic Systems in the CNS <b>Euitae Kim (South Korea)</b>
<b>S11-4</b>	Understanding the Potential Mechanism of Action of the Atypical Antipsychotic Drug Clozapine <b>Suresh Sundram (Australia)</b>

14.30 – 16.00

Hibiscus, Level 1

**AsCNP SYMPOSIUM 12**

**Innovation of Antiepileptic Drugs with Novel Mechanisms Related Especially to Epileptogenesis: Modern and Traditional Medicines**

**S 12**

Chair	<b>Masashi Sasa (Japan)</b>
Co-Chair	<b>Kurnia Kusumastuti (Indonesia)</b>
<b>S12-1</b>	Role of Synaptic Vesicle Glycoprotein 2A (SV2A) in Modulating Epileptogenesis <b>Yukihiko Ohno (Japan)</b>
<b>S12-2</b>	Review of Traditional Chinese Medicine for Treatment of Epilepsy <b>Min Dongyu (China)</b>
<b>S12-3</b>	Glia-Mediated Epileptogenicity <b>Schuichi Koizumi (Japan)</b>
<b>S12-4</b>	Discovery and Development of Perampanel <b>Takahisa Hanada (Japan)</b>
<b>S12-5</b>	New Classification of Seizure Types, ILAE 2017 <b>Kurnia Kusumastuti (Indonesia)</b>

14.30 – 16.00

Orchid, Level 1

**AsCNP SYMPOSIUM 13**

**Microglial Pathophysiology in Psychiatric Disorders from Animal Studies to Human Translational Studies**

**S 13**

Chair	<b>Takahiro A. Kato (Japan)</b>
Co-Chair	<b>Erlын Limoa (Indonesia)</b>
<b>S13-1</b>	Microglia and the Future Treatment of Autism Spectrum Disorder(ASD) <b>Seungmin Bae (South Korea)</b>
<b>S13-2</b>	Psychiatric Translational Research Using Human Blood -induced Microglial (iMG) Cells <b>Masahiro Ohgidani (Japan)</b>
<b>S13-3</b>	Digging Up the Unconscious Roles of Microglia Using Minocycline-Pharmacological Trials <b>Takahiro A Kato (Japan)</b>
<b>S13-4</b>	Electroconvulsive Shock Attenuated Microgliosis and Astrogliosis in the Hippocampus and Improved Prepulse Inhibition Deficit of Gunn Rat <b>Erlын Limoa (Indonesia)</b>

Fri, April 28



14.30 – 16.00

Bougainville, Level 1

**AsCNP SYMPOSIUM 14**

**The Problem of Metabolic Adverse Events and Cardiovascular Diseases among Japanese Patients with Schizophrenia: From a Nationwide Survey**

**S 14**

Chair	<b>Toshiyuki Someya (Japan)</b>
Co-Chair	<b>Kazutaka Shimoda (Japan)</b>
<b>S14-1</b>	Difference in Recognition of Metabolic Adverse Events between Psychiatrists and Patients with Schizophrenia in Japan <b>Norio Yasui-Furukori (Japan)</b>
<b>S14-2</b>	The Impact of Megadose Polypharmacy in Antipsychotic Pharmacotherapy on Electrocardiograms for Japanese Patients with Schizophrenia <b>Yutaro Suzuki (Japan)</b>
<b>S14-3</b>	Can Nutritional Education Improve Obesity Weight among Patients with Schizophrenia? <b>Norio Sugawara (Japan)</b>
<b>S14-4</b>	Physical Risks in Japanese Patients with Schizophrenia: From a Nationwide Survey <b>Takuro Sugai (Japan)</b>

16.00 – 16.15

Exhibition Hall, Level 1

**COFFEE BREAK**

16.15 – 17.00

Auditorium, Level 1

**PLENARY LECTURE 02**

**Early Intervention in Bipolar Disorder: Does it impact Outcomes?**

**PL 02**

Speaker	<b>Lakshmi Yatham (Canada)</b>
Chair	<b>Margarita Maramis (Indonesia)</b>

17.00 – 18.30

Auditorium, Level 1

**SPECIAL LECTURE 02**

**NbN (Neuroscience based Nomenclature) Task Force**

**SL 02**

Chair	<b>Kazutaka Ikeda (Japan)</b>
<b>SL02-1</b>	Drugs Used for Major Depressive Episodes <b>Pierre Blier (Canada)</b>
<b>SL02-2</b>	The New Classification of Drugs Used for Mania and Psychosis <b>Hiroyuki Uchida (Japan)</b>

17.00 – 18.30

Frangipani, Level 1

**AsCNP SYMPOSIUM 15**

**Clozapine Treatment for Treatment-Refractory Schizophrenia and Future Perspectives**

**S 15**

Chair	<b>Jun Ishigooka (Japan)</b>
Co-Chair	<b>Azimatul Karimah (Indonesia)</b>
<b>S15-1</b>	Reviewing Japanese Clozapine Patients Monitoring System (CPMS) Data since 2009 <b>Hidehiro Oshibuchi (Japan)</b>
<b>S15-2</b>	Revisiting Clozapine Administration: Dosing Regimen and Switching Strategy <b>Hiroyoshi Takeuchi (Japan)</b>
<b>S15-3</b>	Haematological Aberrations from Clozapine - What Lessons might be Learn? <b>Jimmy Lee (Singapore)</b>
<b>S15-4</b>	Long Term Follow Up on The Development of Treatment Resistance in First-Episode Schizophrenia Spectrum Disorders <b>Sherry Kit Wa Chan (Hong Kong)</b>

Fri, April 28

17.00 – 18.30

Hibiscus, Level 1

AsCNP SYMPOSIUM 16		S 16
Targeting Traumatic Memories Through Reconsolidation and Forgetting		
Chair	Satoshi Kida (Japan)	
Co-Chair	Vita Camellia (Indonesia)	
S16-1	Memory as a New Therapeutic Target Karim Nader (Canada)	
S16-2	Distinct Noradrenaline Cell Populations Coordinate the Balance between Fear and Extinction Learning Joshua Johansen (Japan)	
S16-3	Disrupting the Process of Fear Memory Reconsolidation: Towards a New Intervention for PTSD Merel Kindt (Holland)	
S16-4	Forgetting of Remote Fear Memory after Long-time Memory Recall by Hippocampal Neurogenesis Enhancers Satoshi Kida (Japan)	

17.00 – 18.30

Orchid, Level 1

AsCNP SYMPOSIUM 17		S 17
Global Perspectives on The Treatment of Mood Disorders: Canmat and Asian Contributions		
Chair	Arun Ravindran (Canada)	
Co-Chair	Kyung Joon Min (South Korea)	
S17-1	Korean Medication Algorithm for Depressive Disorder 2017: Third revision Jeong Seok Seo (South Korea)	
S17-2	Constant Evolution: New 2016 Edition of the CANMAT Guidelines for Treatment of Major Depressive Disorder Roumen Milev (Canada)	
S17-3	Guidelines for the Management of Patients with Bipolar Disorder: A Joint CANMAT-ISBD Viewpoint Lakshmi Yatham (Canada)	
S17-4	Clinical Practice Guidelines for the Management of Bipolar Disorder in Adults: Malaysia's Perspective Hazli Zakaria (Malaysia)	

17.00 – 18.30

Bougainville, Level 1

AsCNP SYMPOSIUM 18		S 18
Molecular Aspects of Pain toward Future Diagnosis and Treatment		
Chair	Shogo Tokuyama (Japan)	
Co-Chair	Elmeida Effendy (Indonesia)	
S18-1	A Novel Pain Control System via Brain GPR40/FFAR1 Signaling Kazuo Nakamoto (Japan)	
S18-2	A Novel Non-Opioid Mechanism for Acupuncture Analgesia: Involvement of Orexin and Endocannabinoid Systems Lih-Chu Chiou (Taiwan)	
S18-3	Neuropathic Pain Generator Visualization Study on Rodent Model with Metalloproteinase-12 Activatable MRI Probe Roger Ho (Singapore)	
S18-3	Molecular Mechanisms Underlying Individual Differences in Pain and Analgesic Sensitivity Shinya Kasai (Japan)	



18.30 – 20.00

Frangipani, Level 1

**BUSSINESS MEETING 02 : Early Career Psychiatrist Gathering Night**  
**Career Development of Early Career Psychiatrist: Opportunities and Challenges**

**BM 02**

Chair Fransiska Kaligis (Indonesia)

**BM02-1** Hussien Elkholy (Egypt)

**BM02-2** Masuo Tanaka (Japan)

**BM02-3** Azimatul Karimah (Indonesia)

18.30 – 20.30

Temple Garden, Level 1

**PRESIDENTIAL DINNER\***

*\*Invited Only*

Fri, April 28



# DAILY PROGRAM - DAY #3

Saturday, April 29

07.45 – 08.30

Auditorium, Level 1

**MORNING LECTURE 03**

Early Intervention for Psychosis in Hong Kong: Data and Experience

**ML 03**

Speaker Eric Chen (Hong Kong)

Chair AAAA Kusumawardhani (Indonesia)

07.45 – 08.30

Frangipani, Level 1

**MORNING LECTURE 04**

Low Dose of Ketamine, A Novel, Fast Antidepressant, Add-On Trial for Treatment Resistant Depression: From Basic Neuroscience Study to Clinical Trial in Taiwan

**ML 04**

Speaker Tung-Ping Su (Taiwan)

Chair Handoko Daeng (Indonesia)

08.45 – 09.30

Auditorium, Level 1

**PLENARY LECTURE 03**

Psychotropic Drug Development Based on the Molecular Pathogenesis of Mental Disorders Starting from Rare Disease-Susceptibility Variants

**PL 03**

Speaker Norio Ozaki (Japan)

Chair Jun Soo Kwon (South Korea)

09.30 – 09.40

Exhibition Hall, Level 1

**COFFEE BREAK**

Sat, April 29



09.40 – 11.10

Auditorium, Level 1

**EDUCATIONAL WORKSHOP**

**Addiction Problems in Asian Countries**

**EW**

Chair	<b>Kohji Takada (Japan)</b>
Co-Chair	<b>Shelly Iskandar (Indonesia)</b>
<b>EW-1</b>	A Brief Report on a Treatment Program for Problematic Internet Use among South Korean Youth <b>Kim Jangrae (South Korea)</b>
<b>EW-2</b>	Dealing with Arising Ketamine Abuse in Taiwan <b>Chia Chun Hung (Taiwan)</b>
<b>EW-3</b>	Assessment of Maternal Drug Use and Impact on Child Safety and Parenting <b>Woraphat Ratta-apha (Thailand)</b>
<b>EW-4</b>	The Preventive Measure Against Alcohol Use Disorder among the Working Persons with Habitual Drinking <b>Masuo Tanaka (Japan)</b>
Discussants	<b>Tomohiro Shirasaka (Japan), Kristiana Siste (Indonesia)</b>

09.40 – 11.10

Frangipani, Level 1

**AsCNP SYMPOSIUM 19**

**New Insights into Neurotransmitters in Pathophysiology and Treatment of Psychiatric Disorders: Novel Findings from Brain Imaging Studies**

**S 19**

Chair	<b>Yuan-Hwa Chou (Taiwan)</b>
Co-Chair	<b>Andi Suheyra Syauki (Indonesia)</b>
<b>S19-1</b>	Model-Guided Antipsychotic Dose Reduction: A Series of Clinical, Pharmacokinetic, and Brain Imaging Studies <b>Hiroyuki Uchida (Japan)</b>
<b>S19-2</b>	Antipsychotic Discontinuation in First Episode Psychosis: What Would Happen to Presynaptic Dopamine Capacity? <b>Euitae Kim (South Korea)</b>
<b>S19-3</b>	Neurometabolite Levels in Antipsychotic Naïve/Free Patients with Schizophrenia: A Meta -Analysis of 1H-MRS Studies <b>Shinichiro Luke Nakajima (Japan)</b>
<b>S19-4</b>	A Study of Tryptophan, Kynurenine and Serotonin Transporter in First-Episode Drug-Naïve Patients with Major Depressive Disorder <b>Yuan-Hwa Chou (Taiwan)</b>

09.40 – 11.10

Hibiscus, Level 1

**JOINT SYMPOSIUM REAP**

**REAP Study**

**RS**

Chair	<b>Mian-Yoon Chong (Taiwan)</b>
Co-Chair	<b>Shih-Ku Lin (Taiwan)</b>
<b>RS-1</b>	Understanding Drug Treatment of Schizophrenia in Asia through Pharmacoepidemiological research - the REAP Studies <b>Mian-Yoon Chong (Taiwan)</b>
<b>RS-2</b>	Changing Trend of the Use of Antipsychotics <b>Chay-Hoon Tan (Singapore)</b>
<b>RS-3</b>	Polypharmacy and Psychotropic Drug Loading in Patients with Schizophrenia in Asian Countries: the REAP-AP4 Study <b>Shih-Ku Lin (Taiwan)</b>
<b>RS-4</b>	Proposing the REAP Vignette-base Survey among Asian Psychiatrists <b>Takahiro A Kato (Japan)</b>

09.40 – 11.10

Orchid, Level 1

**AsCNP SYMPOSIUM 20**

**Ketamine: From an Abused Drug to A Rapid-Onset Antidepressant**

**S 20**

Chair	<b>Kenji Hashimoto (Japan)</b>
Co-Chair	<b>Ilhamuddin (Indonesia)</b>
<b>S20-1</b>	R-Ketamine as a Rapid Onset and Sustained Antidepressant <b>Kenji Hashimoto (Japan)</b>
<b>S20-2</b>	Ketamine-like Antidepressant Effects of Sarcosine <b>Hsien-Yuan Lane (Taiwan)</b>
<b>S20-3</b>	Downregulation of the Parvalbumin Interneurons Contributes to the Antidepressant Effects of Ketamine <b>Jian-Jun Yang (China)</b>

09.40 – 11.10

Bougainville, Level 1

**AsCNP SYMPOSIUM 21**

**Child and Adolescent Psychopharmacology: A Recent Update Based on Clinical Experiences**

**S 21**

Chair	<b>Rinvil Renaldi (Indonesia)</b>
Co-Chair	<b>Tjhin Wiguna (Indonesia)</b>
<b>S21-1</b>	Is 20 mg Long-Acting Methylphenidate Affecting the Cardiovascular System in Children with ADHD? <b>Tjhin Wiguna (Indonesia)</b>
<b>S21-2</b>	Successful Clozapine Treatment for Schizophrenia with Childhood Onset in Korea <b>Bung Nyun Kim (South Korea)</b>
<b>S21-3</b>	Treating Acute Agitation in Children and Adolescent in Clinical Setting <b>Benjaporn Panyayong (Thailand)</b>
<b>S21-4</b>	An Evidence Based Intervention for Children with Autism Spectrum Disorder <b>Irawati Ismail (Indonesia)</b>

11.15 – 12.15

Auditorium, Level 1

**LUNCH SYMPOSIUM 04**

**Abbott**

**LS 04**

Chair	<b>Margarita Maramis (Indonesia)</b>
<b>LS04-1</b>	The Role of Valproate in Bipolar Disorder <b>Handoko Daeng (Indonesia)</b>
<b>LS04-2</b>	Fluvoxamine in the Treatment in Major Depression Disorder <b>Nurmiati Amir (Indonesia)</b>

11.15 – 12.15

Frangipani, Level 1

**UPDATE CLINICAL PERSPECTIVE 02**

**Controversy, Debate, and Consensus in Psychogeriatry**

**UCP 02**

Chair	<b>Mathina Wiwie (Indonesia)</b>
<b>UCP02-1</b>	Biomarkers and Cognitive Reserve of the Elderly <b>Masatoshi Takeda (Japan)</b>
<b>UCP02-1</b>	Preventive Psychiatry: Paradigm Shift in Psychogeriatry <b>Kua Ee Heok (Singapore)</b>

Sat, April 29



12.15 – 13.15

Exhibition Hall, Level 1

**LUNCH AND PRAYING**

13.15 – 14.15

Auditorium, Level 1

**EDITORIAL MEETING**

**How to Write and Submit a Manuscript**

**EM**

Chair	<b>Erlyn Limoa (Indonesia)</b>
<b>EM-1</b>	<b>Anthony Grace (USA)</b>
<b>EM-2</b>	<b>Brian Dean (Australia)</b>

13.15 – 14.15

Orchid, Level 1

**ORAL PRESENTATION SESSION 2**

**OP 02**

Chair	<b>Andi Suheyra Syauki (Indonesia)</b>
Co-Chair	<b>Khamelia Malik (Indonesia)</b>
<b>OP02-1</b>	Developing Animal Model for Psychiatric Disorders in Indonesia; Experiences and challenges <b>Irwan Supriyanto (Indonesia)</b>
<b>OP02-2</b>	Antipsychotics Use and Risk of Severe Hepatic Outcome among Schizophrenia Patients with Viral Hepatitis <b>Chun-Hung Chang (Taiwan)</b>
<b>OP02-3</b>	The role of Methylenetetrahydrofolate Reductase (mthfr) Gen as a Risk Factor of Drug Resistance among Schizophrenia Patients <b>Adriesti Herdaetha (Indonesia)</b>
<b>OP02-4</b>	Epigenome-wide Association Study Identifies CpG Sites in PBMC of Associated with Alcohol Dependent Remission Using Samples from a 16-year Follow-up AUD Cohort <b>Lawrence Shih-Hsin Wu (Taiwan)</b>
<b>OP02-5</b>	Experience of Using Modified Ashton Manual in Benzodiazepine dependence <b>Lenny Liando (Indonesia)</b>

13.15 – 14.15

Bougainville, Level 1

**INDONESIAN SYMPOSIUM 02**

**Pfizer**

**IS 02**

Chair	<b>Wempy Thioritz (Indonesia)</b>
<b>IS02-1</b>	Road to Anxiety: Neurobiological Underpinnings of Anxiety Disorder <b>Margarita Maramis (Indonesia)</b>
<b>IS02-2</b>	Integrated Care: Mixed Anxiety-Depression and Somatic Symptoms <b>Andri (Indonesia)</b>
<b>IS02-3</b>	Treatment, Tool, and Targets: Current and Future Strategies against Anxiety Disorder <b>Robert Reverger (Indonesia)</b>

13.15 – 14.15

Flower Foyer, Level 1

**POSTER SESSION 2 (COMPETITION)**

Sat, April 29

14.30 – 16.00

Auditorium, Level 1

**JOINT SYMPOSIUM AsCNP-JSNP MEETING**  
**Addiction Research Collaborations in Asia**

**JM 02**

Chair	<b>Andi J. Tanra (Indonesia)</b>
Co-Chair	<b>Kazutaka Ikeda (Japan)</b>
<b>JM02-1</b>	Molecular Genetics for Psychostimulants Addiction in Asian Countries <b>Ichiro Sora (Japan)</b>
<b>JM02-2</b>	Addiction Clinical Trials in Taiwan and Researches in Asian Country Collaborations <b>Shih-Ku Lin (Taiwan)</b>
<b>JM02-3</b>	Complex Interplay Between Pain Relief and oPloid Addiction: Chronic Pain Diminishes the Mesolimbic Dopaminergic Network <b>Minoru Narita (Japan)</b>
<b>JM02-4</b>	Novel Molecules, Shati/Nat8l, Piccolo and TMEM168, Protect Methamphetamine Dependence in Mice <b>Atsumi Nitta (Japan)</b>

14.30 – 16.00

Frangipani, Level 1

**AsCNP SYMPOSIUM 22**  
**Revised Treatment Guideline for Bipolar Disorders in Korea**

**S 22**

Chair	<b>Won-Myong Bahk (South Korea)</b>
Co-Chair	<b>Duk-In Jon (South Korea)</b>
<b>S22-1</b>	Overview of Development of Korean Treatment Guideline for Bipolar Disorders <b>Se-Hoon Shim (South Korea)</b>
<b>S22-2</b>	Third Revision of Korean Medication Algorithm for Manic, Mixed and Depressive Episodes <b>Young Sup Woo (South Korea)</b>
<b>S22-3</b>	Third Revision of Korean Medication Algorithm for Maintenance Phase of Bipolar Disorders <b>Inki Sohn (South Korea)</b>
<b>S22-4</b>	Comparison with Other International Treatment Guidelines <b>Jong-Hyun Jeong (South Korea)</b>

14.30 – 16.00

Hibiscus, Level 1

**AsCNP SYMPOSIUM 23**  
**Orexin Systems in Psychiatric Diseases, Progress, and Ways To Go**

**S 23**

Chair	<b>Lih-Chu Chiou (Taiwan)</b>
Co-Chair	<b>Satti Raja Sitanggang (Indonesia)</b>
<b>S23-1</b>	A Novel Mechanism for Stress-induced Cocaine Relapse: Orexin-initiated and Endocannabinoid-Mediated Dopaminergic Disinhibition in the Ventral Tegmental Area <b>Lih-Chu Chiou (Taiwan)</b>
<b>S23-2</b>	The Associations between Plasma Orexin-A Levels and metabolic Abnormalities in Patients with Schizophrenia taking Clozapine or Other Less Obesogenic Antipsychotics <b>Po-Yu Chen (Taiwan)</b>
<b>S23-3</b>	Genetic Polymorphisms in the Orexin System (Focusing on A Polymorphism Associated with Nicotine Dependence) <b>Daisuke Nishizawa (Japan)</b>

Sat, April 29





14.30 – 16.00

Orchid, Level 1

**AsCNP SYMPOSIUM 24**

**New Findings in Addiction Issue**

**S 24**

Chair **Eva Suryani (Indonesia)**

Co-Chair **Tribowo Tuahta Ginting (Indonesia)**

**S24-1**

The Endocannabinoid System in Schizophrenia  
**Suresh Sundram (Australia)**

**S24-2**

Internet Addiction in Indonesia: a Challenging Situation  
**Kristiana Siste (Indonesia)**

**S24-3**

Association of Proopiomelanocortin Gene Polymorphism with Vulnerability to Alcohol Dependence in Japanese  
**Shinya Kasai (Japan)**

**S24-4**

Impulsivity and Addiction  
**Shelly Iskandar (Indonesia)**

16.00 – 16.15

Exhibition Hall, Level 1

**COFFEE BREAK**

16.15 – 17.00

Auditorium, Level 1

**PLENARY LECTURE 04**

**The Role of Neuroinflammation in Psychiatric Disorders**

**PL 04**

Speaker **Brian Dean (Australia)**

Chair **Kristian Liaury (Indonesia)**

17.00 – 17.30

Auditorium, Level 1

**CLOSING CEREMONY**

Sat, April 29

## INFORMATION OF YOUNG PSYCHIATRIST AWARD

- The Young Psychiatrist Award is established by AsCNP 2017 Organizing Committee to reward the young scientists who show great promise in the field of Psychiatry and Neuropsychopharmacology, with the hope that this will nurture the growth of science in the future.
- There are 6 selected participants that have been chosen from the selection process based on the applicants' CV and abstract regarding the evidence of research excellence in science.
- There is one session for YPA participants to deliver an **Oral Presentation** during the conference as scheduled on **Friday, April 28, 2017** at time **13.15 – 14.15, @Hibiscus Room, Level 1.**
- Each participant must provide and test the presentation slides at least **one hour before** the presentation session at the Preview Room @Executive Room 1, Level 1 (please refer to page 16 on Information for Speakers).
- Every YPA Participant is obligated to participate in the **Poster Session #2 on Saturday, April 29, 2017.**
- The Award Ceremony will be held during the Closing Ceremony.

## INFORMATION FOR POSTER PRESENTER

- For all presenters, please set up your poster in the Poster Area @**Flower Foyer, Level 1** of Bali International Convention Center **on the assigned day.**
- Please use the adhesive tapes provided onsite. No paste, glue, thumb tacks or staples are permitted.
- Author who wish to keep their posters should remove them at the very end of each poster session.

### Poster Mounting and Dismantling Schedule

Session	Schedule	Mounting	Dismantling
<b>Poster Session 1</b>	Friday, April 28	08.00 – 09.00	16.00 – 17.00
<b>Poster Session 2</b>	Saturday, April 29	08.00 – 09.00	16.00 – 17.00

**\*Posters not removed after assigned time will be disposed directly without permission**

### Best Poster Competition

The 5th AsCNP 2017 offers Five Best Poster Awards to encourage distinguished researchers in the fields of Mental Health Care and to provide an opportunity for all the attendees to share their research outcomes and academic experiences. The awards are to recognize excellence amongst the posters presented. All Poster presentations will be eligible for award selection.

### Time of The Competition

Session	Schedule	Presentation Time
<b>Poster Session 1</b>	Friday, April 28	13.15 – 14.15
<b>Poster Session 2</b>	Saturday, April 29	13.15 – 14.15

### Selection Process

#### Evaluation of nominated papers

- Each poster presenter is encouraged to stand next to the poster during the competition hour.
- Questions and answers might be taken place if required by the judges.

#### Award Ceremony

- The 5 Best Poster Award will be announced at the Closing Ceremony.
- The Award Ceremony will be held during the Closing Ceremony.



# POSTER SESSIONS

## Poster Sessions 1

Friday, April 28, 2017

Flower Foyer, Level 1

Fri, April 28

Session	Abstract Title
<b>Category: Addiction</b>	
<b># Poster Session 1</b>	
<b>P1-A1</b>	<b>Association Study of Genetic Polymorphisms in ABCB1, CYP2B6, CYP2D6 Genes and Efficacy Dosage for Methadone Therapy in Han Heroin Dependence Patients</b> Chia-Chi Huang (Taiwan)
<b>P1-A2</b>	<b>Clinical Characteristics Associated with Concomitant Use of Benzodiazepine Hypnotics and Alcohol: Preliminary Findings</b> Takahito Uchida (Japan)
<b>P1-A3</b>	<b>The Effect of <i>FKBP5</i> Gene Polymorphisms, Adverse Childhood Experience, and Their Interaction on Methamphetamine Abuse</b> Yen-Chun Kuo (Taiwan)
<b>P1-A4</b>	<b>(Atypical Antipsychotic Intervention for Addiction Drug Cases in <i>Rumah Sakit Ketergantungan Obat Indonesia</i>, Statistic of Outpatient Setting during August-October 2016. Is it Prolonged Abstinence?</b> Imelda Wijaya (Indonesia)
<b>P1-A5</b>	<b>The Effect of Chronic Alprazolam Use: Addiction, Tolerance and Psychotic Symptoms</b> Epa Pongmakamba (Indonesia)
<b>P1-A6</b>	<b>Dealing with Arising Ketamine Abuse in Taiwan</b> Chia Chun Hung (Taiwan)
<b>P1-A7</b>	<b>Involvement of CaMKII and ERK Nicotine dependence</b> Gofarana Wilar (Japan)
<b>P1-A8</b>	<b>Induction System of Shati/Nat8L Expression by Methamphetamine Via Dopamine D1 Signaling Pathway</b> Kyosuke Uno (Japan)
<b>P1-A9</b>	<b>Psychotic Symptoms Induced by Varenicline in a Patient with Alcohol and Nicotine Dependence: a Case Report</b> Fumihiko Ueno (Japan)
<b>P1-A10</b>	<b>The Relationship between Stress and Alcohol Consumption in Female Mice</b> Yuki Moriya (Japan)
<b>P1-A11</b>	<b>Smartphone – Based Support System (Sober Diary) For Treatment Seeking Alcohol Dependent Patient</b> Ming-Chyi Huang (Taiwan)
<b>P1-A12</b>	<b>Integrated Genetics and Proteomics Research Platform for Internet Game Disorder</b> In Young Choi (Republic of Korea)
<b>P1-A13</b>	<b>Genome-wide Association Study Identifies Candidate Loci Associated with Intraoperative Remifentanyl Infusion Rate in Patients Undergoing Laparoscopic -assisted Colectomy</b> Daisuke Nishizawa (Japan)
<b>P1-A14</b>	<b>The Correlation between the Degree of Insomnia with Smoking Behaviour and Overtraining at FIK UNM Collage Students</b> Mutmainnah Basir (Indonesia)

Session	Abstract Title
<b>Category: Schizophrenia</b>	
<b># Poster Session 1</b>	
<b>P1-B1</b>	<b>Association of Cognitive Impairment, Psychotic Symptoms and Neurotrophic Factors in Elderly Chronic Schizophrenia Patients</b> Kiyokazu Atake (Japan)
<b>P1-B2</b>	<b>Computer- assisted Cognitive Remediation in Schizophrenia and Bipolar disorder: a Prospective, Randomized, Double-blind, Sham-controlled Study</b> Chih-Ming Cheng (Taiwan)
<b>P1-B3</b>	<b>Association between Serum Vitamin D Levels and Positive – Negative Symptoms Male Schizophrenic Patient in Sumatra Utara</b> Novi Prasanty (Indonesia)
<b>P1-B4</b>	<b>The Effect of Vitamin E as an Adjuvant Therapy to Improvement Tardive Dyskinesia in Schizophrenia Patients</b> Dwi Wahyu Ningsih (Indonesia)
<b>P1-B5</b>	<b>The role of Doctor-Patients Relationship on Medication Adherence in Young Schizophrenia Patients</b> Jhin Goo Chang (South Korea)
<b>P1-B6</b>	<b>Differences Total Score Simpson -Angus Scale (SAS) Based OnGender with Treatment Risperidone in Schizophrenic Patients</b> Dahlia Rosally Turangan (Indonesia)
<b>P1-B7</b>	<b>Representativeness of Clinical PET Study Participants with Schizophrenia: A Systematic Review</b> So Kirino (Japan)
<b>P1-B8</b>	<b>Intranasal Oxytocin does not Modulate Jumping to Conclusion in Schizophrenia: Potential Interaction with Baseline Social Functioning</b> Fernando Caravaggio (Canada)
<b>P1-B9</b>	<b>Electroconvulsive Shock Affected the Schizophrenia -like Behavior and the Glial Activation in the Hippocampus of Gunn Rat</b> Erlyn Limoa (Japan)
<b>P1-B10</b>	<b>Insight and Risk Factors for Suicide in Schizophrenia: a Case Study at Mental Hospital, Bali</b> Putu Mulyati (Indonesia)
<b>P1-B11</b>	<b>Differences in Social Functioning among Patients with Major Psychiatric Disorders: Interpersonal Communication is Impaired in Patients with Schizophrenia and Correlates with an Increase in Schizotypal Traits</b> Takamitsu Shimada (Japan)
<b>P1-B12</b>	<b>Effect of Low Impact Aerobic Exercise to Calgary Depression Scale For Schizophrenia (CDSS) Total Score in Schizophrenic Patient in Mental Health Hospital in North Sumatera</b> Rosa Yunilda (Indonesia)
<b>P1-B13</b>	<b>The Correlation between Cognitive Function and Personal Social Performance in Male Schizophrenic Patients</b> Roslinda Damanik (Indonesia)
<b>P1-B14</b>	<b>Oxidation and Nitration in Dopaminergic Areas of The Prefrontal Cortex from Patients with Bipolar Disorder and Schizophrenia</b> Kasmianto Abadi (Indonesia)
<b>P1-B15</b>	<b>Treatment Resistant Schizophrenia: a Case Study</b> Katrin Nada (Indonesia)
<b>P1-B16</b>	<b>The Relationship between Cognitive Impairment and Brain Volume in Schizophrenia.</b> Yuka Yasuda (Japan)
<b>P1-B17</b>	<b>Relationship of Serum Levels of BDNF and Montreal Cognitive Assessment Score Version Indonesia ( MoCA - Ina ) in Schizophrenia</b> Nurul Utami (Indonesia)
<b>P1-B18</b>	<b>White matter Connectivity Related to Amisulpride Treatment Response in Patients with Schizophrenia</b> Min-Kyoung Kim (South Korea)



Fri, April 28

Session	Abstract Title
<b>Category: Schizophrenia</b>	
<b># Poster Session 1</b>	
<b>P1-B19</b>	<b>Vitamin D Deficiency of Schizophrenic Patient by Characteristic Demographic in North Sumatera</b> Endah Tri Lestari (Indonesia)
<b>P1-B20</b>	<b>Working Memory Deficit in Sibling of Schizophrenia Patients</b> Olga Leodirista (Indonesia)
<b>P1-B21</b>	<b>The Number of Hospitalization and Cognitive Function in Schizophrenia</b> Keisuke Ohta (Japan)
<b>P1-B22</b>	<b>The Differences in Knowledge Level Score Based on the Level Expressed Emotion Female Relatives of Schizophrenic Patients Batak Tribe in Prof. Dr. M. Ildrem Psychiatric Hospital North Sumatera</b> Muhammad Affandi (Indonesia)
<b>P1-B23</b>	<b>The Combination of Presynaptic Cytomatrix Protein Piccolo Knockdown in the Prefrontal Cortex and Mild Social Defeat Stress Induces Schizophrenia-like Behaviors in Mice</b> Yoshiaki Miyamoto (Japan)
<b>P1-B24</b>	<b>The Influence of Ocimum Sanctum as an Adjuvant Therapy on Clinical Features and Cognitive Function Improvement in Schizophrenia Patients Treated Risperidone</b> Anisa Ramli (Indonesia)
<b>P1-B25</b>	<b>Comparison Serum Vitamin D by the Residence Between Highland and Lowland in Schizophrenic Male Patient in Sumatera Utara</b> Novita Linda Akbar (Indonesia)
<b>P1-B26</b>	<b>Exploring Functional Polymorphisms in a Schizophrenia Risk Locus of DRD2 Using Prolactin Concentration in Healthy Subjects</b> Naoki Fukui (Japan)
<b>P1-B27</b>	<b>Patient's Knowledge of Prescribe Psychotropics and Medication adherence in Schizophrenia: a Cross-Sectional Survey</b> Nobuhiro Nagai (Japan)
<b>P1-B28</b>	<b>Antipsychotic Use is a Risk Factor for Hyponatremia in Patients with Schizophrenia: a 15-year Follow-up Study</b> Wan Ju Cheng (Taiwan)
<b>P1-B29</b>	<b>Safety of Lurasidone in Schizophrenia: A Systematic Review and Meta -Analysis of RCTs with Active Comparators</b> Katsuhiko Hagi (Japan)
<b>Category: Mood Disorder</b>	
<b># Poster Session 1</b>	
<b>P1-C1</b>	<b>The Effect of Acceleration Study During High School to Depression Level of Medical Students</b> Adila Taufik Syamlan (Indonesia)
<b>P1-C2</b>	<b>Assessment of Depression, Anxiety and Stress among Postnatal Mothers</b> Nirmala Pradhan (Nepal)
<b>P1-C3</b>	<b>The Differences of Depression Prevalence in Elderly Patients with Type II DM Treated with Oral Antidiabetic Drug and Insulin Injection in Ngemplak</b> Eska Agustin Putri Susanti (Indonesia)
<b>P1-C4</b>	<b>Korean Medication Algorithm for Depressive Disorder 2017: Non-Pharmacological Biological Treatments</b> Jong-Hyun Jeong (Korea)
<b>P1-C5</b>	<b>Effectiveness of Local Wisdom-based Games and Neurofeedback Treatment in Decreasing Depression of Post Schizophrenic Depression Patients Admitted to Prof. Dr. Soerojo Magelang Mental Hospital</b> Sumarni DW (Indonesia)
<b>P1-C6</b>	<b>The Association between Fasting and 2 Hours Post Prandial Blood Glucose Levels and Depression Score in Elderly Patients with type II Diabetes Mellitus Treated with Insulin and Oral Antidiabetic drug in Ngemplak Yogyakarta</b> Rahmawati (Indonesia)
<b>P1-C7</b>	<b>Investigation of Cognitive Dysfunction of both Post-traumatic Stress Disorder and Major Depressive Disorder Using Current Source Analysis of P300 Event-related Potential</b> Sang Woo Hahn (Republic of Korea)



Session	Abstract Title
<b>Category: Mood Disorder</b>	
<b># Poster Session 1</b>	
<b>P1-C8</b>	<b>Rumination as a Mediator of the Influence of Childhood Trauma on Depression and Anxiety in Non-clinical Samples</b> Sang Woo Hahn (Republic of Korea)
<b>P1-C9</b>	<b>Role of Testosterone in Treatment of Depression</b> Wijaya Taufik Tiji (Indonesia)
<b>P1-C10</b>	<b>The Efficacy of Folic Acid as an Adjuvant Therapy in Improving Depressive Symptoms</b> Ismariani Mandan (Indonesia)
<b>P1-C11</b>	<b>Prevalence of Depression and its Associations with Demographic and Clinical Characteristics and Quality of Life among University Students in China</b> Lu Li (China)
<b>P1-C12</b>	<b>Depression in Myasthenia Gravis Patient</b> Ida Bagus GedeWisnu Wardhana (Indonesia)
<b>P1-C13</b>	<b>The Role Oxidative Stress and Antioxidant in Depression</b> Soeklola (Indonesia)
<b>P1-C14</b>	<b>Dose-related Effects of Ketamine Infusion on Suicidal Ideation in Patients with Treatment -resistant Depression: a Randomized Double-blind Controlled Study in Taiwan</b> Tung-Ping Su (Taiwan)
<b>P1-C15</b>	<b>Gene Expression-based Diagnostic Marker for Bipolar Disorder</b> Shinya Watanabe (Japan)
<b>P1-C16</b>	<b>Treatment after Hospitalization and Three-year Mortality in People with Bipolar Disorder: a Cost-effectiveness Analysis</b> Yi-Ju Pan (Taiwan)
<b>P1-C17</b>	<b>Psychotic Bipolar Disorder and Suicide Risk: A Case-Control Study</b> Chau-Shoun Lee (Taiwan)
<b>P1-C18</b>	<b>Distinguishing Major Depression and Anxiety Disorder in Self-report: Result from Psychometric Analysis of Clinically Useful Anxiety Outcome Scale</b> Sang Won Jeon (Republic of Korea)
<b>P1-C19</b>	<b>Korean Medication Algorithm for Bipolar Disorder: Changes in Preferred Medications for Mania Over 12 Years</b> Duk-In Jon (Korea)
<b>P1-C20</b>	<b>Korean Medication Algorithm Project for Depressive Disorder 2017 (KMAP-DD 2017); 3<sup>rd</sup> Revision.</b> JeongSeok, Seo (Korea)
<b>P1-C21</b>	<b>Alterations of the Cortisol and Dehydroepiandrosterone in Perinatal Depression</b> Ho Suk Suh (South Korea)
<b>P1-C22</b>	<b>Differences Anxiety Symptoms and Depression Sytoms in Mother of Children Undergoing Maintenance Therapy for Childhood Acute Lymphoblastic Leukemia</b> Suniaty Dapot Ria (Indonesia)



Fri, April 28

Session	Abstract Title
<b>Category: Anxiety and Obsessive Compulsive Disorder</b> <span style="float: right;"><b># Poster Session 1</b></span>	
<b>P1-D1</b>	<b>Distinguishing Quantitative Electroencephalogram Findings between Generalized Anxiety Disorder and Panic Disorder</b> Ho Suk Suh (South Korea)
<b>P1-D2</b>	<b>ECT in a Severe OCD Patient</b> Chia-Lun Tsai (Taiwan)
<b>P1-D3</b>	<b>Serotonin Modulated the Correlations between Obsessive-compulsive (OC) Trait and Heart Rate Variability in Normal Healthy Subjects</b> Wei Hung Chang (Taiwan)
<b>P1-D4</b>	<b>Resting-state Functional Connectivity of the Thalamus as a Possible Predictor of Treatment Response in Obsessive-compulsive Disorder</b> Jaewook Han (Republic of Korea)
<b>P1-D5</b>	<b>Fornix Integrity Associated with Early Trauma in Panic Disorder</b> Seung-Taek Yu (Korea)
<b>P1-D6</b>	<b>Reduced Cortical Thickness of Temporal Pole, Insula and Pars Triangularis in Patients with Panic Disorder</b> Eun-Kyoung Kang (Korea)
<b>P1-D7</b>	<b>Anxiety Factors Associated with Obsessive -Compulsive Disorder: A Population Based Case -Control Study in Taiwan</b> Li-Chung Huang (Taiwan)
<b>P1-D8</b>	<b>Factors Associated with the Response to Combination Therapy of Psychological and Pharmacological Treatment in Panic Disorder</b> Kang Soo Lee (Republic of Korea)
<b>Category: Dementia</b> <span style="float: right;"><b># Poster Session 1</b></span>	
<b>P1-E1</b>	<b>Placebo Effects in Alzheimer Disease: Analysis of the CATIE-AD Data</b> Chisa Ozawa (Japan)
<b>P1-E2</b>	<b>Clozapine Induced Shock, QTc Interval Prolongation, And Worsening of Extrapyrarnidal Syndrome In 58 Years Old Woman With Early Onset Dementia, a Case Report</b> Jiemi Ardian (Indonesia)
<b>P1-E3</b>	<b>Anosognosia for a Visible Facial Tumor in Frontotemporal Dementia: a case report</b> Chih-Ming Cheng (Taiwan)
<b>Category: Child and Adolescent</b> <span style="float: right;"><b># Poster Session 1</b></span>	
<b>P1-F1</b>	<b>Beneficial Effect of Aerobic Exercise on Emotion, Cognition, and Physical Function in Children with Attention Deficit / Hyperactivity Disorder</b> Daeyoung Roh (Republic of Korea)
<b>P1-F2</b>	<b>The Influence of Psychosocial Factors to Eating Behaviour in Children and Adolescents: An Evidence Based Case Report</b> Rinvil Renaldi (Indonesia)
<b>Category: Others</b> <span style="float: right;"><b># Poster Session 1</b></span>	
<b>P1-F3</b>	<b>The Effect of Nigella Sativa Increase Levels of Superoxide Dismutase in Passive Smokers Study in Sprague Dawleyrats</b> Irena Aryani (Indonesia)
<b>P1-F4</b>	<b>Correlation between Marker Oxidative Stress and Histopathology Hepar (Manjaroenigk Score) (Study in Wistar Rat Induced by Fluhenazinedecanoate)</b> Innawati Jusup (Indonesia)

# POSTER SESSIONS

## Poster Sessions 2

Saturday, April 29, 2017

Flower Foyer, Level 1

Session	Abstract Title
<b>Category: Neurobiology</b>	
<b># Poster Session 2</b>	
<b>P2-G1</b>	<b>Musical Hallucination Associated with the Superior Temporal Gyrus-innervated Dominant Hemisphere</b> Hitoshi Sakimoto (Japan)
<b>P2-G2</b>	<b>Ventral Hippocampus Outputs Modulate Stress-provoked Aggression</b> Chih-Hua Chang (Taiwan)
<b>P2-G3</b>	<b>Pharmacological Profiling of Several <math>\mu</math>-opioid Receptor Agonists Based on the Changes in the Ligand-biased Intracellular Signaling</b> Miho Kawata (Japan)
<b>P2-G4</b>	<b>Dentate Gyrus Cells Count and Memory Retention in Sprague Dawley Rats Post Vascular Cognitive Impairment Induction and after Treatment with Haloperidol and Olanzapin</b> Arif Prasetyo (Indonesia)
<b>P2-G5</b>	<b>The Relationship between Thalamic Functional Connectivity and General Intellectual Functioning in Individuals at Ultra-high Risk for Psychosis</b> Sang Hoon Oh (Republic of Korea)
<b>P2-G6</b>	<b>Acute Psychosis in "Asymptomatic" Malaria</b> Kusuma Minayati (Indonesia)
<b>P2-G7</b>	<b>Activation of Astrocytes in the Anterior Cingulate Cortex Corresponds to Sleep Disorder under Neuropathic Pain</b> Naoko Kuzumaki (Japan)
<b>P2-G8</b>	<b>Spontaneous Parkinsonism in First-episode Psychosis</b> Sylvana Evawani (Indonesia)
<b>P2-G9</b>	<b>Influence of Carbonyl Stress on Neural Cells Derived from Induced Pluripotent Stem Cell</b> Yasue Horiuchi (Japan)
<b>P2-G10</b>	<b>The Difference of Serum Tumor Necrosis Factor -Alpha (Tnf-a) Levels Between Patients Schizophrenic Male with Smoking and Control</b> Rona Hanani Simamora (Indonesia)
<b>P2-G11</b>	<b>Single Nucleotide Polymorphisms in the 5'Flanking Region of Interleukin -17A Gene Significantly Associate with Pain Sensitivity</b> Seii Ohka (Japan)
<b>P2-G12</b>	<b>GIPR Gene Polymorphism in Schizophrenia and Metabolic Syndrome: a Cross-sectional Study</b> Shin Ono (Japan)
<b>P2-G13</b>	<b>Seven Cases of Autoimmune Limbic Encephalitis with Psychiatric Symptoms</b> Shinichiro Tagawa (Japan)
<b>P2-G14</b>	<b>Vascular Diameters in CA1 Area of Hippocampus and Memory Retention in Sprague Dawley Rats Post Vascular Cognitive Impairment Induction and after Treatment with Olanzapine</b> Nunu Nurkholis M. (Indonesia)
<b>P2-G15</b>	<b>Associations between Polymorphisms Close to the cAMP Responsive Element Binding Protein 1 (CREB1) Gene and the Activating Transcription Factor 2 (ATF2) Gene and Fentanyl Sensitivity</b> Yoshinori Aoki (Japan)

Sat, April 29



Sat, April 29

Session	Abstract Title
<b>Category: Neurobiology</b>	
<b># Poster Session 2</b>	
<b>P2-G16</b>	<b>Recent Findings in the Neurobiology of Anxiety Disorders : Implications for Novel Treatments Approaches</b> Elmeida Effendy (Indonesia)
<b>P2-G17</b>	<b>Dysfunction of GPR40/FFAR1 Signaling Exacerbates Pain Behavior in Mice</b> Kazuo Nakamoto (Japan)
<b>P2-G18</b>	<b>Pharmacological and Genetic Inhibition of Protein Kinase C d Attenuates Against Serotonin Syndrome - induced by Dextromethorphan via Inactivation of 5-HT1A Receptor and Activation of Nrf2-dependent Glutathione Induction; Comparison with 5-HT1A Receptor Agonist 8-OH-DPAT</b> Hai-Quyem Tran (Korea)
<b>P2-G19</b>	<b>MK-801, but not Naloxone, Attenuates High -dose Dextromethorphan -induced Convulsive Behaviors; Possible Involvement of NR2B Receptor</b> Ji Hoon Jeong (Republic Of Korea)
<b>P2-G20</b>	<b>Hyperforin Triggers Apoptosis through a Caspase-dependent Pathway in Hepatocellular Carcinoma SK -Hep1 Cells</b> Wei-Ting Chen (Taiwan)
<b>P2-G21</b>	<b>Cross Cultural Aspects of Psychopharmacology: Relevancies for Indonesia from a Pharmacogenetics Perspective</b> Herlina Pohan (Indonesia)
<b>P2-G22</b>	<b>Association between Genetic Polymorphisms in Ca<sub>v</sub>2.3 (R-type) Ca<sup>2+</sup> Channels and Fentanyl Sensitivity in Patients Undergoing Painful Cosmetic Surgery</b> Soichiro Ide (japan)
<b>P2-G23</b>	<b>Survey of the Relationship between Alcohol Cognitive Dysfunction and Cerebral Blood Flow</b> Tomohiro Shirasaka (Japan)
<b>P2-G24</b>	<b>Complement Factor H as a Plasma Inflammatory Marker of Geriatric Depression</b> Cheolmin Shin (Korea)
<b>P2-G25</b>	<b>Functional Change of Serotonin 2C Receptors in N-Methyl-D-aspartate (NMDA) Receptor Hypofunctional Condition</b> Takahiro Tsutsumi (Japan)
<b>P2-G26</b>	<b>BDNF Gene Polymorphisms as A Susceptibility Factor for Schizophrenia: literature</b> Yulianti IGAA (Indonesia)
<b>P2-G27</b>	<b>GPR40/FFAR1 Deficient Mice Increase Noradrenaline Levels in the Brain and Exhibit Abnormal Behavior</b> Shogo Tokuyama (Japan)
<b>P2-G28</b>	<b>Behavioral and Neurochemical Abnormalities in MHC1 Expressed Mic</b> Akira Sobue (Japan)
<b>P2-G29</b>	<b>Disruption of Exons 2 and 3 of the Disc1 Gene in the Mouse is Associated with Elevated Repetitive Behavior</b> Bolati Wulaer (Japan)
<b>P2-G30</b>	<b>Lower Brain pH as a Shared Endophenotype of Psychiatric Disorders</b> Hideo Hagihara (Japan)

Session	Abstract Title
<b>Category: Psychopharmacology</b>	
<b># Poster Session 2</b>	
<b>P2-H1</b>	<b>Pharmacometabolomic Changes Following Antidepressants in Patients with Major Depressive Disorder</b> Hidehiro Umehara (Japan)
<b>P2-H2</b>	<b>Dentate Gyrus Cells Count and Impulsivity in Sprague Dawley Rats Post <i>Vascular Cognitive Impairment</i> Induction and after Treatment with Haloperidol and Olanzapine</b> Susini Rang kai Sari (Indonesia)
<b>P2-H3</b>	<b>The Ubiquitination of Serotonin Transporter in Lymphoblasts Derived from Fluvoxamine-resistant Depression Patients</b> Akihiro Mouri (Japan)
<b>P2-H4</b>	<b>On the Importance of Emergency Intervention : A Case Series of Neuroleptic Malignant Syndrome in Sanglah General Hospital, Denpasar, Bali</b> Anastasia Venny Yustiana (Indonesia)
<b>P2-H5</b>	<b>Bradycardia: an Adverse Effect Caused by Administration Olanzapine</b> Ni Wayan Dewi PA (Indonesia)
<b>P2-H6</b>	<b>Rapamycin Treatment of Impaired Social Behavior in Adolescent <i>Tsc2<sup>+/-</sup></i> Mice</b> Hirofumi Kashii (Japan)
<b>P2-H7</b>	<b>Psychosis Induced by Corticosteroid (Methylprednisolone) Use – a Case Report</b> Rabiatul Udawiyah (Indonesia)
<b>P2-H8</b>	<b>Inhibition of mTOR Improves Autism-like Behaviors in mice <i>in Utero</i>exposed to Valproic Acid</b> Hiroko Kotajima-Murakami (Japan)
<b>P2-H9</b>	<b>Immediate Versus Gradual Discontinuation in Antipsychotic Switching: A Systematic Review and Meta-analysis</b> Hiroyoshi Takeuchi (Japan)
<b>P2-H10</b>	<b>Association Study of Metabolic Syndrome and Polymorphism of Serotonin Receptor Genes in Schizophrenic Patients using Atypical Antipsychotics</b> Hsin-Ping Sun (Taiwan)
<b>P2-H11</b>	<b>Simvastatin as an Adjuvant Therapy to Fluoxetine in Patients with Depression</b> Willy Suento (Indonesia)
<b>P2-H12</b>	<b>Is There any Difference of Incidence of the Restless Leg Syndrome between Antipsychotics?</b> Inki Shon (Republic Of Korea)
<b>P2-H13</b>	<b>Pharmacokinetics of Mirtazapine included Glucuronidated Metabolites in Japanese Psychiatric Patients</b> Takashi Watanabe (japan)
<b>P2-H14</b>	<b>The association between Demographic and Disease Treatment Characteristics of Multi Drugs Resistant Tuberculosis (MDR TB) Patient with Cycloserine induced Psychosis</b> Suprihatini (Indonesia)
<b>P2-H15</b>	<b>A Case of Sibutramine Causing Acute Psychosis</b> Damien Lai (Singapore)
<b>P2-H16</b>	<b>Comparison of Cell Counts in Hippocampus of Sprague Dawley Rats Post VCI Induction after Treatment with Haloperidol and Olanzapine</b> Heru Yuliyanto (Indonesia)
<b>P2-H17</b>	<b>Effect of Fluvocamine on Plasma Interleukin-6 in Major Depression</b> Reiji Yoshimura (Japan)



Session	Abstract Title
<b>Category: Psychopharmacology</b>	
<b># Poster Session 2</b>	
<b>P2-H18</b>	<b>Breastfeeding Cessation during Antipsychotic Treatment in Postpartum Women: Is It a Must?</b> Agnilia Octia Sari (Indonesia)
<b>P2-H19</b>	<b>Adjunctive Brexpiprazole, a Novel Effective Strategy for treating Major Depressive Disorder? : Systematic Review and Meta-analysis</b> Changsu Han (Korea)
<b>P2-H20</b>	<b>Zinc Efficacy as Adjuvant Therapy to Fluoxetine in Improving Depressive Symptoms</b> Balgis (Indonesia)
<b>P2-H21</b>	<b>Case Report Serotonin Syndrome Due to Drug Interactions Sanglah Hospital, Bali</b> Putu Diatmika (Indonesia)
<b>P2-H22</b>	<b>Antipsychotic Dose Reduction in Schizophrenia: a Systematic Review</b> Hideaki Tani (Japan)
<b>P2-H23</b>	<b>Differences in Schizophrenic Patients Cognitive Function Against Granting Risperidone and Haloperidol Based on Duration of Illness</b> Nanda Sari Nuralita (Indonesia)
<b>P2-H24</b>	<b>The Role of Olanzapine as Augmentation Therapy in Generalized Anxiety Disorder: a Case Report</b> Rina Amtarina (Indonesia)
<b>P2-H25</b>	<b>A Comparison of Coercive and Voluntary Long-Acting Injectable Antipsychotic Use and Patient Outcomes</b> Nagesh B Pai (Australia)
<b>P2-H26</b>	<b>Risk of Venous Thromboembolism during Treatment with Clozapine : Case Report</b> Othovianty Palyngan (Indonesia)
<b>P2-H27</b>	<b>Effect of Zinc Supplementation as Adjuvant Therapy to Alprazolam to Improvement of The Clinical Symptoms of Anxiety</b> Iwan Honest (Indonesia)
<b>P2-H28</b>	<b>Higher Serotonin Transporter Availability in Early Onset Obsessive -compulsive Disorder Patients Under Escitalopram Treatment: A [11C]DASB PET Study</b> Junhee Lee (Korea)
<b>P2-H29</b>	<b>Clinical Outcomes with Long Acting Injection (LAI) in Schizophrenia Treatment in Japan</b> Takahiro Oyamada (Japan)
<b>P2-H30</b>	<b>Therapeutic Drug Monitoring of Paliperidonepalmitate in Patients with Schizophrenia or Bipolar Disorder</b> Chun Lin (Taiwan)
<b>P2-H31</b>	<b>Improvement of Negative Symptoms in Schizophrenic Patients treated with Risperidone and Fluoxetine Compared with Risperidone and Amitriptylin</b> Yazzit Mahri (Indonesia)
<b>P2-H32</b>	<b>Psychiatric Problems Profile Among Patients Being Treated for Multi Drugs Resistant Tuberculosis at Dr.Sardjito Hospital, Yogyakarta</b> Sak Liung (Indonesia)
<b>P2-H33</b>	<b>Neuroleptic Malignant Syndrome Following High Potency And Polypharmacy Administration of Antipsychotics in Patient with Chronic Schizophrenia : Case Report</b> Sak Liung (Indonesia)
<b>P2-H34</b>	<b>Hypoprolactinemia in Male Patients treated with Risperidone or Aripiprazole</b> Kazutoshi Kubo (Japan)
<b>P2-H35</b>	<b>Initial Pharmacotherapy by Dopamine Stabilizer, Aripiprazole, for Inpatients Due to Suicidal Attempt Following Disaster</b> Keiko Ikemoto (Japan)
<b>P2-H36</b>	<b>Efficacy of Lurasidone in Schizophrenia: A Systematic Review and Meta-Analysis of RCTs with Active Comparators</b> Katsuhiko Hagi (Japan)
<b>P2-H37</b>	<b>Novel Strategies of Treatment of Shizophrenia and Alzheimer's disease based on D-Cell Hypothesis</b> Keiko Ikemoto (Japan)

Session	Abstract Title
<b>Category: Psychopharmacology</b>	
<b># Poster Session 2</b>	
<b>P2-H38</b>	<b>Case report on Risperidone Induced Acute Dystonia and Management Treatment</b> Nyoman Widhya Lestari (Indonesia)
<b>P2-H39</b>	<b>The Cognitive Profile of Antipsychotic Monotherapy and Polypharmacy in Chronic schizophrenia patients</b> Kentaro Kawabe (Japan)
<b>P2-H40</b>	<b>The Effect of Folic Acid and Cyanocobalamin as Adjuvant Therapy to Improve the Cognitive Function of Vascular Dementia Patients</b> Rahmawati Nur Indah (Indonesia)

<b>Posters of Young Psychiatrist Award</b>		<b># Poster Session 2</b>
<b>P2-I1 (YPA-1)</b>	<b>The Cognitive Effects of Atypical Antipsychotic Monotherapy in Patients with Acute Schizophrenia</b> Hikaru Hori (Japan)	
<b>P2-I2 (YPA-2)</b>	<b>Plasma Levels and Estimated Dopamine D<sub>2</sub> Receptor Occupancy of Long-Acting Injectable Risperidone During Maintenance Treatment of Schizophrenia: A 3-year Follow-up Study</b> Saekolkai (Japan)	
<b>P2-I3 (YPA-3)</b>	<b>Effect of Escitalopram on Anti-inflammatory Markers in Obsessive Compulsive Disorder (OCD)</b> Sundar Gnanavel (England)	
<b>P2-I4 (YPA-4)</b>	<b>Cognitive Function and Hippocampal Volume of Chronic Schizophrenic Patients Receiving Risperidone</b> Vita Camellia (Indonesia)	
<b>P2-I5 (YPA-5)</b>	<b>D-Amino Acid Oxidase Inhibition as a Novel Approach for Refractory Schizophrenia</b> Chieh-Hsin Lin (Taiwan)	
<b>P2-I6 (YPA-6)</b>	<b>Variability of 128 Schizophrenia -Associated Gene Variants across Distinct Ethnic Populations</b> Kazutaka Ohi (Japan)	





# EXPERIENCE BALI



## Tanah Lot Temple

This temple is perched on top of a huge rock, and surrounded by the sea with waves constantly crashing on to its base. Tanah Lot pays homage to the guardian spirits of the sea. The temple serves as foreground to the most picturesque sunsets. Location: **Tabanan** ( $\pm 34.6$  KM from BICC)

## Ubud Monkey Forest

This is one of Bali's several grey long-tailed macaque-inhabited forests and perhaps the best known. Also known as the Sacred Monkey Forest of Padangtegal, and by its official designation as Mandala Wisata Wenara Wana, Ubud Monkey Forest is a place of scientific research as well as a site of spiritual and cultural aspects with temples sanctified by the local villagers deep within its grounds. Location: **Ubud** ( $\pm 41.1$  KM from BICC)



## Kuta Beach

This beach is known because of its beauty. You can see hills surround the beach. It has white sands and perfect wave for surfing. This beautiful beach offers everything. Location: **Kuta** ( $\pm 14$  KM from BICC)



## Kuta Art Market

Kuta Art Market remains an important part of Kuta's history, and still plays a major role as one of Kuta's landmarks and the longstanding traditional art market in the area. Location: **Kuta** ( $\pm 13.6$  KM from BICC)



## Kintamani & Mount Batur

Kintamani is home to Mount Batur and the Caldera Lake. The still-active Mount Batur volcano has erupted about 24 times since 1800, each time reshaping the surrounding landscape. Location: **Denpasar** ( $\pm 24.6$  KM from BICC)



## Bali Safari & Marine Park

It is Bali's largest animal theme park. The park is home to over 60 species, all roaming freely within their enclosures built to closely mimic their natural habitats. Location: **Gianyar** ( $\pm 38.4$  KM from BICC)



## Museum Pasifika

It features colourful displays of traditional and contemporary Balinese art, religious artifacts and treasures from across Southeast Asia. Location: **Nusa Dua** ( $\pm 1.3$  KM from BICC)

## INFORMATION ABOUT TOURS

All information about tours around Bali can be found at the Tour Desk, located on **Auditorium Foyer, Level 1**. Our staffs will be pleased to help you.









# 6th Congress of ASCNP

Asian College of Neuropsychopharmacology

*Neuropsychopharmacology to the next generation:  
New wave from Asia*

**October 11 - 13, 2019**

**Fukuoka, Japan** Fukuoka International  
Congress Center

Chair: **Kazutaka Ikeda** (Tokyo Metropolitan Institute of Medical Science)

Vice Chair: **Kazutaka Shimoda** (Dokkyo Medical University)

**Toshiyuki Someya** (Niigata University)

Secretary: **Shinya Kasai** (Tokyo Metropolitan Institute of Medical Science)

**Joint Annual Meetings**

**JSCNP** 

29th Annual Meeting of  
Japanese Society of  
Clinical Neuropsychopharmacology

Chair: **Reiji Yoshimura**  
(University of Occupational and Environmental Health)

**JSNP** 

49th Annual Meeting of  
Japanese Society of  
Neuropsychopharmacology

Chair: **Hisatsugu Miyata**  
(Jikei University School of Medicine)

**Inquiries:**

**ASCNP2019 Secretariat**

c/o A & E Planning Co., Ltd.  
Iwanami Shoten Hitotsubashi  
Bekkan 4F, 2-4-4 Hitotsubashi,  
Chiyoda-ku, Tokyo 101-0003  
Tel: +81-3-3230-2744  
Fax: +81-3-3230-2479  
E-mail: [ascnp2019@aeplan.co.jp](mailto:ascnp2019@aeplan.co.jp)





# **Asian College of Neuropsychopharmacology**

**Secretariat  
c/o Convention Linkage, Inc.  
2 Sanbancho Chiyoda-ku, Tokyo 102-0075, Japan  
Phone : +81-3-3263-8688  
FAX : +81-3-3263-8693  
E-mail : [secretariat@ascnp.org](mailto:secretariat@ascnp.org)  
Website: [www.ascnp.org](http://www.ascnp.org)**

**2017**